

SmartShade Install Guide

This guide will help you install the SmartShade to your window. Before you begin, please make sure that you have enough space on the inside wall of the window to install the bracket:

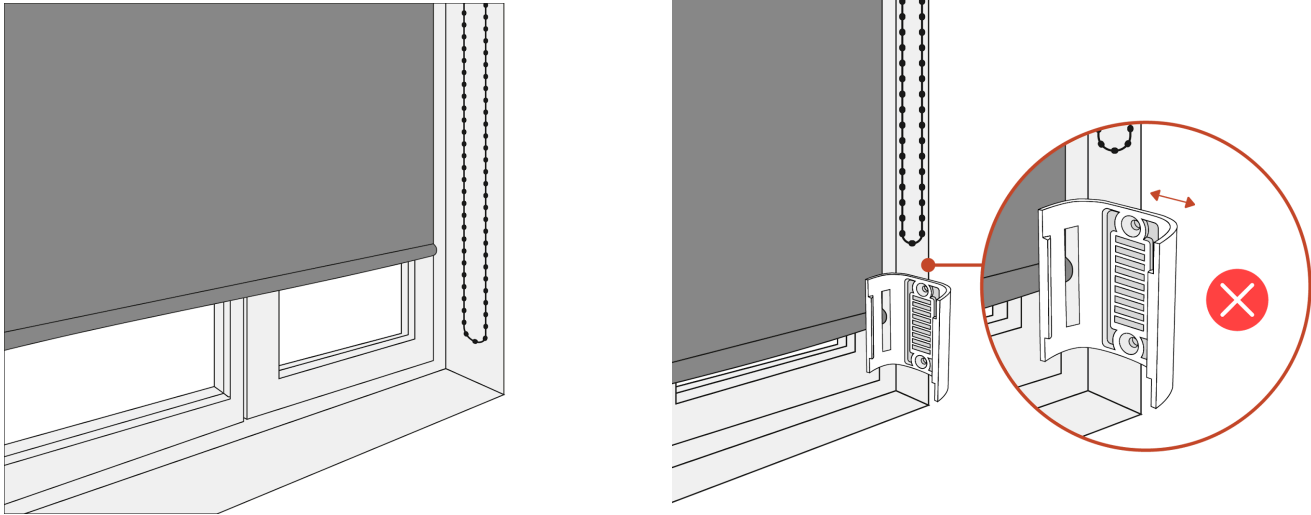

If not, then please consult the RYSE app for detailed installation instructions for your window setup.

1. If your beaded chain has a ball stopper please remove it.



2. If your chain has a bead connector, pull the bead connector off the chain or use pliers to take them off.



Then, re-attach your chain with the provided RYSE bead connector.



Note: Using a non-RYSE bead connector may cause damage to your device.

3. If your beaded chain has a cord tensioner, unscrew your tensioner from the wall and pull out the chain.



If you are struggling, you can cut your chain above and below the ball stopper and re-attach it using one of our provided bead-connectors.

4. Make sure you have the following items before your continue:

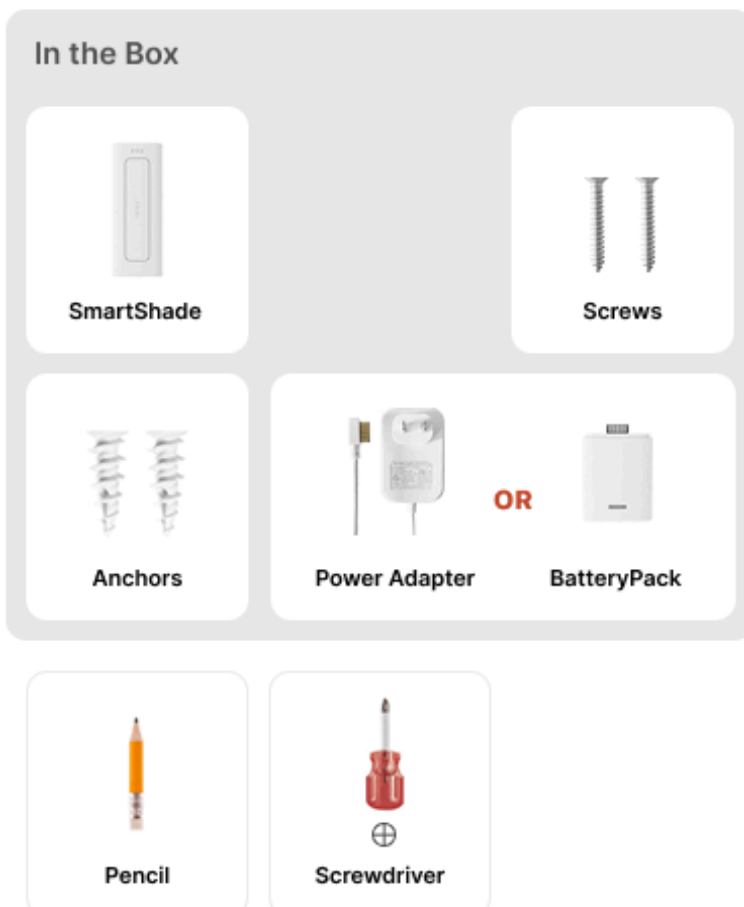

5. Hold the chain against the wall so that it is taut (like a guitar string). Then, mark the wall slightly below the bottom of the chain with a pencil. Make sure you have at least 8 inches of space below the mark.



6. Place the top of the bracket against the mark you made. Make sure that there is enough space between your shade and the bracket so that it is not obstructing the shade's up and down movement. Use a pencil to mark the wall through the bracket's top and bottom holes.



7. Drill the screw into the top hole of the bracket. Use the appropriate anchors for your wall material, if needed. Make sure the bracket is straight before moving on to the next step.



8. Drill the screw into the bottom hole of the bracket. Use the appropriate anchors for your wall material, if needed.



9. Hold the chain against the wall, and ensure that the bottom is just above the bracket. This will confirm that your bracket is perfectly placed.



10. Open the back of the SmartShade device by pressing on either side of the cover and pulling the cover back and out.



11. If you do not have the top guide rail attachment connected, please align the screw holes in the guide rail with the two holes above the sprocket wheel. Use the provided guide rail screws to secure the rail into place.

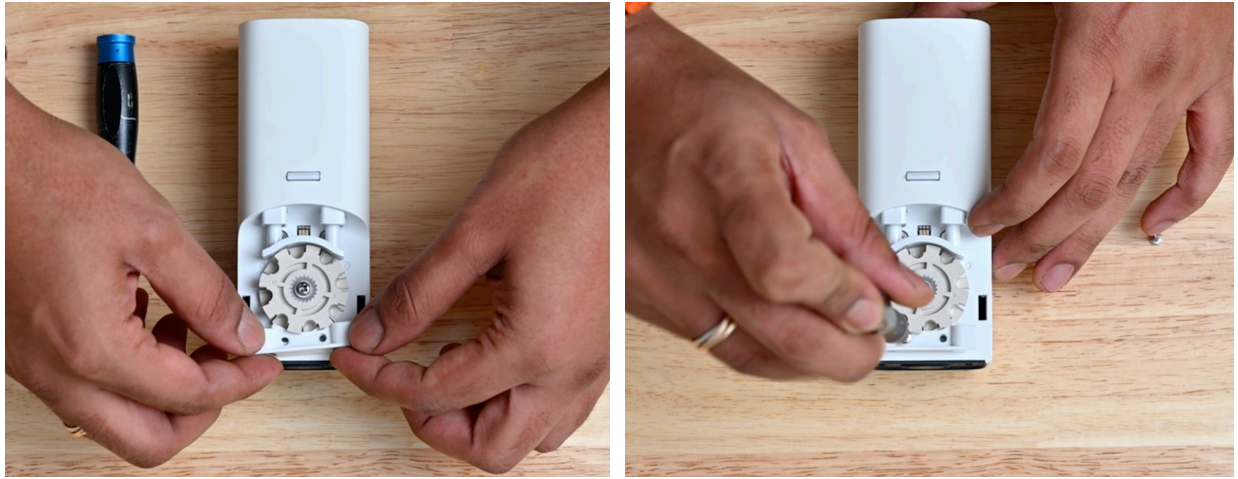

12. Push gently on the bottom guide rail and slide the chain under. The chain should be wrapped securely around the sprocket wheel.



Note: If your chain is not taut, slide the SmartShade down on the bracket to adjust the tension.

13. If you're using a BatteryPack, connect the power adapter to the bottom of the SmartShade device and plug it in.



14. If you're using a BatteryPack, Connect the BatteryPack to the bottom of the SmartShade device.



Congratulations! You have successfully installed the SmartShade device! Your setup should look similar to the image below.

