



LifeHub/AiMOR Calendar



Product Name: LifeHub16
Model #: ALH200

Richwoods Technology Inc.
www.azpenpc.com

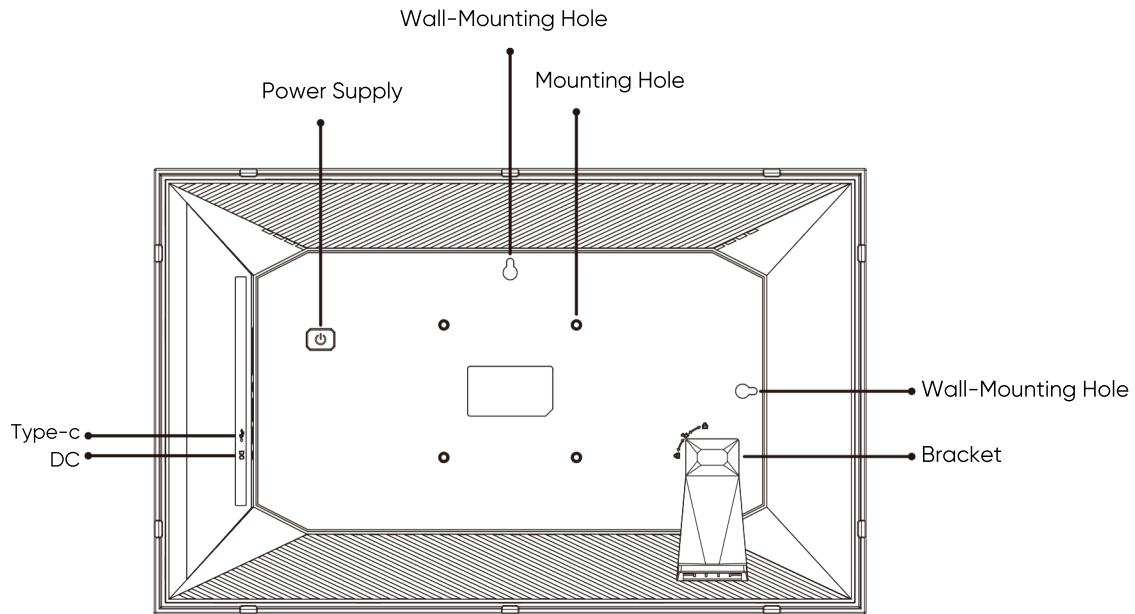

Power Button

Hold the power button for about 5 seconds to power on the frame. when the frame is on, press the power button once to turn the screen on or off.

Hold the power button for about 2 seconds to get power on. To avoid any possible damage to the frame, please do not unplug the power adapter from the frame while the device is on.



Product Specification	
Screen	15.6" Touchscreen (16:9)
Resolution	1920x1080 FHD
WI-FI	2.4GHz
CPU	A523Cortex™M-A7 Quad-Core
Memory	4GB DDR3
Storage*	64G

Before Device Installation

Wall-Mounting Tips Take the height of all device users into consideration. It is recommended to install the device at an eye-level height.

Ensure client space for both horizontal and vertical mounting orientations.

Do not drill holes above wall studs, electrical wires, or pipes.

Before installation, unplug the device from the power socket and keep it away from water sources.

Required tools



Electric Drill



Hammer



Wall Protection Tape



Other accessories inside the packaging box



Power Adapter

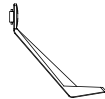

Bracket



Two Screws



Two Expansion Anchors

The included screws and expansion anchors are suitable for drywall, brick, concrete, or tile walls.

Download AiMOR app on your mobile phone

To share your schedule with compatible calendar devices worldwide, please first download the free AiMOR app on your mobile device.

Search for "AiMOR" in the App Store (iOS) or Google Play (Android) to download the AiMOR app.

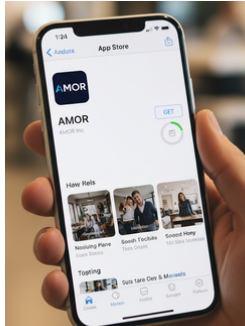

Bind and Connect Devices

To synchronize your schedule with AiMOR Calendar, you need to connect the AiMOR app to the AiMOR Calendar device. Follow the steps below for connection:



Download the "AiMOR APP" through your mobile phone



Open the device's member management settings

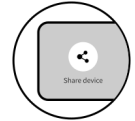

Open device sharing

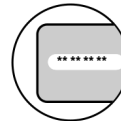

View the device sharing code



Enter the device code in the "AiMOR APP" to bind the device



You can now synchronize your mobile phone with the calendar

Click on the device sharing icon"  "on the AiMOR Calendar A pop-up will appear with a unique code, which is valid for 12 hours.

Now, open the AiMOR app on your phone, tap the "+" icon under the device tab, enter the code from the AiMOR Calendar, and click. Your mobile app is now connected to the photo frame.

Share the AiMOR Calendar code with friends and family. They can add the AiMOR Calendar and start synchronizing or creating schedules, household chores, etc., to it. There is no limit to the number of mobile users connected to the AiMOR Calendar.

Introduction to Functions on Device Homepage:

Main Functions on Homepage

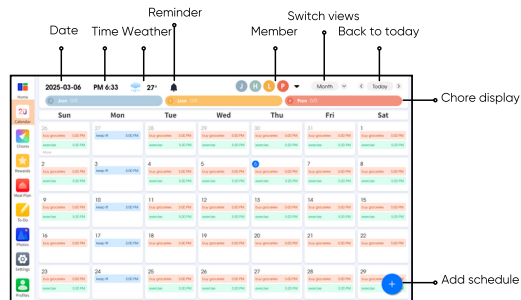

Upload photos

Transmission from mobile to device



Notification

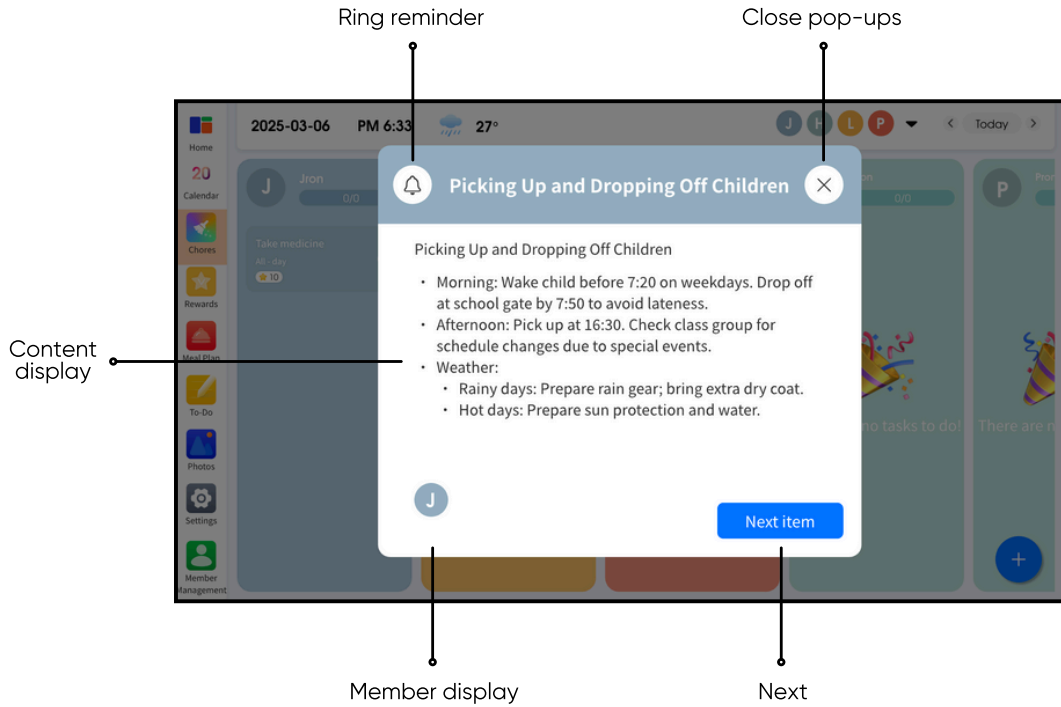

Message notification

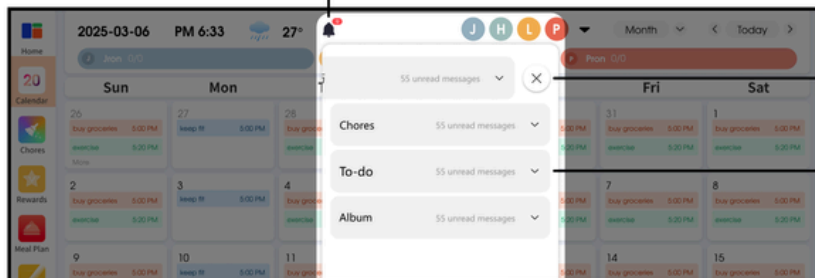

Swipe right to delete

Reminder information category

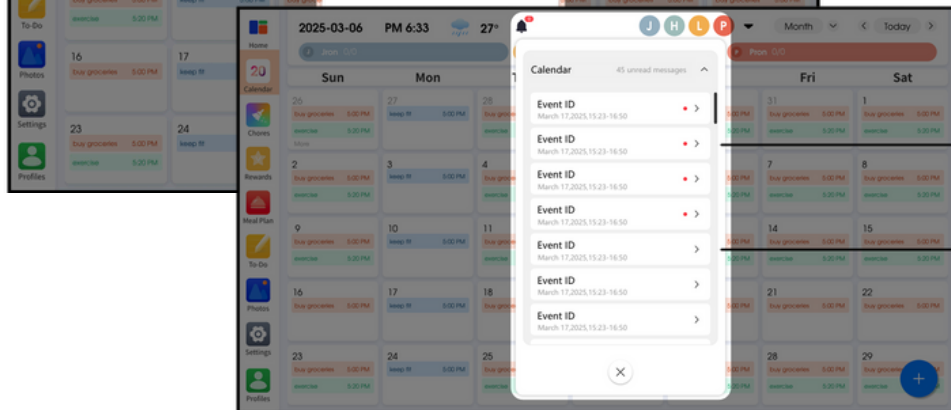

Unread status

Read status

Weather - Set Time Zone

Navigate to Device Settings - General - Weather Location to ensure that the weather positioning is accurate

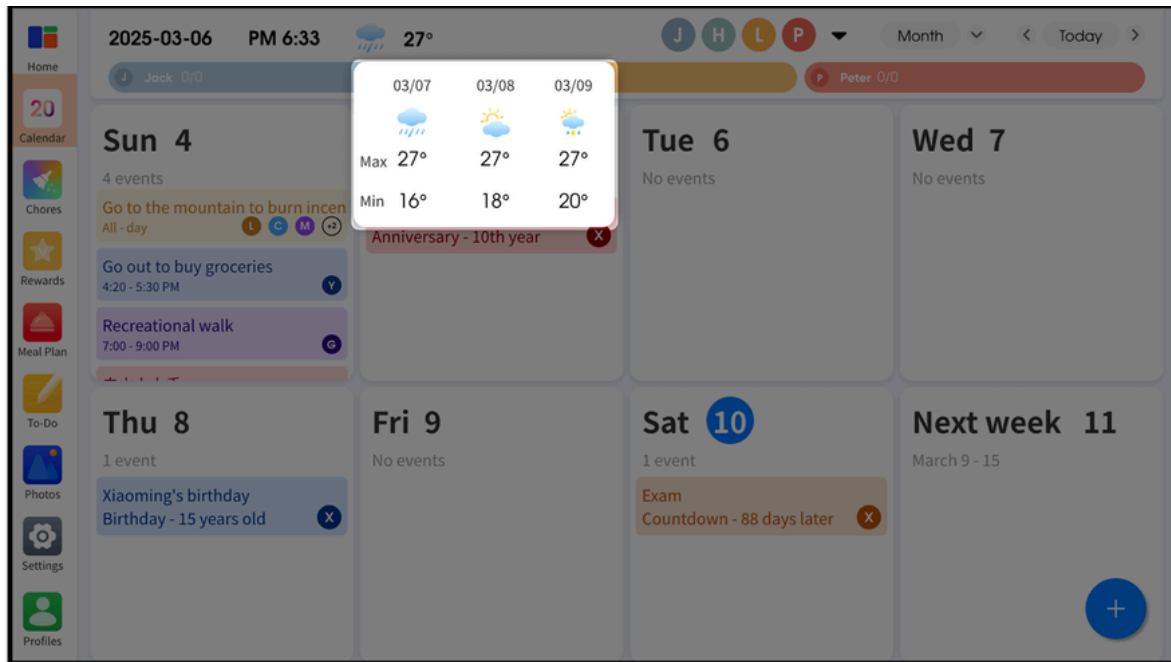

Introduction to Main Functional Pages on Mobile App:

Smart Creation, Star Assignment, Reward Creation, Catering Plans: Smart Recipe Creation, Synchronized Import, Member Management, Photo Upload
Synchronized Import:

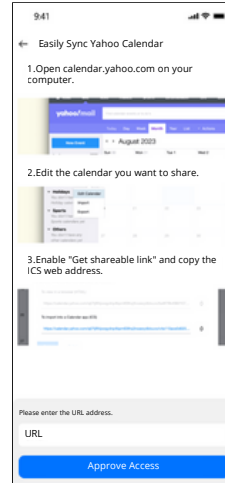
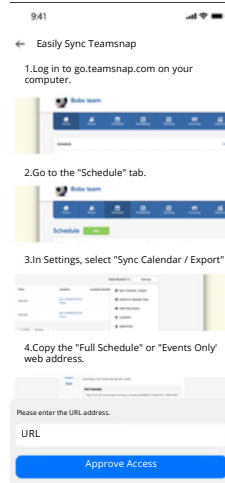
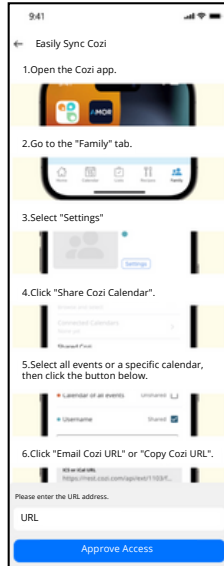
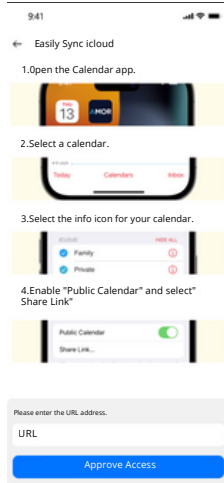
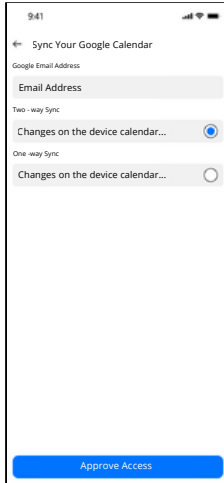





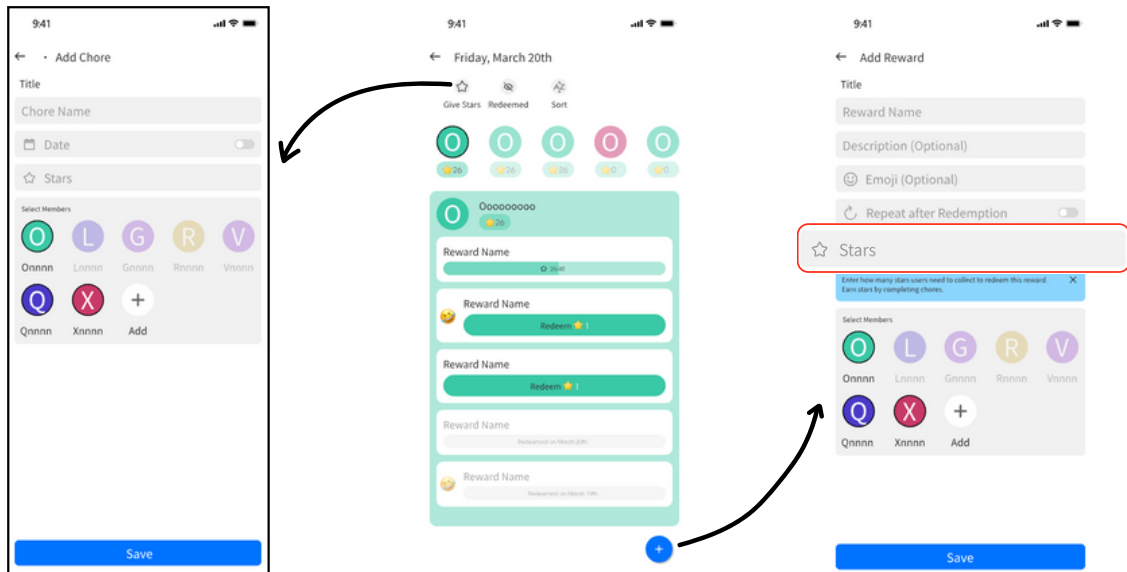

Star Assignment:

Create rewards and set rules together.

When you have collected enough stars, you can redeem our pre-agreed rewards with them! Rewards can be items or a special experience. Rewards are created by parents on the mobile app, and children can view their rewards and progress on the device.



Wi-Fi

Icon  to view the WiFi status,  means that the WiFi signal is strong,  means no WiFi, and icon  to view the server status,  means connecting to the server,  means disconnecting the server.

Factory Reset

Deletes all data from your frame. This will permanently delete all your photos/videos, contacts, and settings.



Limited Warranty

What the warranty covers:

Azpen offers a limited manufacturer warranty from defects in material and workmanship through normal use during the warranty period. If the product proves to be defective in material or workmanship during the warranty period, Azpen will at its sole option, repair or replace the product with a new or similar product. Replacement product may include remanufactured, refurbished, rebuilt parts or components. The replacement will be covered by the balance of the customer's original limited warranty. Warranty service can only be performed by Azpen's authorized service center. Shipping costs of the product to the service center and liability are the responsibility of the purchaser. In the case of fraud or misrepresentation, Azpen reserves the right to deny all warranty coverage or claims.

How long the warranty is effective:

Azpen products are warranted for one (1) year (365 days) for parts and labor beginning on the original date of purchase. Reconditioned, refurbished or remanufactured products are warranted for ninety (90) days for parts and labor. Out-of-warranty service fees may apply.

Who the warranty protects:

This warranty shall not extend to anyone other than the original purchaser of this product, and is non-transferable. The original dated bill-of-sale or receipt must be provided as proof of purchase.

Warranty does not cover damage, deterioration or malfunction resulting from:

Damage which occurs in shipment, delivery and installation. Applications and uses for which this product was not intended. Altered product, cracked screen, cosmetic damage or exterior finish. Accidents, abuse, normal wear and tear, neglect, fire, water, lightning or other acts of nature.

Incorrect electrical line voltage, fluctuations and surges. Customer adjustments and failure to follow operating instructions.

Use of products, equipment, services, parts, supplies, accessories, modifications, installations, repairs, external wiring or connectors not supplied or authorized by Azpen.

Limitation of liability:

In no event, under any cause of action or theory of liability, shall Azpen, its affiliates, distributors or suppliers be liable for any indirect, incidental, consequential or punitive damages of any nature whatsoever, arising out of the use of or inability to use any Azpen product(s), including without limitation, property damage or loss of value of product(s) that are used in or with Azpen product(s).

You agree and understand Azpen has no liability for any damage, loss of data or destruction to consumer electronics devices or other personal property including, without limitation, cellular phones, tablets, laptops, or other handheld devices. Regardless of the legal theory on which a claim is based, the maximum recovery of any kind against Azpen will not be greater than the purchase price of the product. There are no express warranties other than those listed and described above.



For more information or to
register online, visit us at:

www.azpenpc.com

For customer service, please contact:

972-378-5559

support@azpenpc.com

Monday-Friday

9:00 am-5:00 pm (CST)

**MADE IN CHINA
DESIGNED IN USA**

SCAN QR CODE
FOR MORE
OFFICIAL
INFORMATION

