

140mm

110mm

MPIF 5-in-1:EMS | RF | LED Body Contouring & Slimming Device



User Manual ►
www.shoplaleur.com

MPIF 5-in-1:EMS | RF | LED Body Contouring & Slimming Device

User Manual ►

Product structure ►

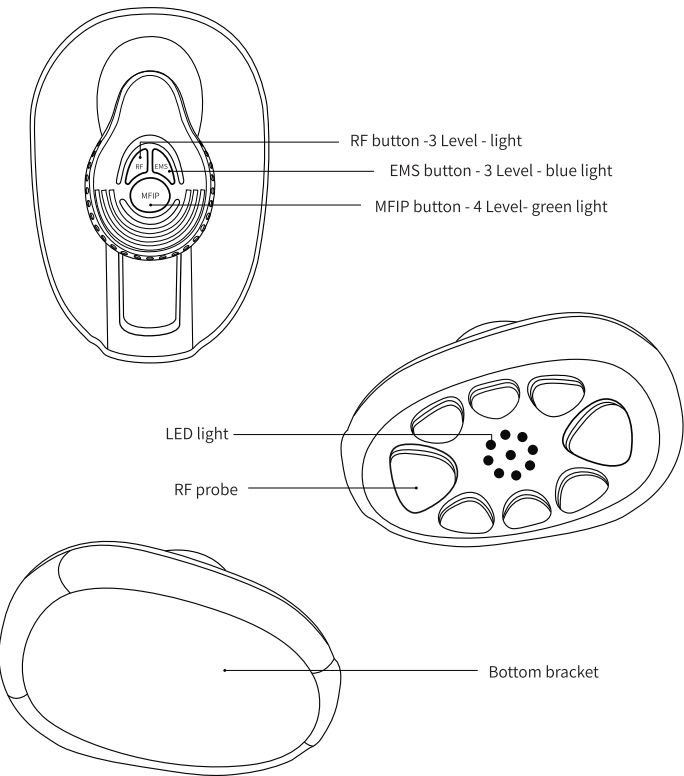

01

Functional characteristics ►

MFIP Mid Frequency Interval Pulse

Mid-Frequency Interval Pulse (MFIP) is meant for toning and lifting your skin. It combines three powerful technologies: electrical muscle stimulation, interval pulse, and radio-frequency in a specifically designed intermittence pulsation. This specific technique stimulates on both a muscular and cellular level which helps to provide results such as inch loss, cellulite reduction, skin tightening.

EMS Electrical Muscle Stimulation

This device uses EMS technology which activates muscle groups externally through the skin layers. As the electrode sensors deliver impulses that make the muscles contract, EMS works by mimicking the natural way the body exercises its muscles. EMS can help to promote weight loss by building muscle, which in turn helps to boost metabolism and burn fat.

RF Radio-Frequency

Radio Frequency therapy stimulates the production of new collagen and improves the skin surface and texture. This technology uses heat and RF energy to help shape your body and getting rid of undesirable fat cells. In addition, this treatment also promotes blood flow to the treated area, which helps break down fat and cellulite. This also helps in tightening the skin in the target areas, making their appearance smooth and toned.their appearance smooth and toned.

02

Product specifications ►

Name	MPIF 5-in-1 Body Contouring & Slimming Device.	Timing	15min/time
Voltage	12V	Net Weight	430g
Power	≤36W	LED wavelength	630±10nm
Product Size	144*97*112mm	Gear	MFIP: 4 level EMS: 3 level RF: 3 level

Care model ►

Before Use

- Before using this machine, be sure to take off metal (watches, jewelry) accessories, glasses or contact lenses.
- Confirm whether there are scars, or inflammatory parts on the skin, and avoid this area during care.
- Dry the care area with a DAMP towel to keep the skin clean.

How to Start

Insert the AC adapter plug into the electrical socket, insert the DC socket into the corresponding position of the instrument, select the appropriate mode and level to start the instrument.

03

Use points

- Please use device when the treatment area is moist.
- Fit the guide head (silver part) of the instrument completely to the skin and move it slowly to avoid remaining in the same spot for too long.
- It is recommended that the basic frequency of care is applied to the same area 2 to 3 times a week.
- Keep the use frequency at intervals of 2 to 3 days.

Care method

- RF mode + MFIP mode = 10 minutes
- EMS mode + MFIP mode = 10 minutes
(The above two modes work together on the body part for a total of 20 minutes)
- When only one mode is selected among RF mode, MFIP mode and EMS mode, the treatment time is 10 minutes.
- Excessive care will burden the skin. Please take care to avoid long-term care in the same place.
- During care, please slide the guide head to fit the skin slowly.
- During use, if the surface of the probe is dirty and feels rough and not smooth, please use a soft cloth or facial tissue to clean the surface of the probe.

Note!

- This instrument is not waterproof, please do not use it in the bathroom and other places with heavy humidity, and it is strictly forbidden to wash it.
- When cleaning, please use a damp, but fully water-controlled soft cloth to wipe the guide head gently.
- Users who have undergone plastic surgery, please consult a physician before using it.

04

Step of care ►

Upper arm

Care time: 20 minutes per side

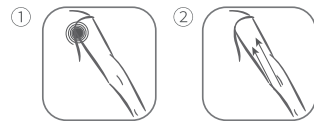

- Make a circle at the junction of the arm and shoulder for 2~3 circles.
- In a straight line, slide from the elbow joint through the upper arm to the shoulder junction.

Abdomen

Care time: 20 minutes per side

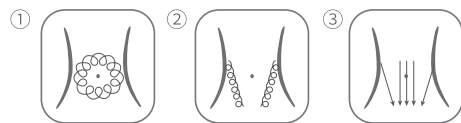

- Next to the belly button, slide 1 circle in a drawing method.
- Slide from the side of the waist to the groin lymph in a circular motion like a sculptured waist curve.
- Move in straight motions sliding from top to bottom.

05

Buttocks

Care time: 20 minutes per side



- In a circular motion, slide upward from the junction of the arm line and the thigh to below the waist.
- Glide like a zigzag at the junction of the arm line and the thigh.
- From the junction of the arm line and the thigh, lift and slide in a straight line to below the waist.

Thigh

Care time: 20 minutes per side

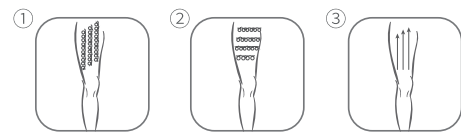

- From above the knee (back of the knee), slide from bottom to top in a circular motion to the thigh junction.
- From the top of the knee (the back of the knee), slide laterally in a circular motion, and nurse in segments from bottom to top.
- From the top of the knee (back of the knee), in a straight line, sliding care from bottom to top.

Note: The same actions are used for care before and after.

06

Calf leg

Care time: 20 minutes per side

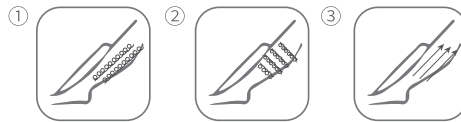

- Slide from the vicinity of the ankle to the back of the knee in a circular motion from bottom to top to the thigh junction (hip line).
- Slide horizontally in a circular motion from the ankle to the back of the knee, and nurse in sequence from bottom to top.
- Slide care from the ankle to the back of the knee in a straight line from bottom to top.

Note: The same actions are used for care before and after.

Tips

- RF mode + MFIP mode treatment for 10 minutes; EMS mode + MFIP mode treatment for 10 minutes, a total of 20 minutes of basic care.
- Please use only on clean, washed skin.
- Slimming cream, essential oils, skin care products, etc. can be applied to the care area.

07

Machine maintenance ►

- Before cleaning the instrument body, please unplug the adapter from the body and socket.
- Do not install metal parts on the AC adapter or plug or make it adhere to dust to avoid fire, electric shock or electrical failure.
- Do not drop or hit the instrument hard.
- Please use a soft cloth dampened with water and wrung out to wipe. If you use a rough cloth to wipe, the instrument may be scratched or the function will be weakened.
- Do not use alkaline solvents, banana oil, volatile oil or other solvents or delustering water, polishing powder, hot water, or chemicals to clean the machine.
- Do not leave the instrument in the state of being dipped in special water.

08

Cautions ►

- Please read this instruction carefully before use and to use this product correctly.
- Do not clean with water. Please turn off the power before cleaning. Wipe with clean cloth or dip in a little alcohol.
- Do not fall or strike strongly on this product, do not disassemble or modify without authorization, we do not provide free warranty service due to malfunction caused by human factors.
- Do not approach the strong magnetic field, do not leave in direct sunlight, do not contact with corrosive liquid, let the machine work properly and without any damage.
- Do not put this product next to high-temperature or high-power appliances to avoid fire, electric shock and other accidents.
- This product should not stay in the same position during the use of the massage head, need to continue to move the position.
- For the first time (first use or unused for a long time), be sure to charge, the charge indicator light from flashing to normal after the electricity is full, can be used normally.
- Please do not allow people who use medical devices such as restricted limb activities, pacemakers, and heart bypasses to use this product.
- Please keep this product out of reach of children.

Warning ! !

- Please stop use immediately when abnormal fever, lest cause skin damage or fire.
- Please do not drop or impact the instrument to avoid causing issue.
- Please do not use the power cord when it was broken, in order to avoid short-circuit and fire.
- Please do not use the following groups:
Infectious patients, heart disease patients, high fever patients, malignant tumors, acute patients, Medical appliance, skin disease patient, pregnant/ if you are breastfeeding, excessive sunburn, sensitive muscles, vasodilator, Being hospitalized.

09

Warranty card ►

- Warranty is valid for manufacturing defects only.
- One year warranty valid from the date of purchase.
- Shipping and handling fees for any and all exchanges are to be covered by customer.
- Damage caused by negligence, misuse, force majeure, or any other instance that is not a manufacturing defect, is not covered under warranty.

Client's name		Contact Telephone	
Client's address		Product model	
Purchase date			
Fix records	Date	Causes and handling of faults	

Implementation of standards:GB 4706.1-2005
GB 4706.1-2008

