

OutIn

USER GUIDE



QUICK START GUIDE

Nano
Basket **PLUS**

SAFETY PRECAUTIONS:

1. Read and follow the instructions before using the accessory.
2. Ensure the machine is placed on a stable surface and away from children or pets.
3. Use caution when handling hot components or liquids.
4. In case you are injured by the hot water, please contact a doctor immediately for help.

*This product needs to be used with OutIn Nano Portable Electric Espresso Machine.



TAMPER

A coffee tamper is a tool used to evenly compress ground coffee in the portafilter to create a consistent and well-packed puck for espresso extraction.



DOSER

The doser is placed on top of the portafilter to distribute the coffee evenly.



SHOWER SCREEN

This is placed on top of the basket to ensure a smooth extraction.



BASKET

The basket fits into the portafilter and holds the espresso coffee powder.

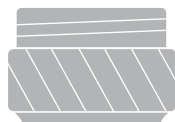

PORTAFILTER

This is the main component used to hold and extract espresso coffee.



DISTRIBUTION TOOL

This tool helps break up any clumps in the coffee powder and ensures even distribution.

TROUBLE SHOOT

Problem	Possible Cause	Recommended Solution
Espresso does not come out	Coffee ground too finely.	Use slightly coarser grind.
	Too much ground coffee in the basket.	Lower dose of coffee. It is recommended to use no more than 18g of coffee.
	Coffee tamped too hard.	You have to place the doser on top of the portafilter to calibrate the tamper for optimal pressure.
Very thin crema	Coffee beans or pre-ground coffee are not fresh.	Use freshly roasted coffee beans or pre-ground coffee.
	Coffee is ground too coarsely.	Use slightly finer grind.
	Too little ground coffee in the filter basket.	Increase the dose of coffee. It is recommended to use more than 16g of coffee.

HOW TO USE Nano Basket Plus

with our Nano Portable Electric Espresso Machine

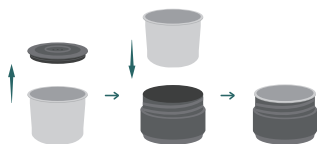

STEP 1: Assembly

- Remove the shower screen from the basket.
- Insert the basket into the portafilter.



STEP 2: Placing the Doser

- Place the doser on top of the portafilter, ensuring a secure fit.



STEP 3: Adding Ground Coffee

- Measure and add 16-18g of espresso coffee powder into the basket.



STEP 4: Distributing

- Use the distribution tool to break up any clumps.

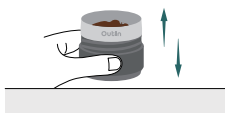

STEP 5: Gently Tapping

- Tap the set gently to distribute the coffee grounds evenly in the basket.

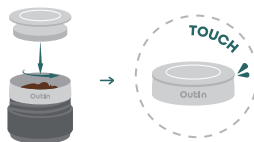

STEP 6: Tamping

- Press the tamper firmly to touch the doser. Twist it back and forth for an even surface.
- ⚠️ Make sure the tamper touches the doser.

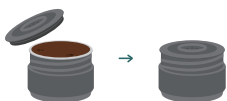

STEP 7: Preparing for Extraction

- Place the shower screen on top of the basket, make sure it sits securely.



STEP 8: Machine Setup

- Screw the portafilter tightly onto the machine's body, make sure a snug fit.
- ⚠️ Please screw **TIGHTLY**



FINAL STEP: Making Espresso

- Get going with the OutIn Nano Portable Electric Espresso Machine following OutIn's guidelines.
 - Pour more than 60ml of water.
 - Enjoy a cup of espresso with incredible crema :)
- ⚠️ Caution: The metal basket gets hot after brewing. Wait for it to cool before handling.

**Happy Brewing and
Enjoy Your Perfect Cup of Espresso :)**

Outin Inc.

1312 17th St.#874,
Denver, CO 80202, United States.

Customer Service:
Support@outin.com

