

# YOU GET STARTED

create one unique candle.

that you can reuse your candle pot again and again.

smooth, clean, flat and dry work surface.



Video Tutorial

## 600g Candle Wax

Melt this wax in the microwave or on the stove before pouring into your candle pot.

4 POTS 400 WATTS

## Fire Safe Varnish

Apply two coats inside and out to varnish and fire proof your pot.

## Match Sticks

to light up your candle.

Paint Brush & Mixing Stick

your candle pot and for your melted wax.

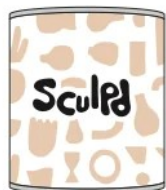

## 600g Premium Air Dry Clay

To craft your dream handmade candle pot from scratch.

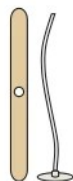

## Eco Wick and Wick Centering Stick

To position your wick through the centre of your candle while the wax sets.



## Fragrance Oil

Pour into your melted wax to give your candle its soothing fragrance.

## PINCH POT INSPO



Straight Sided



Nodule Footed



Bowl Footed



Rounded

## 1 PINCH YOUR POT



1

Form all of your clay into a smooth ball that fits nicely in the palm of your hand. Try to make it as smooth and round as possible.



4

Change the position of your hands so that your fingers are inside and your thumb is outside. Pinch the sides upward and outward.



7

Ensure that your pot has a flat bottom then leave it to dry for 48+ hours or until it's completely hard and much lighter in colour.

## TOP TIP

If you make a mistake or don't like how your pot is looking, don't worry, you can always roll your clay back into a ball and start again!



2

Slowly press your thumb into the centre of the clay until it's just over halfway through.



5

When you're happy with the shape of your pinch pot, start working on thinning out and shaping the rim with your finger and thumb. Your pot should measure approximately 7x7 cm.

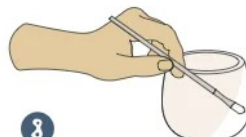

8

Now for finishing touches! Painting is optional, but if you are using acrylic paints, wait for the paint to dry before varnishing. Shake or stir the varnish before using. Paint the pot with a layer of varnish, then wait 1-2 hours for the varnish to cure before applying a second coat.



3

Use your fingers and bend your thumb to pinch out the shape of the bottom of your pot. Turn the clay as you pinch in a smooth rotating motion.



6

If you want to straighten the sides of your pot, gently roll it along your work surface.



9

Leave the varnish to cure overnight before moving onto step 2 - pouring your candle.

## 2 POUR YOUR CANDLE



4 MINS 400 WATTS

10

Melt the wax in the microwave or on the stove using the bain marie method. **Keep watch over your wax bag while it's melting.** In the microwave place in upright position - heat this on a medium heat (400 watts) for 4 mins or until melted. **Make sure to check on the wax once every minute.**

12

Take your eco wick and place it in the centre of your vessel, approx 3cm away from the sides so that the flame will not touch your creation. Use your wick centring tool to centre your wick and to keep it in place.

14

Once your candle wax has cooled and hardened, trim the wick to be 1-2cm long.

11

Allow to... minutes... fragran... leave fo...

13

Slowly pour the w... when doing this to... centred. Pour to O... the wax isn't touc... the tool in place u... the wick in place.

15

Leave for... for the wa... before bu...

## A COUPLE OF TIPS

- 1 This amount of wax will give you around 20 hours of burning time! Be care
- 2 As soy is a natural wax, when your candle dries you may see some incons... or crystallisation - this is nothing to worry about and will disappear during
- 3 Sometimes after your initial pour, your candle will need more wax due to... around 10 mins later and pour in more wax if necessary