The background of the entire page is filled with various abstract, hand-drawn shapes in three colors: dark blue, light blue, red, and tan. These shapes represent different pottery forms, such as bowls, vases, and cups, scattered across the white background. The central text is overlaid on this pattern.

Sculpa

Pottery Guide

BEFORE YOU GET STARTED

Use a smooth, clean and flat work surface, e.g. a wooden chopping board. Keep a bowl of cold water nearby for slipping.

THE LINGO

To **'Score'** is to scratch small grooves into each join surface to improve bonding.

To **'Slip'** is to apply a small amount of water to each join surface to act as glue.

Coil: clay which has been hand rolled into a long sausage shape.

Slab: clay which has been rolled out flat, usually with a rolling pin.



YOUR KIT EXPLAINED



Knife Tools

For cutting and slicing through rolled out or coiled clay. Also useful for blending and smoothing surfaces.



Needle Tool

For creating holes and openings and scoring each clay surface before joining.



Blending Tool

For blending clay between join surfaces. E.g. attaching a handle to a jug.



Ribbon Tool

For trimming and squaring the rim of pots and for hollowing out internal cavities. Great to use on leather-hard pots.

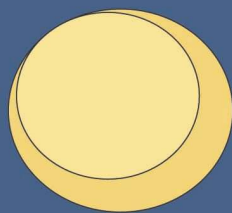

Sponge

Use a damp sponge to smooth over cracks and creases before leaving to dry.



White Paint

Apply two coats on top of bone dry clay (2 - 3 days of drying). First coat dries in 30 minutes.



Varnish

Protects your creation from moisture. Apply on top of dry white or coloured paint and leave to seal completely for 24hrs.

Paintbrushes

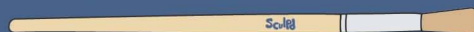

Coverage Brush - Size 10

For covering large areas with paint and varnish.

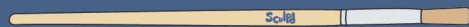

Detail Brush - Size 6

For the artist in you - ideal for painting details.



Air Dry Clay

Unlike regular clays, air dry clay doesn't need to be fired in a kiln to make it strong and hard! Our clay has added fibres which give it strength when dry without disrupting the feel or texture when wet.

Allow your creations to dry for 2-3 days until very light grey in colour and bone dry to the touch.

! Take precautions to avoid creating and inhaling excessive clay dust. Please do not eat or drink from your clay creations. Air dry clay is porous and may absorb water even after drying. The paint and varnish will provide good protection, however outdoor use is not advised.

PINCH POT

The classic pinch pot technique has been used since the dawn of pottery and is a versatile way of creating all sorts of pot shapes. Master the pinch pot and you'll be a pottery pro in no time.



Video Tutorials



1 Form a small amount of clay into a smooth ball that fits nicely in the palm of your hand. Try to make it as smooth and round as possible.

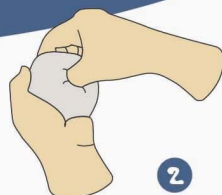

2 Slowly press your thumb into the centre of the clay until it's just over halfway through.

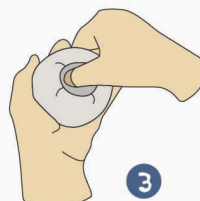

3 Use your fingers and bend your thumb to pinch out the shape of the bottom of your pot. Turn the clay as you pinch in a smooth rotating motion.



4 Change the position of your hands so that your fingers are inside and your thumb is outside. Pinch the sides upward and outward.



5 When you're happy with the shape of your pinch pot, start working on thinning out and shaping the rim with your finger and thumb.

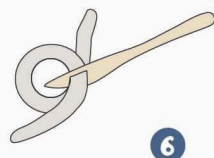

6 Roll out a long strip of clay with your palms. Coil it into a ring then cut through the overlap diagonally with the knife tool. Now score and slip the cut ends and blend them together.

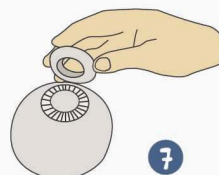

7 Score the base of your pot and the underside of the ring. Slip the base of your pot then join the two pieces together. Blend together the ring edge with your pot using the wooden knife tool to secure it completely.



8 Almost done! Now dampen the sponge and smooth over all the edges, cracks and creases to give your pot a silky smooth finish. Let it dry for 2-3 days until it's a lovely light grey colour.



9 When your pinch pot is bone dry it's time to paint! First, apply the white base coat. Once dry you can decorate your pot with coloured acrylic paints, followed by the varnish. Leave to seal for 24hrs. Pinch pots make lovely homes for mini cacti!

PINCH POT INSPO



Doughnut Foot



Coiled Foot Ring



Nodule Feet



Pod Feet



Tall Foot



Pinched Bowl Foot

Sculpd

© 2020 - 2021 Sculpd Ltd

For advanced pottery projects and to level up, visit www.sculpd.com/levelup

1



FACE PINCH POT

Difficulty: 🍴🍴

Make a shallow pinch pot with a flat base. Shape some clay into a nose and ears. Slip and score the joining surface of both pot and features before attaching and blending. To create the foot - make a smaller, sturdier pinch pot and flip it upside down, then attach the face on top.

PINCH POT JUG

Difficulty: 🍴🍴🍴

Create a taller pinch pot by rolling the pot back and forth along your work surface at a slight angle every few pinches. For the handle - roll out a coil of clay, smooth it into a strip and trim the ends. Now slip, score and blend the handle onto your pot. Pinch the rim to create the spout.

2



3



COILED FOOT PINCH POT

Difficulty: 🍴

Make a classic pinch pot, but add a stylish foot ring base by rolling out a coil of clay, bending it into a ring shape, then slip, score and blend it onto the base of your pinch pot.

GI RAFFE POT

Difficulty: 🍴🍴🍴

Start with your regular ol' pinch pot. Roll out four equal length coils for the legs, then trim the ends and slip, score and blend them onto the base of your pot. To create the neck - roll out another coil of clay but leave it thicker at one end and pinch the tip into a face and nose shape. When you're happy with the shape, slip and score and blend the neck onto your pot. Leave your giraffe propped up as it dries.

4



COIL POT

Coiling is handbuilding technique that has been used to create pots and vases for many thousands of years by stacking coils of various sizes to build the shape of a vessel. The walls can then be blended together or left with a ribbed effect.

You will need:

- 1 Rolling pin or similar
- 2 Small bowl to cut around



Video Tutorials



Form a small amount of clay into a smooth ball that fits nicely in the palm of your hand.

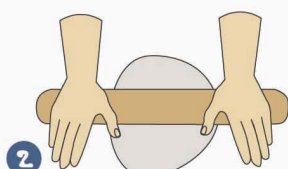

Pat down your lump of clay then roll it into a thick slab. If you don't have a rolling pin, try using a wine bottle!



Place a round object, like a bowl, on your slab and cut around it with one of your knife tools. Peel off the excess clay and reseal it in your Sculpd bag.



Smooth out the edge of your clay disc with your finger so that it has a rounded edge. Flip it over and repeat. This will be the base of your vase!



To make your coils, roll out a lump of clay using your fingers. Make these as thick as you want your coil rings to be.

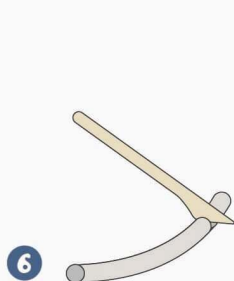

Trim the ends of your clay coil with one of your knife tools.

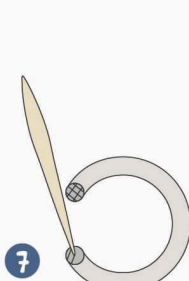

Score and slip either end of your coil of clay using your needle tool.



Press the ends of your clay coil together, giving them a wiggle as you do so. Use your finger or a tool to blend out the join, so that you have one smooth ring of clay.

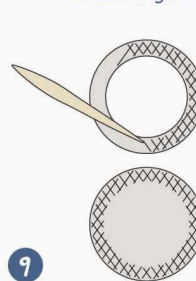

Using your needle tool again, score and slip the edge of your clay disc and one side of your clay coil.

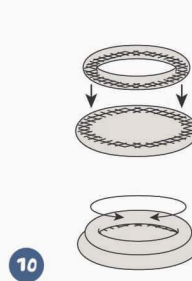

Place your coil on your clay disc, with the scored areas touching. Gently wiggle your coil around on the disc to strengthen the bond.



On the inside of your coil, blend out the join with the opposite end of your fork tool so that it's nice and smooth.

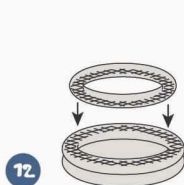

Repeat this process with more coils, remembering to score and slip each surface before you join them together. This will make your joins extra strong.



After adding each coil, use your tool to smooth out the join on the inside of your piece to reinforce it. Vary the size of your coils to create dynamic shapes.

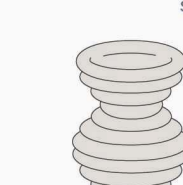

Voila! You're a coil pottery pro. Leave to dry for 2-3 days and your pot will be ready to paint, decorate and varnish.

Sculpd

© 2020 - 2021 Sculpd Ltd

For advanced pottery projects and to level up, visit www.sculpd.com/levelup



COIL VASE

Difficulty: 🍷🍷

Simply roll out your coils in varying sizes and start stacking them up! Slip and score each coil and blend them into a smooth surface on the inside for a really strong vase.

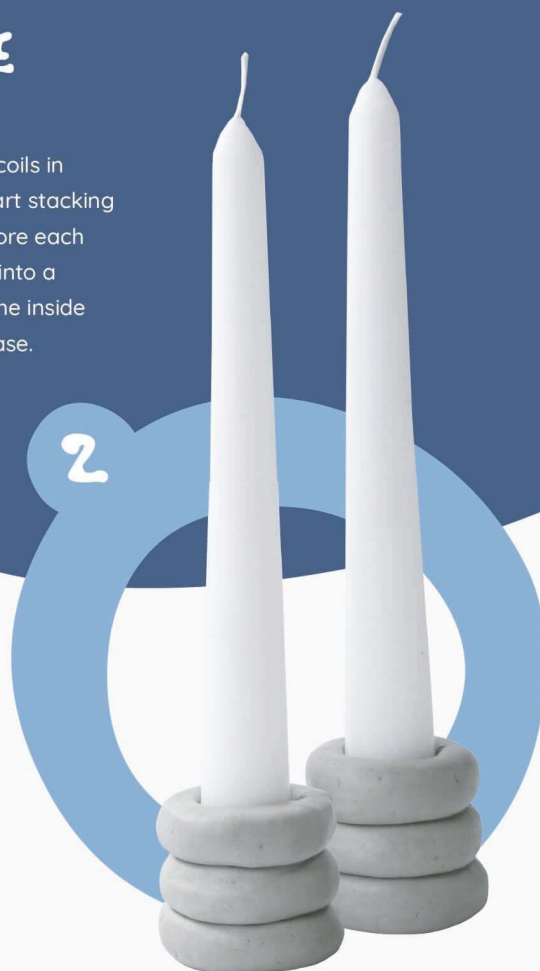

CANDLE STICK HOLDERS

Difficulty: 🍷

Roll out three coils of equal length. Wrap the first around the base of your candlestick with a firm but not tight fit as the clay will shrink a small amount as it dries. Blend the join together and then repeat with the other two coils, scoring, slipping and stacking as you go.



COIL POT

Difficulty: 🍷🍷

Form a lump of clay into a ball, then roll it out to create a disc base. Roll out several coils of clay, then cut each of them to the same length. Blend into rings as shown on the reverse of the card, then slip and score both sides of each ring and stack them up, blending out on the inside of the pot as you go.

TEDDY BEAR POT

Difficulty: 🍷🍷🍷

Build your coil pot as normal, and then blend both the outside and inside with the knife tool until smooth. Roll out a couple of extra coils and slip and score them to attach them as legs, and accessorise with ears, a bow-tie, a nose - whatever you like!



PLANT POT

Another method of creating a pot by rolling out slabs for the base and sides. Great for creating straight sided vessels with square edges.

You will need:

- 1 Rolling pin or similar
- 2 Sheet of baking paper
- 3 Ruler or straight edge
- 4 Small bowl to cut around



Video Tutorial

1



Tear off a handful of clay from the block. For bigger pots with a wider base you can add a bit more clay. Form the clay into a smooth ball.

2

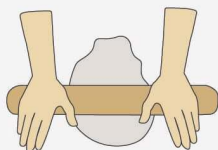

Place the baking paper on top of the ball of clay and roll it out to roughly the thickness of your index finger. Try to get a nice smooth, even finish.

3

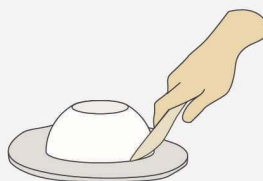

Place a round bowl roughly 10cm diameter on top of the clay and cut around it with the knife tool. This will form the base of your pot.

4

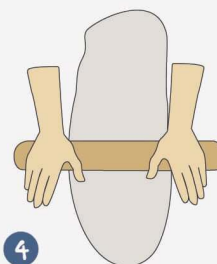

Take the rest of your clay bag and roll it out into a long rectangular shape. The longer the better!

5

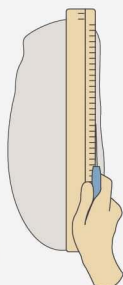

Using a ruler or a straight edge cut along each of the long edges of your clay and square off one of the ends.

6

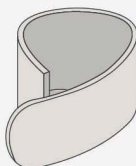

Score and slip the edge of your pot base then carefully lift your clay onto its side and wrap it tightly around your base. Cut off the excess clay where the sides overlap.

7



Score and slip each side of the join then blend together by pinching gently with your finger and thumb. Smooth out any sharp edges on your pot!

8

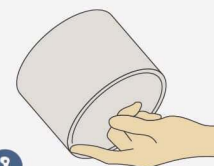

Wait 30+ minutes for the clay to firm up slightly, then carefully lift and blend together the join where your sides meet your base. If it's for a plant you can add a small hole in the base with the pointed needle tool.

9



Dampen the sponge and smooth over all the edges, cracks and creases to give your pot a silky smooth finish. Let it dry for 2 - 3 days until it's a lovely light grey colour.

10



When your plant pot is bone dry it's time to paint! First, apply the white base coat. Once dry you can decorate your pot with coloured acrylic paints, followed by the varnish. Leave to seal for 24hrs.

11



Air dry clay plant pots make lovely homes for all types of house plants, however they are best suited for potted succulents and cacti. It's best to water sparingly or remove the plant to bottom water.

Sculpd

© 2020 - 2021 Sculpd Ltd

For advanced pottery projects and to level up, visit www.sculpd.com/levelup

1



KITTY POT

Difficulty: 🍷

Make a pot using the plant pot method shown but with a little less clay. When you're happy with your pot, shape a couple of triangles for the ears, slip and score them and blend onto the rim of your pot. A cheeky nose and a few whiskers later, you have yourself a kitty-cat pot.

2



FOOTED PLANT POT

Difficulty: 🍷

Create a plant pot that's a little shorter and thicker - make sure the walls are nice and sturdy. Flip the pot upside down, roll out some balls of clay to create the feet, then slip, score and blend them onto your piece. Leave your pot to dry feet up.

3



POT & DISH PAIR

Difficulty: 🍷🍷

Create both pot and dish using the plant pot method. Start with the pot, then place it on a rolled out base to measure the sizing for the wider bottom dish. For that sharp, clean and minimal look, try carving the top of your pot with the ribbon tool when the clay is leather hard (after 6-12 hours).

4



LEGGY PLANT POT

Difficulty: 🍷🍷🍷

Build a basic plant pot of your ideal size. Flip your pot upside down, roll out 3 thick coils of clay of equal length. Flatten the coils with your finger and trim the ends. Slip and score each coil end and the pot base before blending the legs onto your pot. Prop up wobbly legs until they dry out enough to stand on their own. Only flip the pot back over when it's completely dry!

TRINKET DISH

You will need:

- 1 Rolling pin or similar
- 2 Small bowl to cut around



Video Tutorials



Roll a small amount of clay into a ball. Use your finger to smooth over any lumps and creases in the clay.

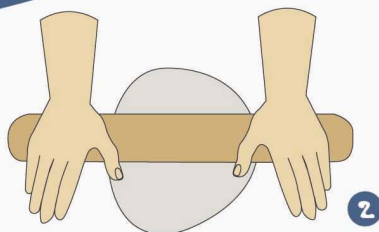

Pat down your ball of clay with the palm of your hand, before rolling it out into slab. Make sure your work surface is nice and dry or the clay can stick to the surface.



Place a round object on your slab of clay and cut around it with one of your knife tools. Gather up the excess clay and save it for your next trinket dish!

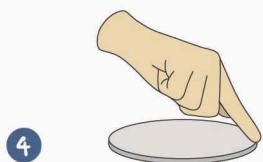

Use your finger to smooth over the surface of your clay and tidy any messy edges. If your clay feels a bit dry, try using a little bit of water on your finger.

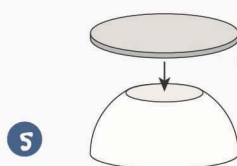

Carefully place your clay disc over a bowl or other domed item if you want it to have a rounded rim. Lay a piece of plastic on the bowl first if you're worried it might stick.



Leave your dish to dry! Don't be tempted to keep pressing it onto your mould as this may cause the clay to crack as it dries, due to slight shrinking. Try lightly wiping it with a damp sponge to smooth it over instead.



You'll be able to tell your dish is dry when it's become lighter in colour - this is called 'bone' dry. Your piece should be bone dry after a couple of days.

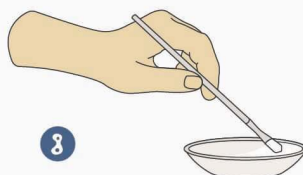

Now paint! Have fun personalising your dish. Paint your piece with the white paint, leave to dry and then apply the varnish. 24hrs later your dish will be ready to rock'n'roll.

Sculpd

© 2020 - 2021 Sculpd Ltd

For advanced pottery projects and to level up, visit www.sculpd.com/levelup



CHEEKY INCENSE DISH

Difficulty: 🕯️

Start by following the instructions on the back of the card to create a plain dish. Roll out a small ball of clay, and blend it out onto your dish, then poke a hole in it with your needle tool or a toothpick for an easy incense holder.

FACE TRINKET DISH

Difficulty: 🕯️

Roll out a slab of clay with a rolling pin, then cut out an oval shape. Roll some extra clay into thin coils, shape them into features, then slip, score and blend out onto your dish. Roll out a long coil of clay, then lightly flatten it with the rolling pin to use as the rim of your dish. Slip, score and blend out the rim and you're done!



RUFFLED TRINKET DISH

Difficulty: 🕯️🕯️🕯️

Once you've made your basic trinket dish shape, start lightly pinching and pulling the edges of your dish to create a wigglier shape. Make sure not to pull the clay too thin and smooth over any cracking with a tiny dab of water. Flip upside down, and attach feet using the slipping and scoring method.

JEWELLERY DISH

Difficulty: 🕯️

As easy as it gets! Roll out a slab of clay, place a round object like a glass on top of it and cut around. Peel away the excess clay and smooth out rough edges with your finger or a sponge. Leave to dry over something domed like a ball or a bowl to give it that slightly upturned edge. For a square edge, trim with the ribbon tool when leather hard.

