

# HOTO Electric Precision Screwdriver ADV

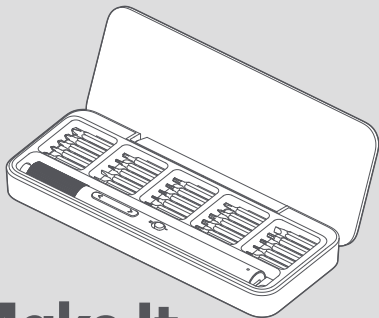

# Make It Happen



Visit our website for more Cool Tools  
( [www.hototools.com](http://www.hototools.com) )

# 01 Product Overview

---

Thank you for purchasing HOTO Electric Precision Screwdriver ADV. Please read this manual carefully before use, and retain it for future reference.

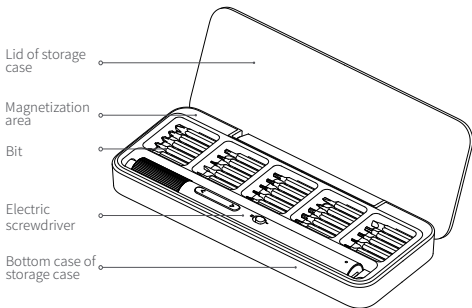

The illustrations of products, accessories, user interface and so on in the instruction manual are schematic diagrams, which are only for reference. Due to the update and upgrade of the product, there may be some slight differences between the actual product and the schematic diagram. Products are subject to change.

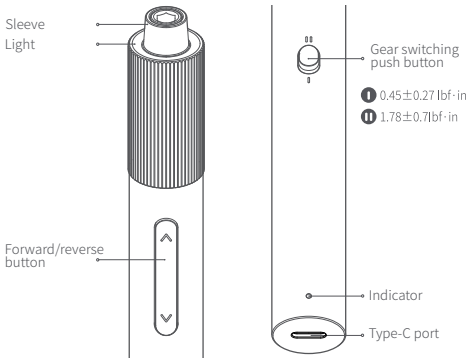

## 02 Instructions

---

### Usage of the storage case

#### Flip cover opening/closing

- Lift the lid of the storage case to the natural opening state, and the maximum opening angle is 115°. Please do not force it open.
- Put down the lid of the storage case to 0° until the storage case is closed.

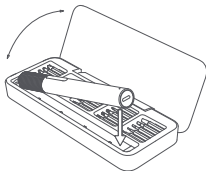

#### Electric screwdriver storage

- Insert the screwdriver sleeve into the round hole as shown in the picture, and then press down on the rear of the screwdriver to store it.

#### Screwdriver bit storage

- The screwdriver bit is stored in the bottom shell by magnetic attraction.
- After the use of screwdriver bit, place the screwdriver bit into the slot, then the screwdriver bit can be attracted by itself.

#### The usage method of the electric screwdriver

Take out the screwdriver bit from the storage case, and insert it into the sleeve.

## Magnetizing instructions

When the screwdriver bit is not sufficiently magnetic, put it at the magnetization area for 5 seconds to instantly magnetize. When stored for a long time, the magnetism of the screwdriver bit will be weakened, so it is necessary to do the magnetizing treatment regularly.

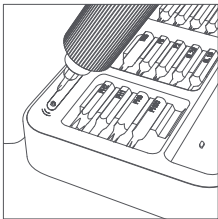
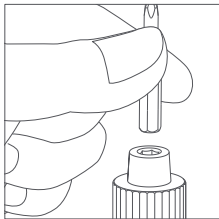

## Forward/reverse button

Press “^” and unscrew or loosen the screw.

Press “v” and screw in or tighten the screw.

## Gear switching toggle

Push the gear switching button and switch between gear “I” and “II”.

Push forward to gear “I” and push backward to gear “II”.

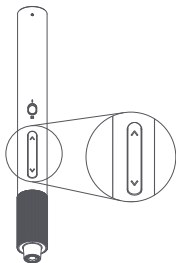

I  $0.45 \pm 0.27 \text{ lbf} \cdot \text{in}$

II  $1.78 \pm 0.7 \text{ lbf} \cdot \text{in}$

## Indicator light state

When the power is lower than 20% during operation, the red indicator light will flash quickly, which will go off when the button is released. Please charge in time.

While charging, the red indicator light presents a breathing lighting style.

When the battery is full, the white indicator light stays on.

(This product is equipped with a Type-C general charging cable.)

## 03 Precautions

---

- A part of the finger may be clipped if the storage box cover is being turned upward too fast. Don't insert your finger into the position indicated in the figure during opening and closing.
- Please make sure the power of the live equipment has been cut off before using this product.
- This product is not a toy and should not be used by children. The screwdriver should only be operated by persons aged 16 years or older.
- The torque indicated in the product parameters is the torque of the screwdriver, not the torque of the bit.
- This product is intended for precision maintenance. Please use the bit matching with the screw during operation. During manual operation, please avoid excessive force to protect the screw or bit from unnecessary damage.

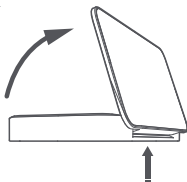

⚠ Risk of squeezing hands in this area when opening and closing



## 04 General Power Tool Safety Warnings

---

**WARNING!** Read all safety warnings, instructions, illustrations and specifications provided with this power tool. Failure to follow all instructions listed below may result in electric shock, fire and/or serious injury.

**Save all warnings and instructions for future reference.**

The term “power tool” in the warnings refers to your mains-operated (corded) power tool or battery-operated (cordless) power tool.

### Work area safety

- **Keep work area clean and well lit.** Cluttered or dark areas invite accidents.
- **Do not operate power tools in explosive atmospheres, such as in the presence of flammable liquids, gases or dust.** Power tools create sparks which may ignite the dust or fumes.
- **Keep children and bystanders away while operating a powertool.** Distractions can cause you to lose control.

### Electrical safety

- **Power tool plugs must match the outlet. Never modify the plug in any way. Do not use any adapter plugs with earthed (grounded) power tools.** Unmodified plugs and matching outlets will reduce risk of electric shock.
- **Avoid body contact with earthed or grounded surfaces, such as pipes, radiators, ranges and refrigerators.** There is an increased risk of electric shock if your body is earthed or grounded.
- **Do not expose power tools to rain or wet conditions.** Water entering a power tool will increase the risk of electric shock.
- **Do not abuse the cord. Never use the cord for carrying, pulling or**

- unplugging the power tool. Keep cord away from heat, oil, sharp edges or moving parts. Damaged or entangled cords increase the risk of electric shock.
- **When operating a power tool outdoors, use an extension cord suitable for outdoor use.** Use of a cord suitable for outdoor use reduces the risk of electric shock.
  - **If operating a power tool in a damp location is unavoidable, use a residual current device (RCD) protected supply.** Use of an RCD reduces the risk of electric shock.

## Personal safety

- **Stay alert, watch what you are doing and use common sense when operating a power tool. Do not use a power tool while you are tired or under the influence of drugs, alcohol or medication.** A moment of inattention while operating power tools may result in serious personal injury.
- **Use personal protective equipment. Always wear eye protection.** Protective equipment such as a dust mask, non-skid safety shoes, hard hat or hearing protection used for appropriate conditions will reduce personal injuries.
- **Prevent unintentional starting. Ensure the switch is in the off-position before connecting to power source and/or battery pack, picking up or carrying the tool.** Carrying power tools with your finger on the switch or energising power tools that have the switch on invites accidents.
- **Remove any adjusting key or wrench before turning the power tool on.** A wrench or a key left attached to a rotating part of the power tool may result in personal injury.
- **Do not overreach. Keep proper footing and balance at all times.** This enables better control of the power tool in unexpected situations.

- **Dress properly. Do not wear loose clothing or jewellery. Keep your hair and clothing away from moving parts.** Loose clothes, jewellery or long hair can be caught in moving parts.
- **If devices are provided for the connection of dust extraction and collection facilities, ensure these are connected and properly used.** Use of dust collection can reduce dust-related hazards.
- **Do not let familiarity gained from frequent use of tools allow you to become complacent and ignore tool safety principles.** A careless action can cause severe injury within a fraction of a second.

## Power tool use and care

- **Do not force the power tool. Use the correct power tool for your application.** The correct power tool will do the job better and safer at the rate for which it was designed.
- **Do not use the power tool if the switch does not turn it on and off.** Any power tool that cannot be controlled with the switch is dangerous and must be repaired.
- **Disconnect the plug from the power source and/or remove the battery pack, if detachable, from the power tool before making any adjustments, changing accessories, or storing power tools.** Such preventive safety measures reduce the risk of starting the power tool accidentally.
- **Store idle power tools out of the reach of children and do not allow persons unfamiliar with the power tool or these instructions to operate the power tool.** Power tools are dangerous in the hands of untrained users.
- **Maintain power tools and accessories.** Check for misalignment or binding of moving parts, breakage of parts and any other condition that may affect

the power tool's operation. If damaged, have the power tool repaired before use. Many accidents are caused by poorly maintained power tools.

- **Use the power tool, accessories and tool bits etc. in accordance with these instructions, taking into account the working conditions and the work to be performed.** Use of the power tool for operations different from those intended could result in a hazardous situation.
- **Keep handles and grasping surfaces dry, clean and free from oil and grease.** Slippery handles and grasping surfaces do not allow for safe handling and control of the tool in unexpected situations.

## Battery tool use and care

- **Recharge only with the charger specified by the manufacturer.** A charger that is suitable for one type of battery pack may create a risk of fire when used with another battery pack.
- **Use power tools only with specifically designated battery packs.** Use of any other battery packs may create a risk of injury and fire.
- **When battery pack is not in use, keep it away from other metal objects, like paper clips, coins, keys, nails, screws or other small metal objects, that can make a connection from one terminal to another.** Shorting the battery terminals together may cause burns or a fire.
- **Under abusive conditions, liquid may be ejected from the battery; avoid contact. If contact accidentally occurs, flush with water. If liquid contacts eyes, additionally seek medical help.** Liquid ejected from the battery may cause irritation or burns.

- **Do not use a battery pack or tool that is damaged or modified.** Damaged or modified batteries may exhibit unpredictable behavior resulting in fire, explosion or risk of injury.
- **Do not expose a battery pack or tool to fire or excessive temperature.** Exposure to fire or temperature above 130°C may cause explosion.
- **Follow all charging instructions and do not charge the battery pack or tool outside the temperature range specified in the instructions.** Charging improperly or at temperatures outside the specified range may damage the battery and increase the risk of fire.

## Service

- **Have your power tool serviced by a qualified repair person using only identical replacement parts.** This will ensure that the safety of the power tool is maintained.
- **Never service damaged battery packs.** Service of battery packs should only be performed by the manufacturer or authorized service providers.

## Safety instructions for all operations

- **Hold the power tool by insulated gripping surfaces, when performing an operation where the cutting accessory or fasteners may contact hidden wiring.** Cutting accessory contacting a “live” wire may make exposed metal parts of the power tool “live” and could give the operator an electric shock.

## Safety instructions when using long drill bits

- **Never operate at higher speed than the maximum speed rating of the drill bit.** At higher speeds, the bit is likely to bend if allowed to rotate freely without contacting the workpiece, resulting in personal injury.
- **Always start drilling at low speed and with the bit tip in contact with the workpiece.** At higher speeds, the bit is likely to bend if allowed to rotate freely without contacting the workpiece, resulting in personal injury.
- **Apply pressure only in direct line with the bit and do not apply excessive pressure.** Bits can bend causing breakage or loss of control, resulting in personal injury.

## Additional safety information

- **Secure the workpiece.** A workpiece clamped with clamping devices or in a vice is held more secure than by hand.
- **Always wait until the power tool has come to a complete stop before placing it down.** The application tool can jam and cause you to lose control of the power tool.
- **Switch the power tool off immediately if the application tool becomes blocked.** Be prepared for high torque reactions which cause kickback. The application tool becomes blocked when it becomes jammed in the workpiece or when the power tool becomes overloaded.
- **Use suitable detectors to determine if there are hidden supply lines or contact the local utility company for assistance.** Contact with electric cables can cause fire and electrical shock. Damaging gas lines can lead to explosion. Breaking water pipes causes property damage.

- **Hold the power tool securely.** When tightening and loosening screws be prepared for temporarily high torque reactions.
- **In case of damage and improper use of the battery, vapours may be emitted.** The battery can set alight or explode. Ensure the area is well ventilated and seek medical attention should you experience any adverse effects. The vapours may irritate the respiratory system.
- **Do not open the battery.** There is a risk of short-circuiting.
- **The battery can be damaged by pointed objects such as nails or screwdrivers or by force applied externally.** An internal short circuit may occur, causing the battery to burn, smoke, explode or overheat.
- **Only use the battery with products from the manufacturer.** This is the only way in which you can protect the battery against dangerous overload.
- **Protect the battery against heat, e.g. against continuous intense sunlight, fire, dirt, water and moisture.** There is a risk of explosion and short-circuiting.
- Power Adapter Output: 5V  $\approx$  0.2A Max.  
Ambient Temperature while Charging: 1 to 40°C



All products bearing this symbol are waste electrical and electronic equipment (WEEE as in directive 2012/19/EU) which should not be mixed with unsorted household waste. Instead, you should protect human health and the environment by handing over your waste equipment to a designated collection point for the recycling of waste electrical and electronic equipment, appointed by the government or local authorities. Correct disposal and recycling will help prevent potential negative consequences to the environment and human health. Please contact the installer or local authorities for more information about the location as well as terms and conditions of such collection points.



We Shanghai HOTO Technology Co., Ltd., hereby, declares that this equipment is in compliance with the applicable Directives and European Norms, and amendments.

## Federal Communications Commission Supplier's Declaration of Conformity

This supplier's declaration of conformity is hereby for

Product: HOTO Electric Precision Screwdriver ADV

Model Number(s): Product model: QWLSA001

Brand/Trade: HOTO

We declare that the above mentioned device has been tested and found in compliance with CFR 47 Part 15 Regulation.

This device complies with part 15 of the FCC Rules. Operation is subject to the following two conditions: (1) This device may not cause harmful interference, and (2) this device must accept any interference received, including interference that may cause undesired operation.

Note: This equipment has been tested and found to comply with the limits for a Class B digital device, pursuant to part 15 of the FCC Rules. These limits are designed to provide reasonable protection against harmful interference in a residential installation. This equipment generates, uses and can radiate radio frequency energy and, if not installed and used in accordance with the instructions, may cause harmful interference to radio communications. However, there is no guarantee that interference will not occur in a particular installation. If this equipment does cause harmful interference to radio or television reception, which can be determined by turning the equipment off and on, the user is encouraged to try to correct the interference by one or more of the following measures:



- Reorient or relocate the receiving antenna.
- Increase the separation between the equipment and receiver.
- Connect the equipment into an outlet on a circuit different from that to which the receiver is connected.
- Consult the dealer or an experienced radio/TV technician for help.

Representative of Responsible Party for SDoC

Company: HOTO (US) TECHNOLOGY CO LTD

Address: 919 North Market Street, Suite 950, Wilmington DE 19801

Country: U.S.A.

Customer Service(US): +1 855-577-2659

Mon-Fri 9:00am-5:00pm(CST)

## Troubleshooting

Fault	Cause	Solution
Equipment does not work	Low battery power	Please charge the equipment in time.
The screwdriver bit cannot be installed	Bit size doesn't match the size of the bit holder	Use C4 screwdriver bit
The surface of the screwdriver bit get stained by rust	High moisture in storage environment	Storage it in dry environment, and apply anti-rust oil on the surface of bit
Screws cannot be screwed during use or slip	Maximum electric torque $0.2\text{N} \cdot \text{m}$	Manually tighten/loosen it (maximum manual torque: $3\text{N} \cdot \text{m}$ )
Battery won't charge	The USB cable isn't plugged in properly or specified charging voltage isn't being used	Check whether the charging indicator is on, insert the USB cable, and use the charging voltage specified in product parameters

# 05 Specifications

---

## Screwdriver

---

Name: HOTO Electric Precision

Screwdriver ADV

Product model: QWLSA001

Color: Dark Gray

Item Dimensions: Approx. 7.17 x 2.81 x 1.03 in

Net Weight: Approx. 0.69 lb

Screwdriver Dimensions: Approx. 6.26 x  $\Phi$ 0.67 in

Screwdriver Net Weight: Approx. 0.13 lb

Charging Time: Approx. 160min

Maximum electric torque: 1.78 lbf·in

Maximum manual torque: 26.55 lbf·in

Input: 5 V  $\equiv$  0.2 A

Rated Voltage: 3.7 V  $\equiv$

Battery Type: Lithium-ion battery

Battery Capacity: 350 mAh

Rotation per Minute (Unloaded): 170r/min

Operating Temperature: -10°C to 45°C

Charging Temperature: 5°C to 40°C

Storage Temperature: -10°C to 45°C

## Screwdriver Bit Parameters

---

Bits model: C4 x L28 mm

Phillips PH000/PH00/PH0/PH1/PH2

Hexagon: H0.7/H0.9/H1.5/H2.0

Slotted: SL1.5/SL2.0

Torx: T2/T3/T4

Security torx: T5H/T6H/T8H/T9H/T10H

Material: S2 alloy steel

Pentalobe: P2/P5

Pozidriv: W1.5

Y-shaped: Y0.6

Tri-wing: TW1

Triangle: 2.3

DECLARATION OF CONFORMITY



EU Declaration of Conformity

We

Shanghai HOTO Technology Co., Ltd.

Declare that the product:

HOTO Electric Precision Screwdriver ADV / QWLSA001

Complies with the essential health and safety requirements of the following directives:

2014/30/EU Electromagnetic Compatibility directive  
References to the following  
harmonized standard were made:

EN55014-1:2021

EN55014-2:2021

ENIEC 61000-3-2:2019+A1:2021

EN 61000-3-3:2013+A2:2021

2011/65/EU+ (EU) 2015/863 Restrictions of the Use of Certain Hazardous Substances  
in Electrical and Electronic Equipment

Authorised signatory and technical file holder:

Shanghai HOTO Technology Co., Ltd.

Building 45, No.50 Moganshan Road, Shanghai, China



## Notes for packaging

The packaging materials are recyclable. Please dispose of packaging in an environmentally friendly manner.

Manufacturer: Shanghai HOTO Technology Co., Ltd.

Address: Building 45, No. 50, Moganshan Road, Shanghai, China

Designed by **HOTO**