

USER'S MANUAL
Meat Grinder
EP24739

THIS INSTRUCTION BOOKLET CONTAINS **IMPORTANT** SAFETY INFORMATION. PLEASE READ AND KEEP FOR FUTURE REFERENCE.

Please give us a chance to make it right and do better!
Contact our friendly customer service department for help first.
Replacements for missing or damaged parts will be shipped ASAP!

Follow Costway
Visit us: www.costway.com
    

Cautions

- Unplug when assembling or disassembling the unit. Close supervision is necessary when any appliance is used near children.
- When carrying the unit, be sure to hold Motor Housing with both hands, not to hold only Hopper Plate. Be careful to carry the unit because it is very heavy.
- Never feed food with hand. Use Food Pusher.
- Do not grinder hard foods such as bones and nuts.
- Do not grind ginger and other materials with hand fiber.
- To avoid jamming, do not force to operate the unit with excessive pressure.
- If other unit jams due to hard maternal lodged on to Feed Screw or Cutting Blade. Switch off immediately and clean the unit. (See "Jamming" on page "3")
- Never try to undo the parts or to repair the unit by yourself. If the supply cord is damaged, it must be replaced by a special cord from your dealer or its service agent.
- The appliance shelf warm against misuse.
- The appliance is so positioned that the plug is accessible.

Before use

- Make sure that the voltage and frequency Indicated on the bottom plate are the same as your Local supply, and that the external earthed wire is Reliable connected.
- Wash all the parts (except those that do not touch food - part1. Part 2) in warm soapy water.
- Before plugging in, ensure switch is off.

Parts identification

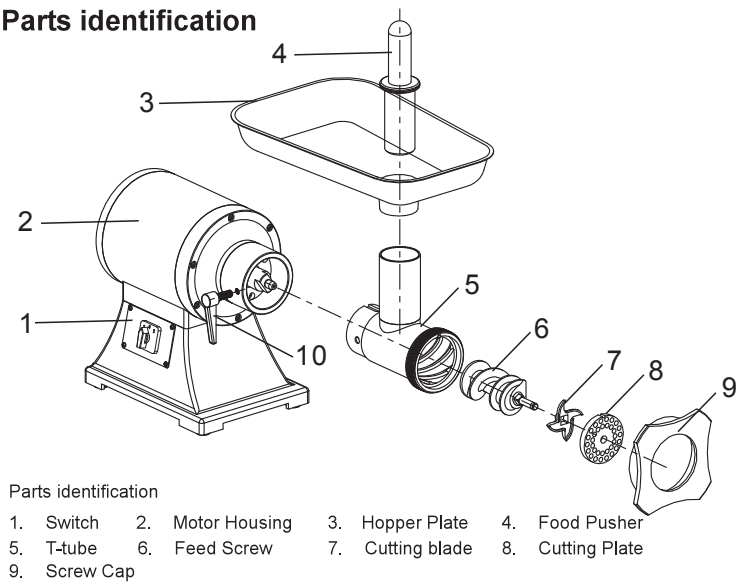

Parts identification

1. Switch 2. Motor Housing 3. Hopper Plate 4. Food Pusher
5. T-tube 6. Feed Screw 7. Cutting blade 8. Cutting Plate
9. Screw Cap

Note:

If the minced meat is not discharged smoothly or in the form of paste; the causes and remedies could be:
(1). Screw cap is tighten too much thus, the cutting blade does not contact properly with the cutting plate; readjust it.
(2). The cutting plate in blocked, clean it.
(3). Cutting Blade edges are dull, grind or replace it.

Jamming

When the motor is locked, or when the motor continues to function, but no meat comes out of cutting plate, due to jamming of bone or other materials that stop the motor, turn switch to REVERSE to clear jamming of bone or other materials.

To clean (Disassembling)

Make sure that the motor has stopped completely.
Disconnect that plug from the power outlet.
Screw cap sides are 1 plane, convenient for unscrewing, if screw cap is too tight; please knock at the planes with a soft-handle. Then screw cap will be unscrewed easily.
Unscrew the locking knob, and take out head(with cutting plate; cutting blade and feed screw). Then put head mouth downward in order to take out cutting plate, cutting blade and feed screw.

(Cleaning)

Remove meat etc. Wash each part with warm soapy water.
■ A bleaching solution containing chlonne will Discolor aluminum surfaces.
■ Do not immerse motor housing in water, but only wipe it with a damp cloth.
■ Thinners and benzenes will crack or change the color of the unit.
A little salad oil on part 6-8 after washing and drying will keep them lubricated.
Care is need when handing cutting blade during cleaning.
Don't use a perforated disc with holes of ≥ 8 mm diameter or smallest with unless an additional protective hood is provided at the discharge outlet.

Technical Specifications

TYPE	EP24739
Productivity	550lbs/h
Speed of blade	193-225r/min
G.W.	48.4lbs

Welcome to visit our website and purchase our quality products!

Your suggestions and comments for COSTWAY are really important to us!
We sincerely solicit you to go back to our shop and leave a good rating in just a simple click. It would be quite encouraging if you could kindly do so like below:

★★★★★ Great products so far
February 24, 2019
Great products so far. Fast delivery, easy setup, and working without any issues.

With your inspiring rating, COSTWAY will be more consistent to offer you EASY SHOPPING EXPERIENCE, GOOD PRODUCTS and EFFICIENT SERVICE!

US office: Fontana, California
UK office: Ipswich



- * Reward Points
- * Exclusive Customer Service
- * Personalized Recommendations
- * Permanent Shopping Cart
- * Order History

5 Star Rating



We would like to extend our heartfelt thanks to all of our customers for taking time to assemble this product and giving us valuable feedbacks.

