

# REPLACEMENT CHAINS FOR CORDLESS ELECTRIC MINI CHAINSAW

Item No. 210340

## User Guide

Thank you for purchasing the Replacement Chains for Cordless Electric Mini Chainsaw. Please read this manual thoroughly before operating this device.

### INSTALLATION INSTRUCTIONS

#### • Installing the Chain:

- Follow the operation instructions to install the chain.
- **Note:** Remove the battery pack during the installation and removal of the guide plate.

#### • Initial Operation:

- After installation, start the machine without load and ensure it runs normally.

#### • Cutting Technique:

- Do not cut too forcefully. Start with small cuts and gradually make larger ones according to the cutting situation.

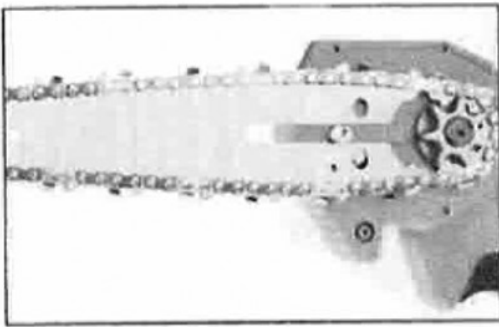

**Fig. 1**

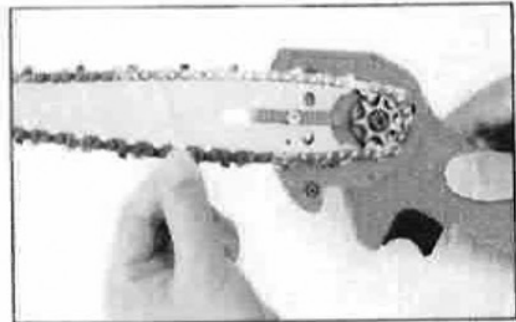

**Fig. 2**

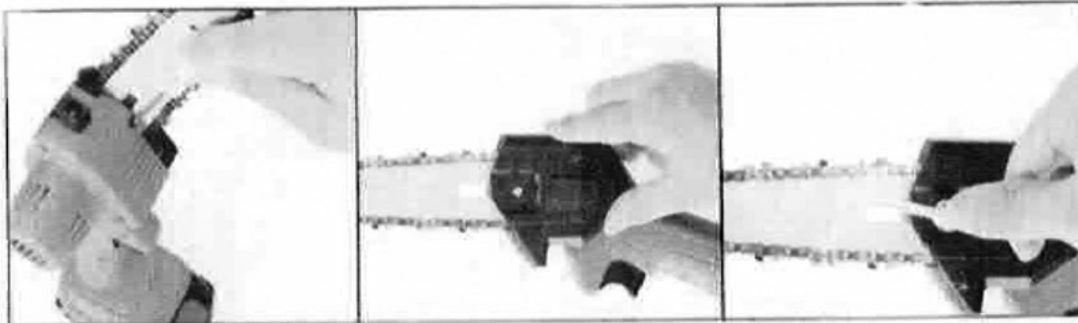

**Fig. 3**

**Fig. 4**

**Fig. 5**

### FIG. 1

**Guide Plate Installation:** When installing the guide plate, ensure the direction of the knife edge on the chain matches the direction indicated on the aluminum parts of the main machine.

### FIG. 2

- **Install the Chain:** Place the chain into the sprocket.
- **Adjust the Guide Plate:** Insert the guide plate adjusting plastic pin into the guide plate hole.

## FIG. 3 AND FIG. 4

### • Install the Guide Plate Cover:

- Place the cover over the guide plate.
- Install the nut but do not fully tighten it.

• **Adjust the Chain Tension:** Use a slotted screwdriver to adjust the guide plate elastic screw until the chain is slightly tight.

### • Note:

- The chain should not be too tight.
- Once adjusted, lock the guide plate gland nut.

### • Recheck and Readjust:

- After the first use or installation, the chain may become loose.
- If the chain loosens, repeat the above steps to readjust.

## FIG. 5

Tighten the Guide Plate Cover: Once all adjustments are made, securely tighten the guide plate cover.

## WARRANTY AND CUSTOMER SERVICE

This item from SharperImage.com includes a 1-year limited replacement warranty. If you have any questions not covered in this guide, please call our Customer Service department at 1 (877) 210-3449. Customer Service agents are available Monday through Friday, 9:00 a.m. to 6:00 p.m. ET.

**SHARPER IMAGE®**

The SHARPER IMAGE® name and logo are registered trademarks.

©Sharper Image. All Rights Reserved.