



# PIVOT-ALL

## MOTION TOOLS®

### Push Broom Assembly Instructions

#### Step 1

Install **Item(s) 1** into Push Broom Housing.  
**Note direction of Pivot-All Sticker.**

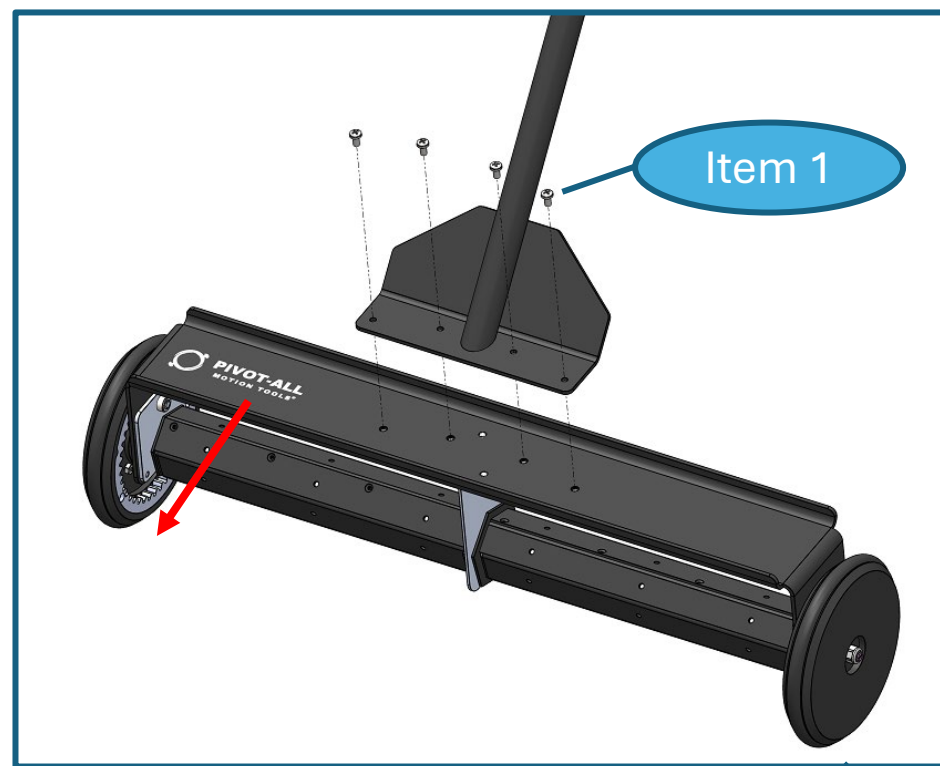

Wheel Gears

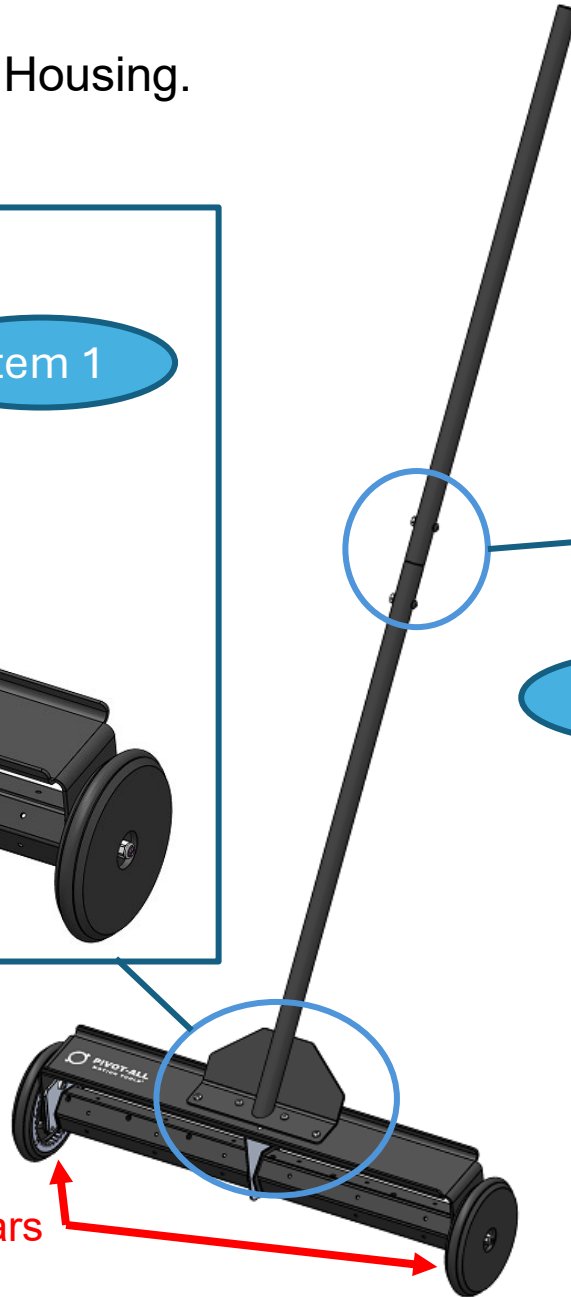

Item	Description	Qty
1	10-32 x 3/8in Screw	4
2	Lower Handle Tube	1
3	Upper Handle Tube	1
4	1/4-20 x 1 1/4in Screw	1
5	1/4-20 Nut	1

#### Step 2

Insert **Item 3** into **Item 2**.

#### Step 3

Install **Items 4 and 5** into Push Broom Handle set.

Directions Before First Use  
Apply a small amount of WD-40 to wheel gears and as need.