

- Keep Flying Bird with your sight.
- Don't play Flying Bird in strong wind, Flying Bird will be out of control and may eventually fly away.
- While the flying bird flies in a breeze, try to fly your Flying Bird in the sky then let it glide in the air without power, it can glide in the air for some distance, Push power stick when the Flying Bird starts to fly down, then it can soar in the air again.
- Please play the Flying Bird outdoor in a wide area when you are a beginner. After become an expert. Try the advanced mode. And play the Flying Bird indoor. Challenge yourself by using the indoor power to control Flying Bird.
- Please keep instruction for further reference.

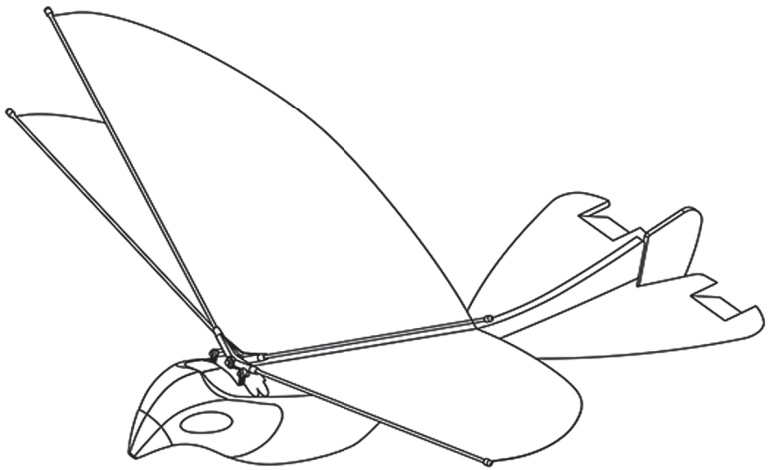

Trouble Shooting

Problem	Cause	Solution
Out of control	Remote controller batteries exhausted.	Please replace the batteries in the controller
	No batteries in the remote controller or power is not enough	Recharge Flying Bird with Remote Control
	Flying bird /Remote controller switch "OFF"	Switch "ON" remote controller and Flying bird
	Inside circuit is broken	Contact supplier
Unstable flying feature	Remote controller batteries exhausted	Recharge Flying Bird with Remote Control before flying
	Fly too fast	Adjust the tail elevator upward
	Fly too slow	Adjust the tail elevator downward
	Direction changes unnormal	The wing is correctly installed, or body deformed
	Power parts unnormal	Contact supplier

-4-

Flapping-wing aircraft remote control bird(radio) instruction manual

Dear client, thank you for choosing our wireless remote digital flying bird. It is a multifunctional intelligent electric toy that can play outside and inside. For safety purpose, please read this manual carefully before playing. We anticipate that our product brings you into funny and excited world.

Packaging list

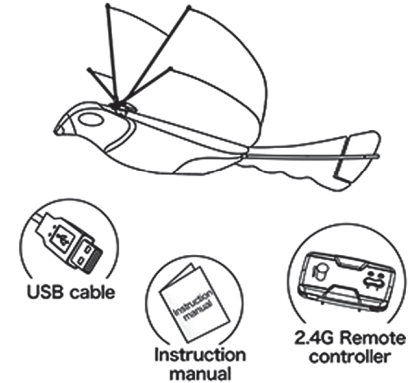

- Single suit:
- 2.4G Remote controller 1 pcs
 - Flying bird 1 pcs
 - USB cable 1 pcs
 - Instruction manual 1 pcs

Technical parameters

- Wing width: 270mm
- Length: 230mm
- Weight: 14g
- Charging time: about 15~20 minutes
- Frequency: 2.4GHz
- Control range: 30~50m
- Operation time: 10~15minutes

Preparation

- Flying bird and radio controller comes completely assembled. All you need to do is to put 4*AA batteries. Note: For the best performance and longer playing time, ALKALINE batteries are recommended(Batteries are not included in this package).
- Be sure the power switch of the controller is in the "OFF" position before installing batteries.
- Open the battery cover with a screwdriver by pressing the button, then remove the door.
- Install new batteries as shown in the polarity diagram(+/-) inside the battery compartment, please refer picture 1.
- Install battery door in proper way, please refer picture 2.

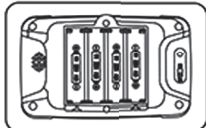

(Picture 1)

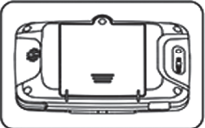

(Picture 2)

-1-

Install landing gear

- Make sure the Flying bird's power is in the "OFF" position before charging.
- Put USB into remote control plug (or power adapter DCSV, or connect to PC for charging).
- Plug USB charge to bird bottom. Light turn on indicate charging, please refer picture 3.
- It takes around 20 minutes to fully charge Flying bird, when the recharge is finished, the indicator shut down.
- Take Flying Bird off from remote charging socket.
- If the remote controller LED flash green, the power is not enough, you need to change new batteries.

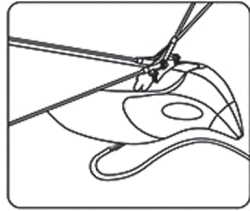

(Picture 3)

Flying adjustment

- Adjust tail enable the bird fly in different way in small space or open area, please refer picture 4.
- Keep the tail and rudder in same altitude.
- Adjust the left and right elevator in the same direction and with the same angel. You can not adjust only one of them. The angel could not exceed 10° to avoid any damage to the elevators, please refer picture.

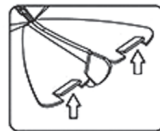

(Picture 4)

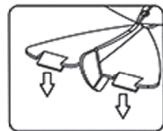

(Picture 5)

How to operate your bird

- Set the power switch of the Flying Bird to the "ON" position, Flying Bird eyes blink a few times then stop flashing, Turn on Controller and push Throttle Stick to top place, then back to bottom place.
- Flying Bird will receive signal with the eyes light on and be ready to fly now.
- There are two stickers in the controller. The left stick controls the flying speed while right stick controls the direction.
- Push left stick until Flying Bird starts to flap wings before you launch the Flying Bird into the sky.
- Hold the body of the Flying Bird carefully and your hand does not interfere flapping.
- Gently throw your Flying Bird upward. Do not throw it too hard.
- After launching, you can control the speed with the left stick and control the direction with the right stick.
- You can push the power button according to flying bird flying feature,
- Please push steadily, do not push the power button up and down continuous, if the bird drop in somewhere, please stop pushing power button, keep the button at the lowest position.
- Control the bird turn right or left by press direction button, please press button constantly, do not keep pressing the button, please note that control direction is opposite when the bird flies toward to you.

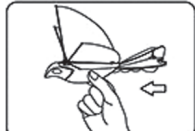

(Picture 6)

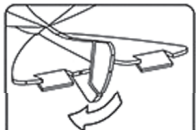

(Picture 7)



(Picture 8)

FCC ID: YGZ-98090

This device complies with part 15 of the FCC Rules. Operation is subject to the following two conditions: (1) This device may not cause harmful interference, and (2) this device must accept any interference received, including interference that may cause undesired operation.

-2-

How to turn off

- Switch off bird ,put bird into packaging box properly, in case of damage.
- Switch off remote control. LED shut off. Please take off battery if long time no use.

Important battery information

- Do not mix use old batteries with new ones or batteries of different types.
- Use only batteries specified and be sure to insert item correctly by the "+" and "-" polarity markings, Always follow the toy and battery manufacturer's instruction.
- Remove batteries when not in use. Always remove exhausted batteries from the controller.
- Dispose batteries properly.
- Battery installation should be done by an adult.
- Only batteries of the same or equivalent type as recommended are to be used. Do not mix with other types of batteries.
- Please turn off the power when not in use.
- Always follow the instruction carefully.
- Please follow toys and manufacturer instruction.
- Non-rechargeable batteries are not to be recharged.
- Recharge operated by adult.
- Never leave a rechargeable flying bird unattended when charging.
- Rechargeable batteries are not recommended for use in the controller.
- Never short-circuit the battery terminals.
- Dispose of old batteries promptly and properly; do not burn or bury them.
- Do not dispose of batteries in a fire, batteries may explode or leak.
- Do not open a battery as it may burst and release toxic liquids.
- Poor contact will lead to loss of power.
- Should this product cause, or be affected by, local electrical interference, move it away from other electrical equipment. Reset(switching off and on again or removing and re-assembling batteries) if necessary.
- Charge the Flying Bird with the supplied charger(controller)only.

Caution

- Be sure to operate flying bird only under adult supervision
- Do not fly near cars, pet, overhead wires, bodies of water, buildings, trees, etc.
- Operate Flying Bird in an open area and fly away from people, streets, houses, trees or power lines.
- The toy is not intended for children under 3 years old.
- Do not put other objects or tie material around Flying Bird.
- Do not hold the wings while the Flying Bird is flapping.
- Always switch off the Flying Bird and remove all batteries from the controller after you have used the Bird.
- Never leave weak or dead batteries in the controller, as they may leak damaging chemicals.
- Remove all packaging material before the toy is given to a child.

Help tips

- Play flying bird need under adult supervision.
- Do not expose the Radio Controller to water. If the controller is accidentally exposed to water, remove the controller battery and allow the controller to air-dry. Replace with fresh batteries before resuming operation.
- Do not bend the wings of Flying Bird as this may affect its performance
- Do not store the Flying Bird or controller near heat or in direct sunlight.
- Flying Bird flies steadily when the wings are balanced.

-3-

- Keep Flying Bird with your sight.
- Don't play Flying Bird in strong wind, Flying Bird will be out of control and may eventually fly away.
- While the flying bird flies in a breeze, try to fly your Flying Bird in the sky then let it glide in the air without power, it can glide in the air for some distance, Push power stick when the Flying Bird starts to fly down, then it can soar in the air again.
- Please play the Flying Bird outdoor in a wide area when you are a beginner. After become an expert. Try the advanced mode. And play the Flying Bird indoor. Challenge yourself by using the indoor power to control Flying Bird.
- Please keep instruction for further reference.

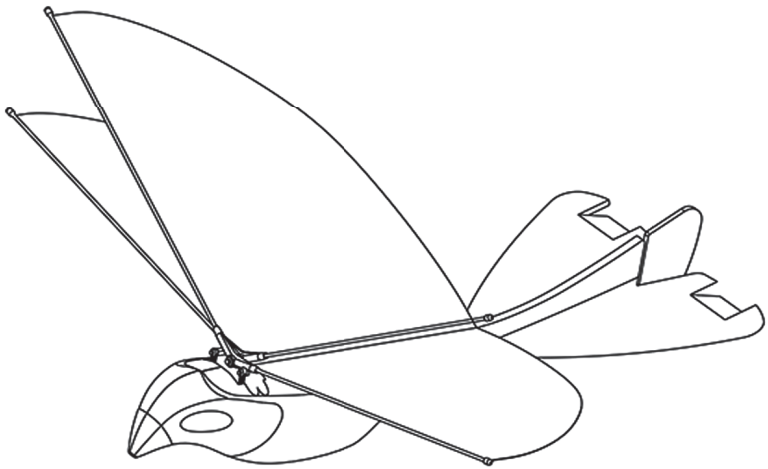

Trouble Shooting

Problem	Cause	Solution
Out of control	Remote controller batteries exhausted.	Please replace the batteries in the controller
	No batteries in the remote controller or power is not enough	Recharge Flying Bird with Remote Control
	Flying bird /Remote controller switch "OFF"	Switch "ON" remote controller and Flying bird
	Inside circuit is broken	Contact supplier
Unstable flying feature	Remote controller batteries exhausted	Recharge Flying Bird with Remote Control before flying
	Fly too fast	Adjust the tail elevator upward
	Fly too slow	Adjust the tail elevator downward
	Direction changes unnormal	The wing is correctly installed, or body deformed
	Power parts unnormal	Contact supplier

-4-

Flapping-wing aircraft remote control bird(radio) instruction manual

Dear client, thank you for choosing our wireless remote digital flying bird. It is a multifunctional intelligent electric toy that can play outside and inside. For safety purpose, please read this manual carefully before playing. We anticipate that our product brings you into funny and excited world.

Packaging list

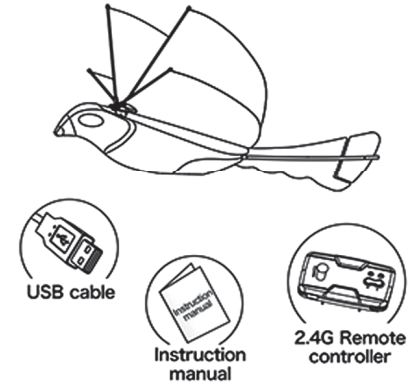

- Single suit:
- 2.4G Remote controller 1 pcs
 - Flying bird 1 pcs
 - USB cable 1 pcs
 - Instruction manual 1 pcs

Technical parameters

- Wing width: 270mm
- Length: 230mm
- Weight: 14g
- Charging time: about 15~20 minutes
- Frequency: 2.4GHz
- Control range: 30~50m
- Operation time: 10~15minutes

Preparation

- Flying bird and radio controller comes completely assembled. All you need to do is to put 4*AA batteries. Note: For the best performance and longer playing time, ALKALINE batteries are recommended(Batteries are not included in this package).
- Be sure the power switch of the controller is in the "OFF" position before installing batteries.
- Open the battery cover with a screwdriver by pressing the button, then remove the door.
- Install new batteries as shown in the polarity diagram(+/-) inside the battery compartment, please refer picture 1.
- Install battery door in proper way, please refer picture 2.

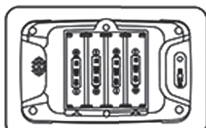

(Picture 1)

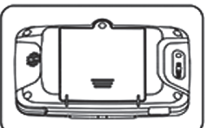

(Picture 2)

-1-

Install landing gear

- Make sure the Flying bird's power is in the "OFF" position before charging.
- Put USB into remote control plug (or power adapter DCSV, or connect to PC for charging).
- Plug USB charge to bird bottom. Light turn on indicate charging, please refer picture 3.
- It takes around 20 minutes to fully charge Flying bird, when the recharge is finished, the indicator shut down.
- Take Flying Bird off from remote charging socket.
- If the remote controller LED flash green, the power is not enough, you need to change new batteries.

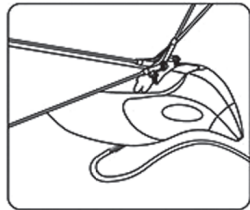

(Picture 3)

Flying adjustment

- Adjust tail enable the bird fly in different way in small space or open area, please refer picture 4.
- Keep the tail and rudder in same altitude.
- Adjust the left and right elevator in the same direction and with the same angel. You can not adjust only one of them. The angel could not exceed 10° to avoid any damage to the elevators, please refer picture.

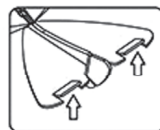

(Picture 4)

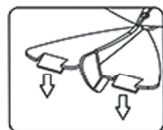

(Picture 5)

How to operate your bird

- Set the power switch of the Flying Bird to the "ON" position, Flying Bird eyes blink a few times then stop flashing, Turn on Controller and push Throttle Stick to top place, then back to bottom place.
- Flying Bird will receive signal with the eyes light on and be ready to fly now.
- There are two stickers in the controller. The left stick controls the flying speed while right stick controls the direction.
- Push left stick until Flying Bird starts to flap wings before you launch the Flying Bird into the sky.
- Hold the body of the Flying Bird carefully and your hand does not interfere flapping.
- Gently throw your Flying Bird upward. Do not throw it too hard.
- After launching, you can control the speed with the left stick and control the direction with the right stick.
- You can push the power button according to flying bird flying feature,
- Please push steadily, do not push the power button up and down continuous, if the bird drop in somewhere, please stop pushing power button, keep the button at the lowest position.
- Control the bird turn right or left by press direction button, please press button constantly, do not keep pressing the button, please note that control direction is opposite when the bird flies toward to you.

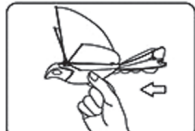

(Picture 6)

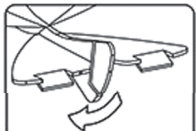

(Picture 7)

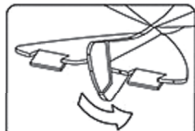

(Picture 8)

FCC ID: YGZ-98090

This device complies with part 15 of the FCC Rules. Operation is subject to the following two conditions: (1) This device may not cause harmful interference, and (2) this device must accept any interference received, including interference that may cause undesired operation.

-2-

How to turn off

- Switch off bird ,put bird into packaging box properly, in case of damage.
- Switch off remote control. LED shut off. Please take off battery if long time no use.

Important battery information

- Do not mix use old batteries with new ones or batteries of different types.
- Use only batteries specified and be sure to insert item correctly by the "+" and "-" polarity markings, Always follow the toy and battery manufacturer's instruction.
- Remove batteries when not in use. Always remove exhausted batteries from the controller.
- Dispose batteries properly.
- Battery installation should be done by an adult.
- Only batteries of the same or equivalent type as recommended are to be used. Do not mix with other types of batteries.
- Please turn off the power when not in use.
- Always follow the instruction carefully.
- Please follow toys and manufacturer instruction.
- Non-rechargeable batteries are not to be recharged.
- Recharge operated by adult.
- Never leave a rechargeable flying bird unattended when charging.
- Rechargeable batteries are not recommended for use in the controller.
- Never short-circuit the battery terminals.
- Dispose of old batteries promptly and properly; do not burn or bury them.
- Do not dispose of batteries in a fire, batteries may explode or leak.
- Do not open a battery as it may burst and release toxic liquids.
- Poor contact will lead to loss of power.
- Should this product cause, or be affected by, local electrical interference, move it away from other electrical equipment. Reset(switching off and on again or removing and re-assembling batteries) if necessary.
- Charge the Flying Bird with the supplied charger(controller)only.

Caution

- Be sure to operate flying bird only under adult supervision
- Do not fly near cars, pet, overhead wires, bodies of water, buildings, trees, etc.
- Operate Flying Bird in an open area and fly away from people, streets, houses, trees or power lines.
- The toy is not intended for children under 3 years old.
- Do not put other objects or tie material around Flying Bird.
- Do not hold the wings while the Flying Bird is flapping.
- Always switch off the Flying Bird and remove all batteries from the controller after you have used the Bird.
- Never leave weak or dead batteries in the controller, as they may leak damaging chemicals.
- Remove all packaging material before the toy is given to a child.

Help tips

- Play flying bird need under adult supervision.
- Do not expose the Radio Controller to water. If the controller is accidentally exposed to water, remove the controller battery and allow the controller to air-dry. Replace with fresh batteries before resuming operation.
- Do not bend the wings of Flying Bird as this may affect its performance
- Do not store the Flying Bird or controller near heat or in direct sunlight.
- Flying Bird flies steadily when the wings are balanced.

-3-