



1



12x CORNER CONNECTOR



4x TUBE CONNECTORS



2x SUCTION CUPS



16x LONG TUBES

2

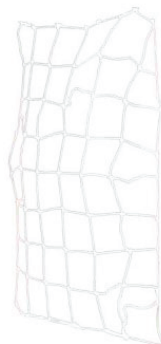

2x GOAL NET

3

INCLUDED CONTENTS:

1. Hovering Soccer Ball
2. Goal Frame Components
3. Goal Net

SETTING UP THE HOVERING SOCCER BALL

1. Underneath the soccer ball turn the 2x cover latches to the unlock  position.
2. Insert 4x AA batteries. Taking care to match the correct polarity +/-.
3. Replace battery cover and turn switch on to start the hovering action.



Turn cover latches to the unlock position

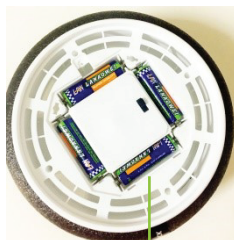

Install 4x AA Batteries

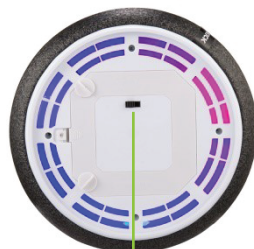

On/Off Switch

ASSEMBLING THE GOAL

STEP 1

To make each goal collect the parts listed below:



6x CORNER CONNECTORS



2x TUBE CONNECTORS



1x GOAL NET

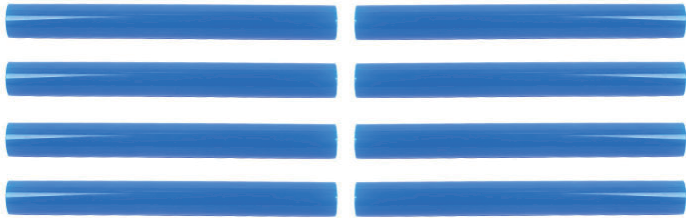

8x LONG TUBES

STEP 2

Assemble the crossbar of the goal by connecting two long tubes using a tube connector.

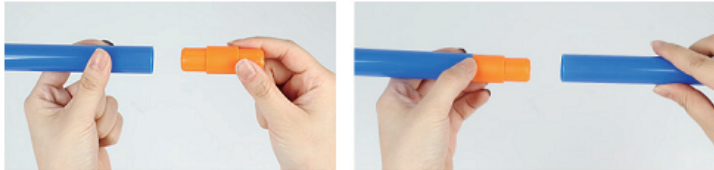

STEP 3

Connect the goal crossbar to the goalposts using a two corner connector and two more long tubes.

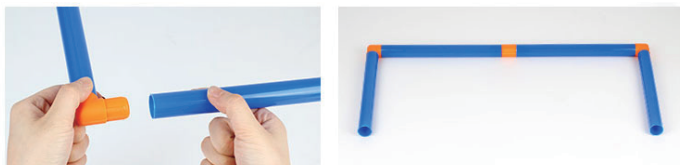

STEP 4

Repeat steps 2 & 3 to make the goal base.

STEP 5

Connect the goal posts to the goal base with two more corner connectors.

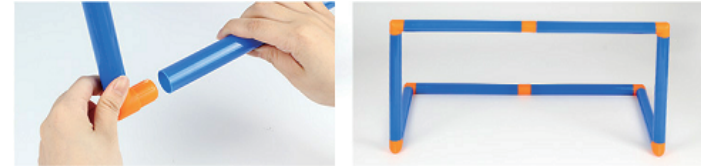

STEP 6

Stretch the goal net over the goal frame.



STEP 7

Clip on one of the suction cups in the center of the goal to secure the goal to a smooth floor.



STEP 8

Repeat steps 1 thru 7 to make the other goal.



For Customer Service please email:
Care@OdysseyToys.com

Please note the units model number and name in your email:
Model no. ODY-530 • Hovering Soccer Ball Set

www.OdysseyToys.com

CAUTIONS & WARNINGS

- Suitable for ages 3 and up. Adult supervision is always recommended.
- This product contains small parts which are a choking hazard. Keep away from small children.
- Manufacturers and dealers disclaim all responsibility for damage caused by misuse.
- Keep hair and loose clothing away from hovering soccer ball fans when powered on.
- If the soccer ball will be stored and unused for an extended period of time, please remove the batteries.
- Check the batteries regularly for potential leakage or corrosion that may occur.
- When installing the batteries carefully follow the polarity marking +/-.
- Do not mix different battery types.
- Remove exhausted or drained batteries.

CARE & MAINTENANCE

- Do not submerge the unit in any liquids.
- Keep the unit dry.
- Do not place the unit near powerful, un-shielded magnets.
- Do not expose the unit to extreme hot or cold temperatures.
- Do not hit, drop, or smash the unit with extreme force.
- Do not disassemble the unit for any reason.

NOT FOLLOWING THESE PRECAUTIONS WILL VOID YOUR WARRANTY.

MADE IN CHINA

