

PET BOOSTER SEAT

ONE YEAR LIMITED WARRANTY (UNITED STATES ONLY)

This product is to be free of defects in materials or workmanship for one (1) year from the date of purchase for the original purchaser. The manufacturer is not responsible for any consequential or incidental damages arising from the breach of this or any other warranty, whether express, implied or statutory. Some states do not allow the exclusion or limitation of consequential or incidental damages, so the above exclusion may not apply to you. This warranty gives you specific legal rights, and you may also have other rights which vary from state to state. Any attempt to self-repair the product will void the limited warranty. Valid only in the USA.

- 1 Fasten the seat belt on the desired seat. Place the Pet Booster Seat on the car seat with the pockets facing up. Lift both outside flaps to open the seat compartment.

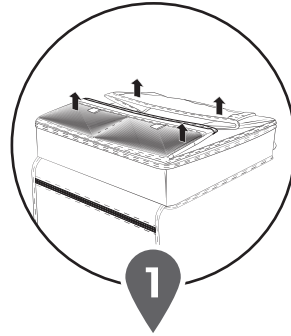

- 2 Install the padded cushion.

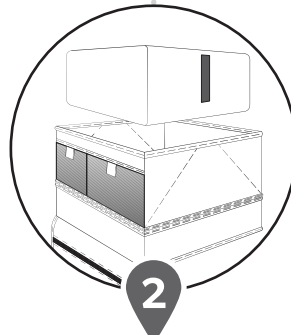

- 3 Clip the two back buckles around the bottom strap of the fastened seat belt.

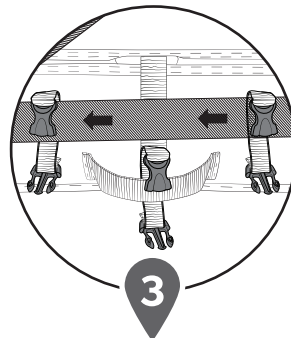

- 4 Clip the harness strap to the back handle. Take the clasp and pass through the opening above the back handle.

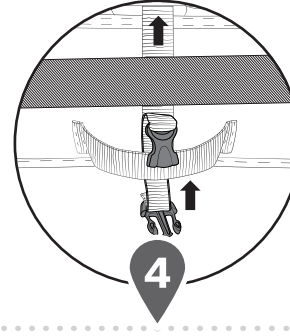

- 5 Wrap the top straps around the headrest and clip together. Adjust straps so the booster seat lays flat on the seat cushion.

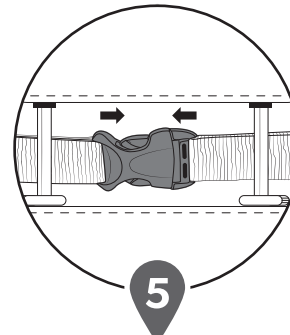

- 6 Attach the clasp to your pet's harness. Loosen or tighten the harness strap as needed to secure your pet. DO NOT ATTACH TO YOUR PET'S COLLAR as this can cause severe injury or death to your pet during an incident.

