



Milex
everyday home essentials

Cordless Stick Vac

USER MANUAL



everyday home essentials



GET WITH THE TRENDS! GO CORDLESS!

IMPORTANT SAFEGUARDS

WARNING: To reduce the risk of fire, electrical shock, or injury, please **READ ALL INSTRUCTIONS BEFORE USING YOUR VACUUM CLEANER.**

When using an electrical appliance, basic safety precautions should always be observed, including the following

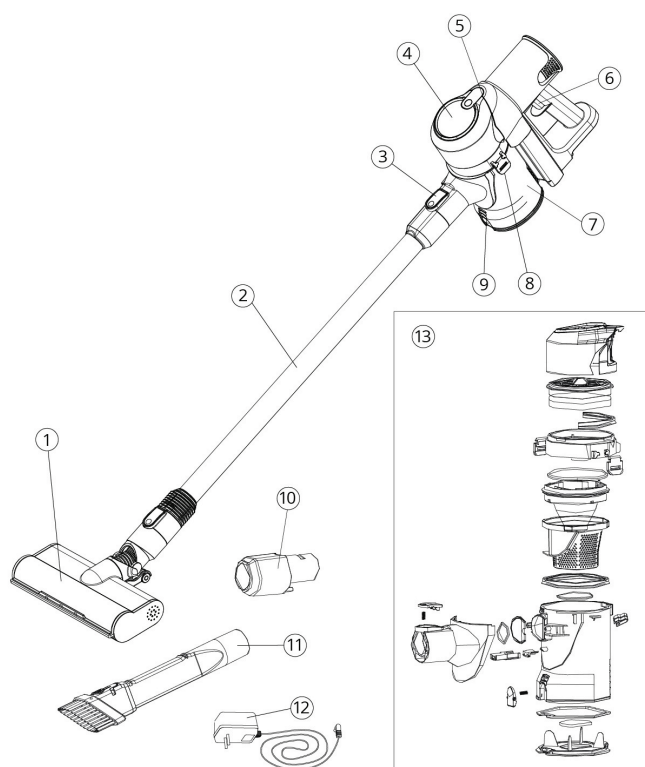

1. Do not use it outdoors or on wet surfaces. Use only on dry, indoor surfaces.
2. Close attention is necessary when used by or near children. This is not a toy.
3. Use only as described in this manual. Use only the manufacturer's recommended attachments .
4. Do not use the vacuum if it has been damaged, left outdoors, dropped, or dropped in water. Contact After -sales Service Centre.
5. Do not handle plug or appliance with wet hands.
6. Do not put any objects into openings. Do not use with any opening blocked; keep free of dust, lint, hair, or anything that may reduce airflow.
7. Keep hair, loose clothing, fingers, and all parts of the body away from openings and moving parts.
8. Do not pick up anything that is burning or smoking, such as cigarettes,matches, or hot ashes.
9. Use extra care when cleaning on stairs .
10. Do not use to clean up flammable or combustible liquids such as gasoline and do not use in areas where these flammable or combustible liquids may be present.
11. Review your vacuum cleaner and follow all labels and marking instructions.
12. Keep the end of the hose, wands, and other openings away from your face and body.
13. Do not use the vacuum cleaner without the Dust Cup filter in place.
14. Always switch off and unplug this appliance before connecting or disconnecting the vacuum hose.
15. Store the vacuum indoors. Put the vacuum away after use to prevent any accidents.
16. Please use the recommended batteries. Using an incorrect battery will damage the motor and could be harmful to user.
17. Do not use it for any other purposes other than described in this user Instruction Manual.
18. If the supply cord is damaged, it must be replaced to avoid a hazard.



1. Motorized Floor-Brush Head
2. Aluminum Tube
3. Tube Release Button
4. Indicator Light
5. Body Release Button
6. Power Switch
7. Dust Cup
8. Dust Tank Upper Part Release Button
9. Dust Tank Bottom Release Button
10. Joint Connector
11. Multi Crevice Nozzle
12. Adaptor
13. Filter Set (Fine Foam & HEPA Filter)

PRECAUTIONARY MEASURES

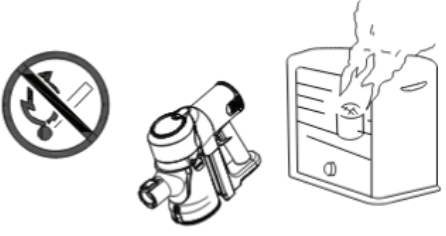
If the opening sucks in the air, the brush or the extension tubes are blocked, immediately switch off the vacuum cleaner at once. First, clear the blocked substance(s) carefully before you attempt to start the vacuum cleaner again.

<p>1. Do not operate the vacuum cleaner too close to heaters, radiators, cigarette butts, etc.</p>	
<p>2. Before you start using the vacuum cleaner, please remove large or sharp objects from the floor to prevent damaging the vacuum filter.</p> <p>3. Do not use the vacuum to clean anything IX. easy to burning, such as gas and cigarettes. Or flammable or combustible materials or liquids.</p>	

ASSEMBLING THE VACUUM CLEANER WITH ACCESSORIES

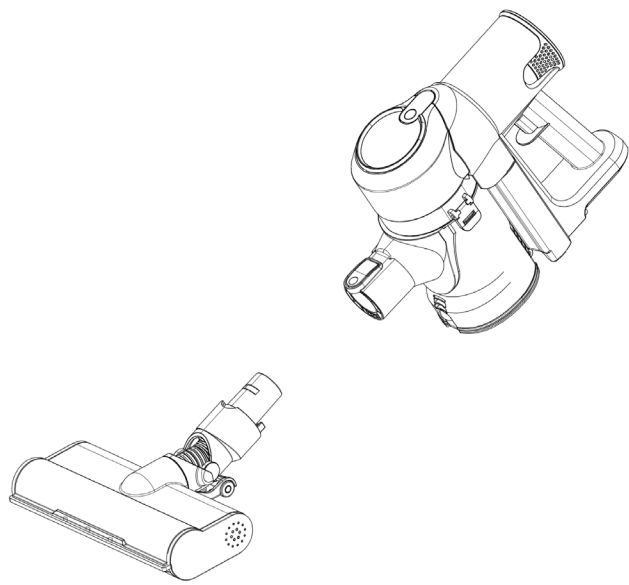
<p>Install the floor - brush head:</p> <p>The floor-brush head is suitable for all floor surfaces .</p> <p>The floor - brush head can be connected directly to the vacuum cleaner body unit until you hear an audible clicking sound.</p>	
--	--

Disassemble the floor - brush head:

Press the tube release button, then remove the aluminum tube and floor - brush head.

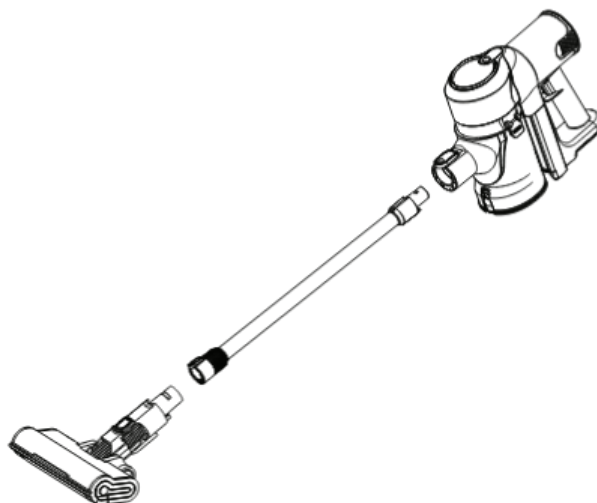

Remove and install the dust cup:

- **Remove dust cup from the body:**
Push the release button and remove the dust cup from the body as attached. (fig. A)
- **Install dust cup on the body:**
First, to fit the bottom part of the dust cup with the body, followed by the top part (refer to attached fitting position and direction). Make sure it is properly locked with a clicking sound. (fig. B)

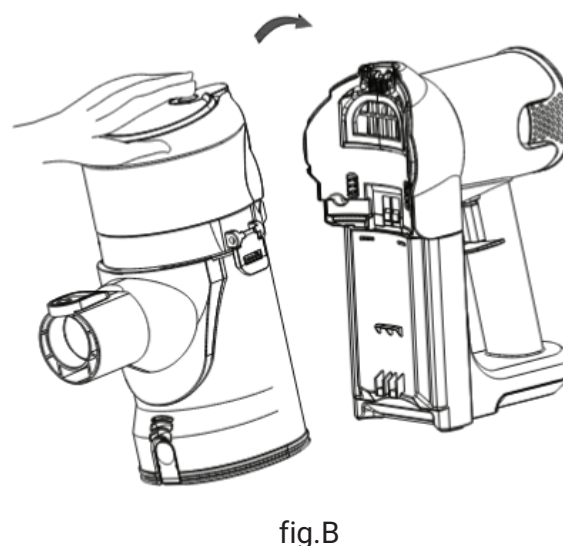
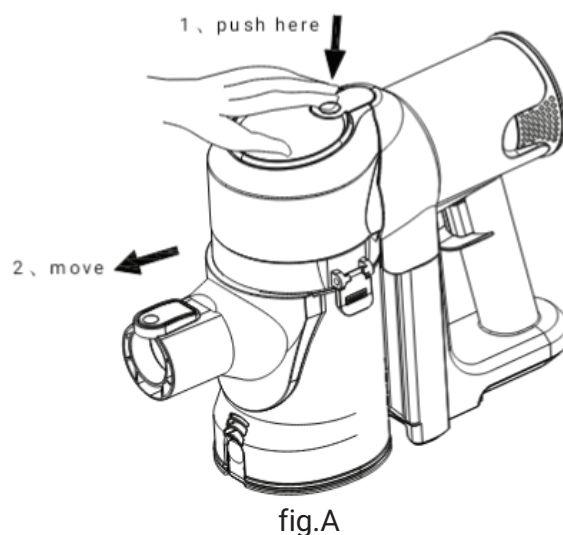

Remove and Install the Battery Pack:

- **Remove the Battery Pack:**
Push the button on the side to release the battery pack, remove it from the slot as per the direction shown.
- **Install the Battery Pack:**
Place the battery pack in the designated slot and push it according to the direction shown until it is perfectly locked with a clicking sound.

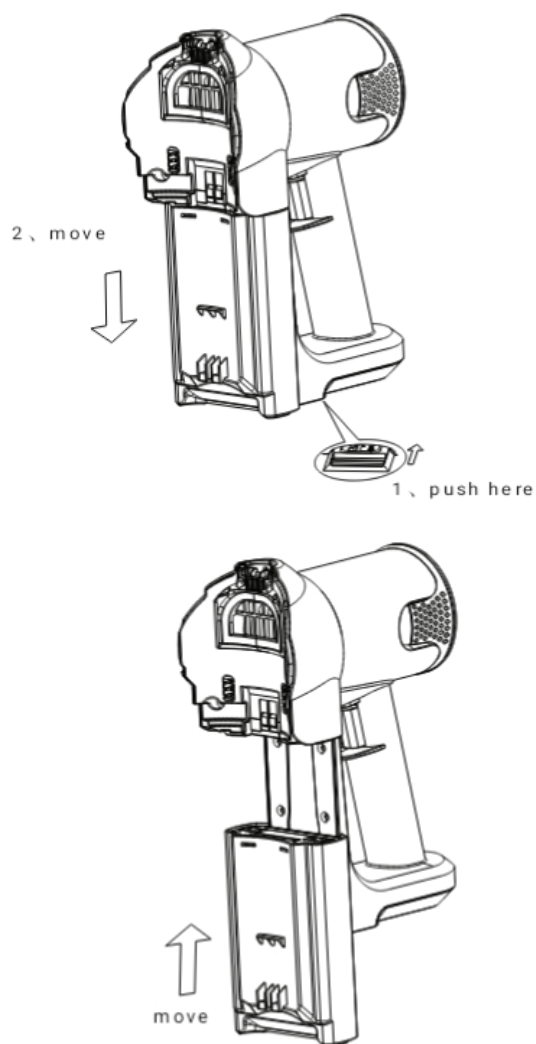

Indicator Light:

- The indicator light bars (area A) will be extinguished during operation as the battery power decreases.
- If the device is fully charged, All the lights in area A will be on.

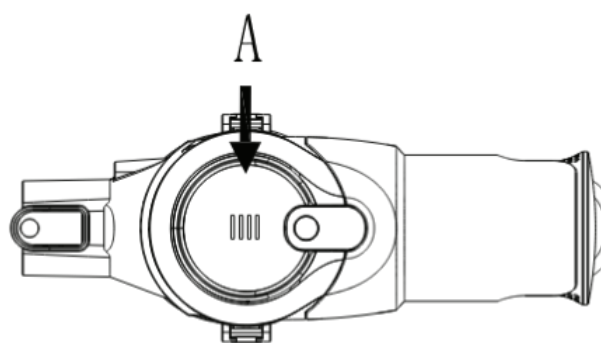

CLEANING THE VACUUM CLEANER

How to clean the Dust Cup:

1. Remove the dust cup from the body.
2. Press the dust cup bottom release button and pour the dust. (fig. A)
3. Press the dust cup cover release button (for air exhaust) and take out the filter assembly from the dust cup if you find the plastic filter system is dirty. You may clean them with a soft brush or wash them with water. All components must be dried completely before you use them again. (fig.B).

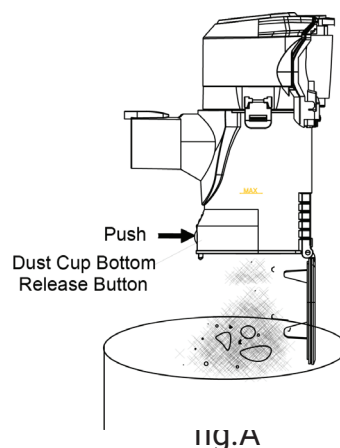

fig.A

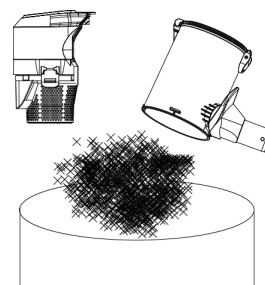

fig.B

Replacing or Cleaning Sponge and HEPA filter

1. Remove the dust cup from the body.
2. Rotate the dust cup cover anticlockwise from "close" to "open", take out the dust cup cover . Take out the sponge and HEPA filter set. (fig . A)
3. Pull up the knob of the filter frame, and take out the sponge filter and HEPA filter from the case. Clean the Sponge and HEPA filter with a soft brush or rinse it with warm water. Make sure it is dried completely before use. All filters are washable. (Please clean it regularly to retain optimum suction power) (fig. B)
4. Note: All filters should be equipped correctly before operating the vacuum cleaner again.

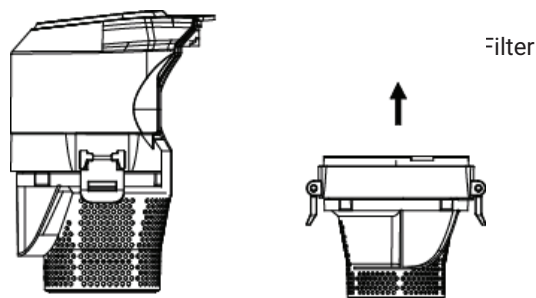

fig.A

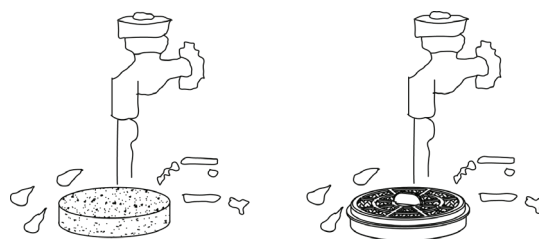

fig.B

TROUBLE SHOOTING GUIDE

ISSUES	POSSIBLE CAUSES	SOLUTIONS
Vacuum Cleaner does not function	Battery	Make sure the <ul style="list-style-type: none"> Battery is fully charged. Battery pack is installed correctly.
Weak suction	<ul style="list-style-type: none"> Low Battery Dust Cup is full Filters are clogged 	Make sure the <ul style="list-style-type: none"> Battery is fully charged. Dust cup, sponge filter and HEPA filter are cleaned regularly.
Dust escaping	Dust Cup is full or not assembled correctly	Clean the dust cup and check if it is assembled correctly.
Brush head does not pick up	<ul style="list-style-type: none"> Dust Cup is full Brush head is tangled 	Make sure the <ul style="list-style-type: none"> Dust cup and brush head are cleaned regularly.



Milex
everyday home essentials

return policy & warranty

Please note that all Milex product returns are subject to the following conditions :

- Original proof of purchase must be produced.
- All accessories that come with the product are returned, and complete in all respects. Any item received with the product purchased must be returned.
- All products carry a 14 day money back guarantee and an exchange if the product is unopened or unused, unless expressly indicated on the product.
- All products must be returned in their original packaging.
- **Milex** reserves the right to refer products to the head office for assessment when an in-store decision regarding defect cannot be taken.

Certificate of Warranty

www.milex.co.za

(Excludes monetary refunds under normal purchasing conditions)

Our goods come with guarantees that are consistent with the Consumer Protection Act. You are entitled to a replacement for any major failure or manufacturing defect. You are also entitled to have the goods repaired or replaced if the goods fail to meet prescribed specifications or quality standards.

The benefits under the MILEX warranty are in conjunction with other rights you will be entitled to under the Consumer Protection Act in relation to the goods.

Warranty against defects: Homemark (Pty) Ltd warrants the product to be free of any defects in materials & workmanship for a period of 12 months from the date of purchase ("Warranty"). However, the Warranty does not apply with respect of products damaged by unreasonable use or by use for which the product is not intended. The warranty will not cover defects resulting from alteration, accident, misuse, abuse or neglect & the warranty is otherwise subject to the terms & conditions.