

The shower uses solar energy from the sun to heat the water.

Before you begin, please check to ensure you have all the parts. Read ALL the directions before beginning.

1 - Shower Upper Tube Assembly	1	6 - 19mm Rubber Gasket	3	TOOLS NEEDED 1 3/8" socket or adjustable wrench
2 - Shower Lower Tube Assembly	1	7 - Footwash	1	
3 - 85mm O-Ring	1	8 - Concrete Anchor System	4	
4 - Shower Head Assembly	1	8a M10x25 Bolt	4	
4a Shower Head	1	8b M10 Washer	4	
4b 24mm Shower Head Gasket	1	8c 12/40mm Drop-in Concrete Anchor	4	
4c 19mm Gasket Washer	1			
4d 1-1/4" Shower Connector	1	9 - Garden Hose Adapter	1	
5 - Shower Head Attachment Pipe	1			

When using tools, care must be taken not to scratch and/or damage gold plating. We recommend using a cloth between wrench and shower parts to avoid scratching and/or damage.

MOUNTING THE SHOWER: CONCRETE/MASONRY INSTALLATION ONLY

1. Choose a location for shower that receives the most direct sunlight.
2. Use the base plate on the lower shower tube to mark the position of the mounting holes. FIGURE 3
3. Remove shower. Drill 1/2" diameter holes, 2" deep, using the marks just created.
4. Insert expansion nuts into holes. Place the long bolt inside the expansion nut and TAP with a hammer to slightly expand the nut.
5. Remove bolt and place the base plate on the lower shower tube over the holes and secure to surface with bolts and washers provided. NOTE: Base plate will appear loose until shower is fully secured to the surface.

ASSEMBLING THE SHOWER

1. If not assembled, assemble the shower head assembly. FIGURE 1
2. Install footwash and 19mm gasket washer into lower tube. FIGURE 3
3. Install the shower head assembly onto the end of the shower head attachment pipe. DO NOT OVERTIGHTEN. FIGURE 2
4. Install the shower head attachment pipe into the fitting on the upper shower tube. Turn gently until pipe is secure and shower head is pointing down. NOTE: If shower arm is stopped by end of threads in any other orientation, rotate shower arm counter-clockwise until it is pointed downward. FIGURE 2
5. Install the 85mm O-Ring into the circular groove on the lower shower tube. FIGURE 4
6. Set the upper shower tube on the lower shower tube. Rotate the upper shower tube to lock it to the lower shower tube. NOTE: The shower head, footwash, and temperature knob should all face the same direction. FIGURES 4 & 6
7. Attach garden hose adapter to the water inlet port of the solar shower. FIGURE 5
8. Attach garden hose to the garden hose adapter on the solar shower and to the the water supply. NOTE: Be sure that the garden hose is located safely to avoid any tripping hazards. FIGURE 5

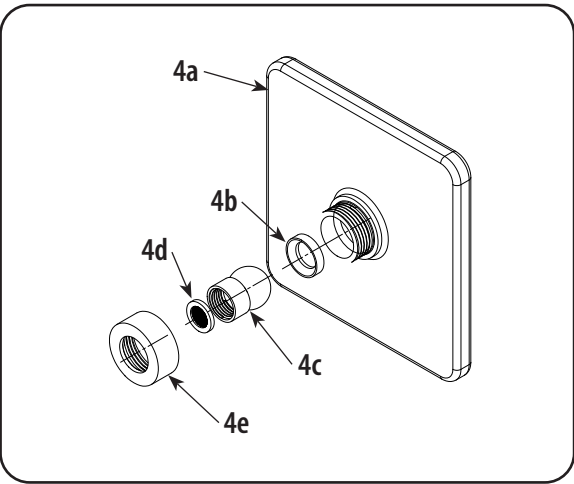
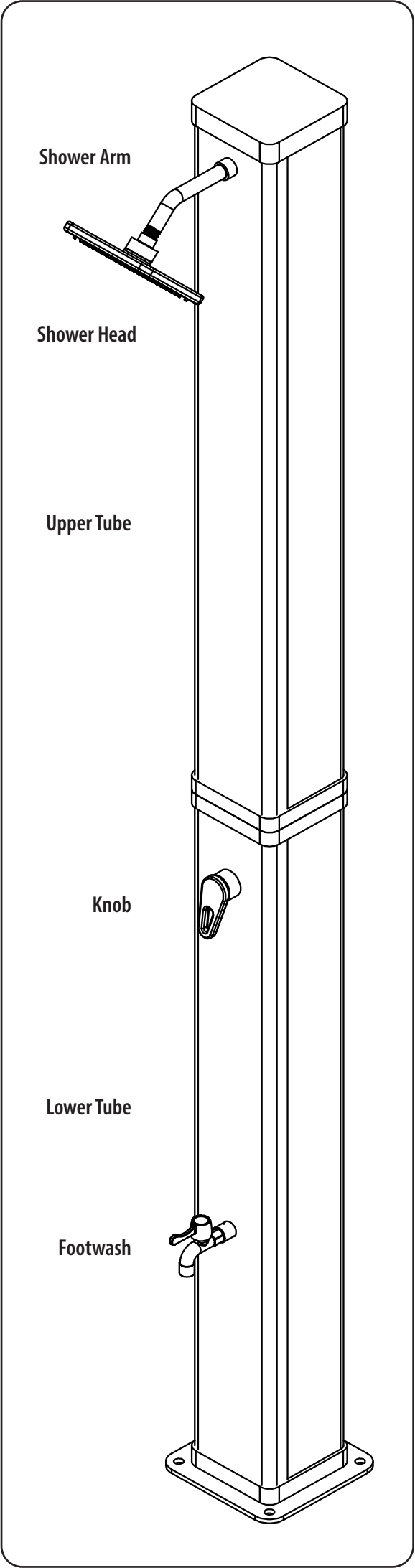

FIGURE 1

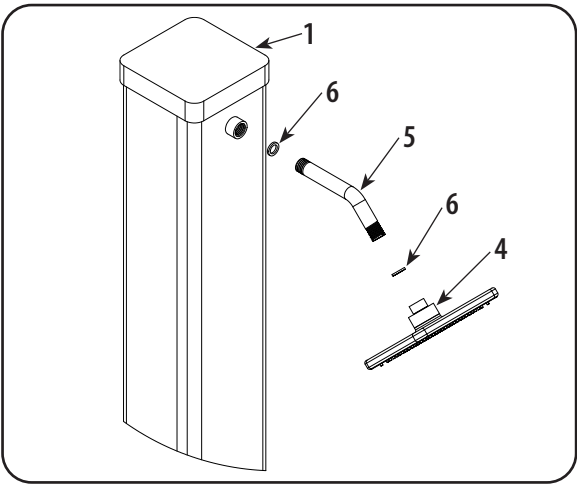

FIGURE 2

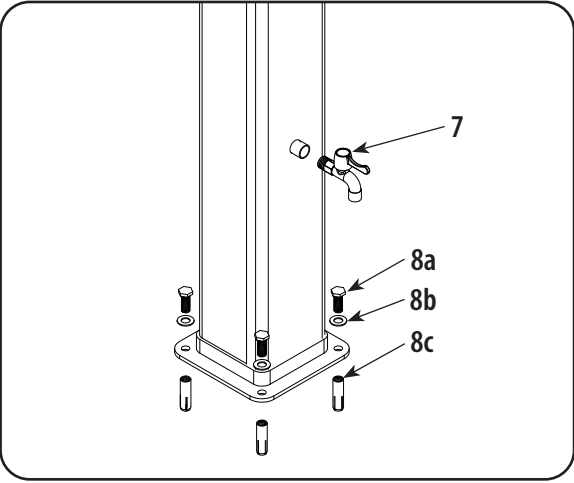

FIGURE 3

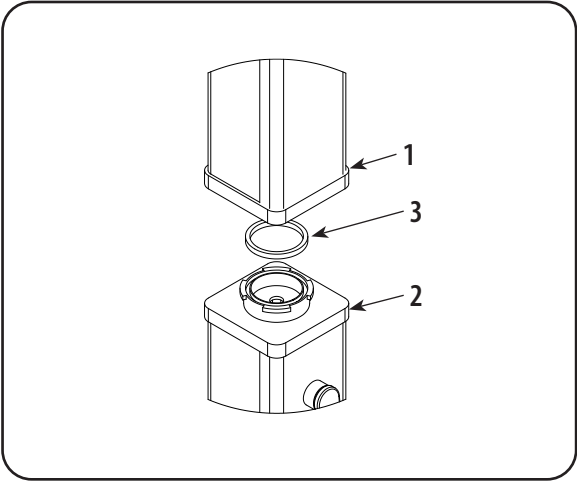

FIGURE 4

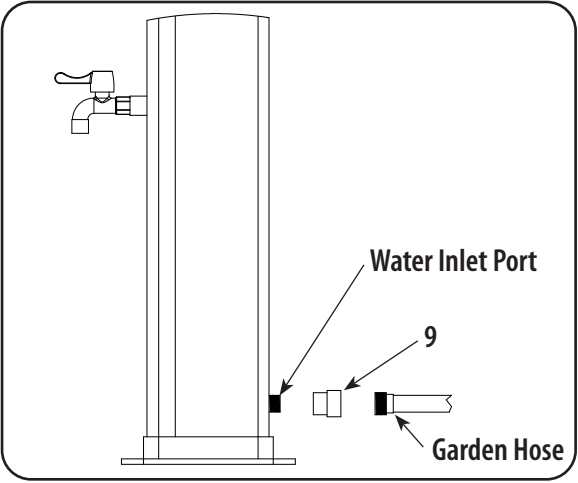

FIGURE 5

INITIAL SET UP OF THE SHOWER

- 1. Shower will take about 3 to 5 minutes to fill.
- 2. Lift temperature knob and rotate so that the temperature knob is in the full HOT position.
- 3. When water flows from shower head, turn temperature knob off. Turning the shower off allows the water to begin heating.
- 4. Shower is ready to absorb sunlight and heat your water. **NOTE:** Depending on available sunlight and outside temperature, it may take up to 2 hours or longer to fully heat the water. Using the shower too soon will yield less heated water. A recently used shower (that has not been emptied) will take less time as it will have retained some hot water.

USING THE SHOWER

WARNING

- **WATER TEMPERATURE IN SHOWER MAY REACH OVER 140°F (60°C)! WE RECOMMEND SETTING THE TEMPERATURE KNOB TO THE MIDDLE POSITION BETWEEN HOT AND COLD, THEN SETTING TO DESIRED TEMPERATURE. START THE SOLAR SHOWER WITH THE TEMPERATURE KNOB IN THE COLD POSITION TO AVOID INJURY.**
- **DO NOT LEAVE THE SHOWER FILLED WITH WATER IN FREEZING TEMPERATURES. THIS COULD DAMAGE THE SHOWER.**

- 1. Simply lift and turn the temperature knob to desired temperature and you are ready to enjoy your sun-warmed water!
NOTE: The faucet connected to garden hose must be turned on for the shower to run and then to refill the tank.
- 2. Turn water off at the faucet when done showering.

WARNING: IF SHOWER HAS NOT BEEN USED FOR MORE THAN THREE DAYS, WE RECOMMEND RUNNING THE SHOWER FOR 2 MINUTES TO REMOVE STAGNANT WATER. STAGNANT WATER IN WARM ENVIRONMENT CAN PROVIDE A GROWTH ENVIRONMENT FOR HAZARDOUS BACTERIA.

OFF SEASON DISASSEMBLY

- 1. Turn off and disconnect garden hose.
- 2. Lift and turn the temperature knob to the HOT position. This will allow for the water to drain from the solar shower assembly. Complete drainage of the the solar shower will take between 10-12 minutes.
- 3. Turn the upper shower tube COUNTERCLOCKWISE to unlock, and gently pull shower tubes apart.
NOTE: Some water may spill from the upper shower tube.
- 4. Unbolt the lower shower tube from where it is installed. Pour the remaining water from the lower shower tube.
- 5. Clean and dry all solar shower parts and components.
- 6. Store all solar shower parts and components in a dry location.

DO NOT USE SALT OR OTHER ANTI-FREEZING METHODS. THIS WILL DAMAGE THE PRODUCT AND VOID THE PRODUCT WARRANTY.

CARE AND MAINTENANCE

Wipe shower off after use.

WARNING: FOR YOUR SAFETY

THIS IS NOT a recreational device. DO NOT climb on, hang from solar shower or stand on base. Use only as intended. When not in use, store the solar shower in an area away from the play of children.

CAUTION: IMPORTANT SAFETY INFORMATION - KEEP SMALL PARTS, HARDWARE AND PLASTIC BAGS OUT OF THE REACH OF CHILDREN.

LIMITED WARRANTY STATEMENT

General Terms This Limited Warranty applies to the product enclosed (“the Product”) distributed by Great American Merchandise & Events, LLC (GAME), a Delaware Limited Liability Company, sold with this Limited Warranty Statement. This Limited Warranty is applicable in all countries. • GAME warrants that the Product you have purchased from GAME is free from defects in materials or workmanship under normal use during the warranty period. The warranty period starts on the date of purchase and continues for one (1) year. Your dated sales or delivery receipt, showing the date of purchase of the Product, is your proof of the purchase date. • During the warranty period, GAME will repair or replace any defective parts with new parts, or, at GAME's discretion, used parts that meet or exceed performance specifications for new parts. All parts removed under this warranty become the property of GAME. The replacement part takes on the warranty status of the removed part or product. • This Limited Warranty does not apply to expendable parts. This Limited Warranty does not extend to any product from which the serial number has been removed or that has been damaged or rendered defective (a) as a result of accident, misuse, abuse or other external causes; (b) by operation outside the usage parameters stated in the Instruction Sheet that shipped with the Product; (c) by the use of parts not manufactured or sold by GAME; or (d) by modification or service by anyone other than GAME.

Limitation of Liability GAME is not liable for any damages caused by the Product or the failure of the Product to perform, including any direct or indirect damages for personal injury, lost profits, lost savings, incidental damages, consequential damages, or any other pecuniary loss arising out of the use or inability to use the Product. GAME is not liable for any claim made by a third party or made by you for a third party. • This limitation applies whether damages are sought, or a claim made, under this Limited Warranty or as a tort claim (including negligence and strict product liability), a contract claim, or any other claim. This limitation cannot be waived or amended by any person. This limitation of liability will be effective even if you have advised GAME or an authorized representative of GAME of the possibility of any such damages.

EXCEPT AS EXPRESSLY SET FORTH IN THIS LIMITED WARRANTY, GAME MAKES NO OTHER WARRANTIES, EXPRESS OR IMPLIED, INCLUDING ANY IMPLIED WARRANTIES OF MERCHANTABILITY AND FITNESS FOR A PARTICULAR PURPOSE. GAME EXPRESSLY DISCLAIMS ALL WARRANTIES NOT STATED IN THIS LIMITED WARRANTY. ANY IMPLIED WARRANTIES THAT MAY BE IMPOSED BY LAW ARE LIMITED TO THE TERMS OF THIS WORLDWIDE LIMITED WARRANTY STATEMENT.

To obtain warranty service, please call, write, or email us directly at the address shown below.

This warranty gives you specific legal rights, and you may also have other rights which vary from state to state.



GAME®, LLC.
17787 N Perimeter Dr. Suites A109-111
Scottsdale, AZ 85255 U.S.A.

tel: 888.339.2546
email: products@game-group.com
www.game-group.com