

Instruction manual

Step 1:
Remove the nut from the monitor

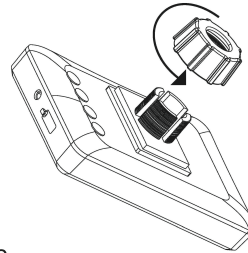

Step 2:
Assemble the nut into the base, tighten the nut between monitor and base

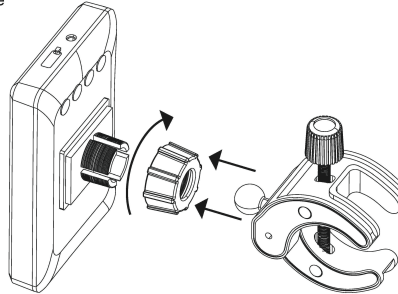

Step 3:
1. Adjust the screws and install the monitor on the handlebar
2. Tighten the screw to stabilize the monitor

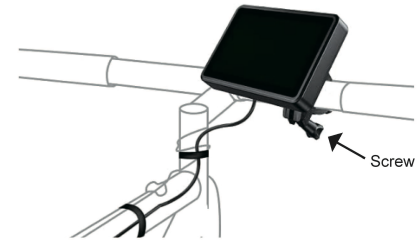

Step 4:
Camera Install:



1. Loosen the camera base nut
2. Fix the camera on the seat bar
3. Tighten the camera base nut



- Step 5:**
Place the cable in place
1. Spread the cable along the frame of the bicycle, see photo
 2. Use the velcro to fix the cable on the frame
 3. Plug the 3.5MM cable into the monitor

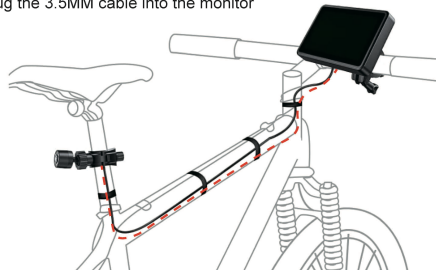

Final Look

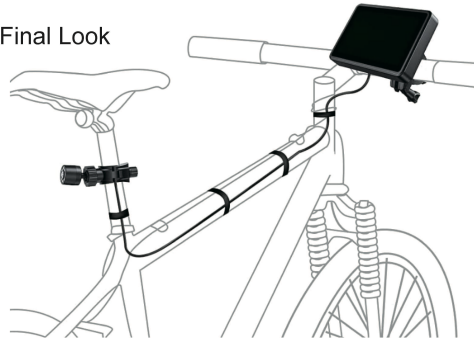

BIKE REAR VIEW CAMERA

Screen Size:	4.3" AHD 1080P
Aspect Ratio:	16:9
Resolution:	IPS800(H)*480(V)
Input Voltage:	5V
Brightness:	1000cd/m2
Battery Capacity:	5000mAh
Solutions:	1/2.9" 2053
Image Format:	AHD
Effective Pixel:	1920H*1080V
Angle:	130°
Power supply:	5V
Waterproof Grade:	IP68

PARTS



- 1 Monitor
- 2 Nut
- 3 Monitor base
- 4 camera signal cable
- 5 camera base
- 6 Velcro tape
- 7 Storage triangle bag