

# SHARPER IMAGE®

MOTION ACTIVATED PLACE ANYWHERE LIGHTS BY SHARPER IMAGE

Item No. 208687

User Guide



Thank you for purchasing the Motion Activated Place Anywhere Lights by Sharper Image. Please take a moment to read this guide and store it for future reference.

## INTRODUCTION

The Motion Activated Place Anywhere Lights by Sharper Image give you convenient lighting wherever you need it. These sleek, modern lights install with adhesive tape, so you can mount them anywhere.

## FEATURES

- Motion-activated from 10 feet
- 120-degree angle of detection
- Upward-facing motion sensor prevents unnecessary activations
- Provides 15 lumens of warm, white light
- Light covers 10 square feet
- Auto shutoff prolongs battery life
- Lightweight, less than 2 oz. each
- A set of batteries lasts about 1 year [at 8 activations per night]

## DESCRIPTION OF PARTS

1. Motion sensor

2. LED light

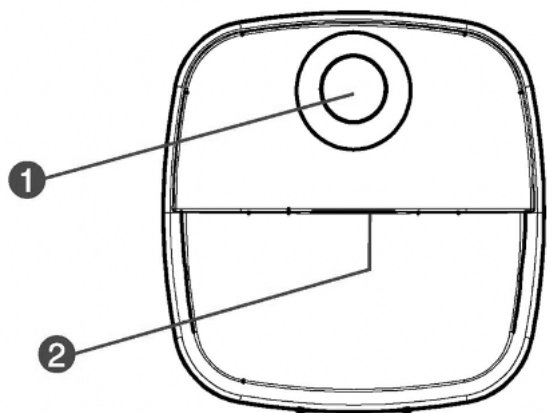

## INSTALLING THE BATTERIES

1. Slide down to remove the mounting bracket on the back of the device.

2. Insert three AAA batteries. Make sure to follow the correct polarity direction as marked inside the battery compartment.

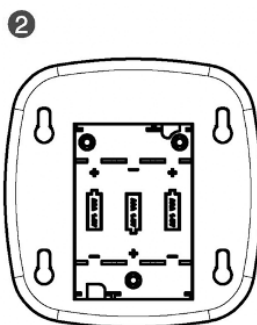
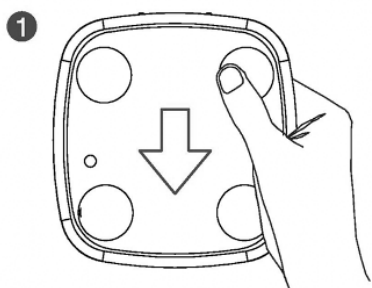

3. Replace the mounting bracket.

## INSTALLATION OPTION A: ADHESIVE

1. Remove the mounting bracket as shown above. Then, remove the protective film on the back of the bracket.

2. Stick the bracket onto the wall. Make sure the arrow on the bracket is pointing up.

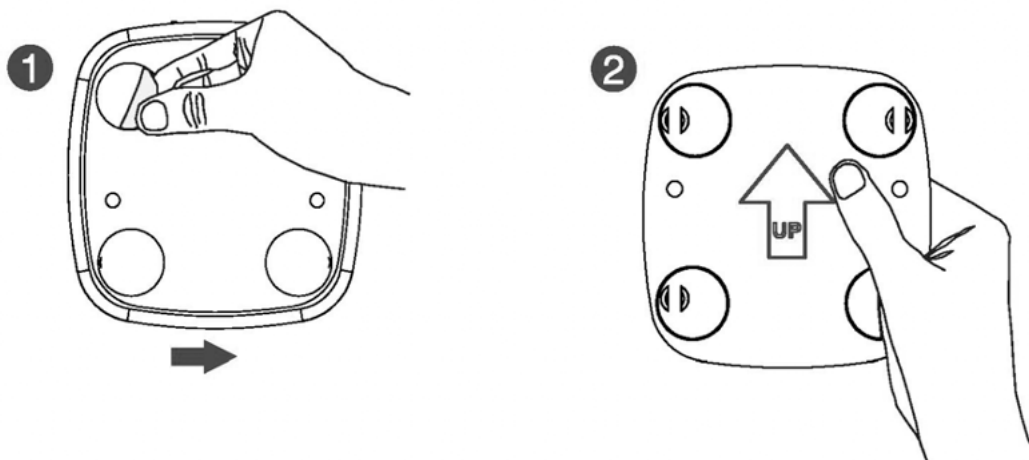

3. Align the holes on the back of the device with the pins on the bracket. Slide down to mount the device.

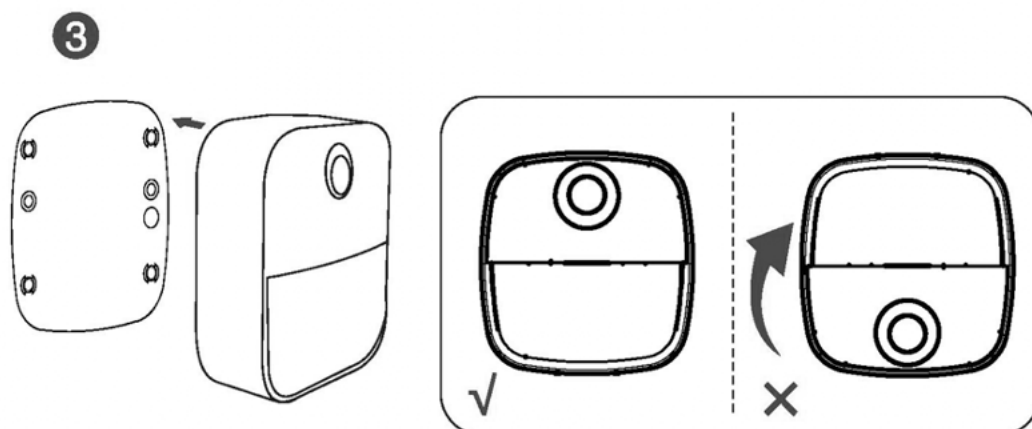

## INSTALLATION OPTION B: SCREWS

**NOTE:** Mounting hardware is not included.

1. Measure a distance of 1.97" [50mm] between two points for wall anchors. Use a pen to mark the drill points.
2. Use a drill bit to drill two 0.9" [23mm] deep holes and fully insert the wall anchors into the holes.

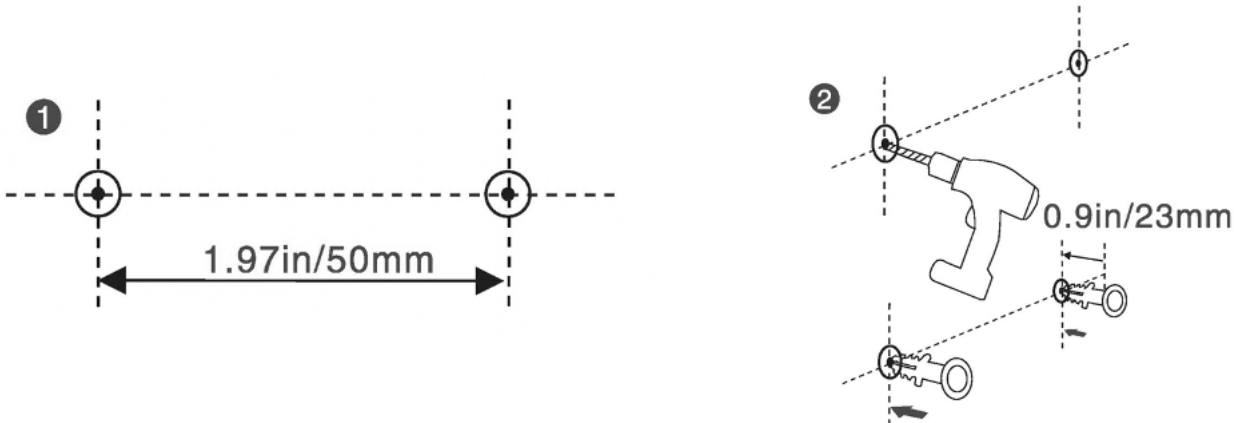

3. Align the mounting bracket with the wall anchors and hold against the wall. Insert the screws through the fixing holes and screw firmly into the wall anchors. **NOTE:** Make sure the arrow on the mounting bracket is pointing up when installing.
4. Align the mounting holes on the back of device with the pins on the mounting bracket. Slide down to secure the device.

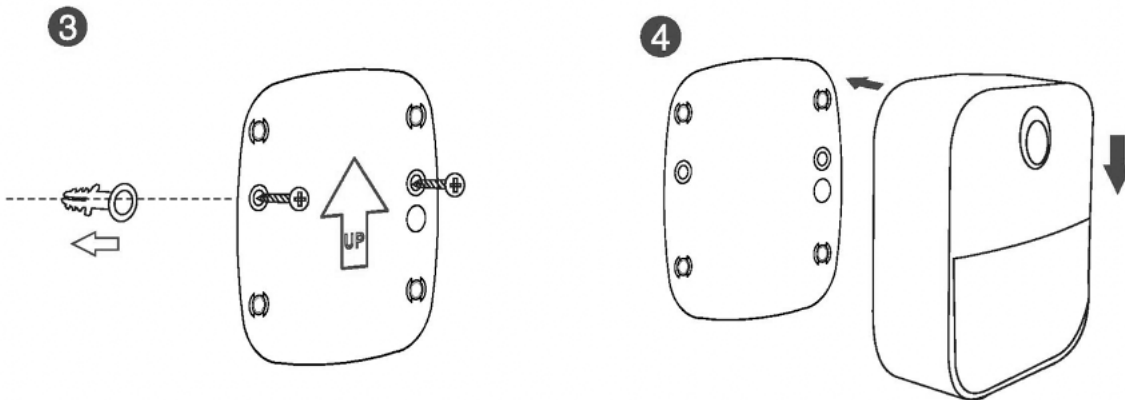

## INSTALLATION TIPS

This device will activate IF it detects motion **AND** the lighting conditions are dark. The light will turn off automatically when motion is not detected for 20 seconds.

1. This device will **NOT** turn on in bright light conditions.
2. This device will **NOT** activate if it is out of range of the motion sensor [approx. 10 ft. unobstructed].

## SAFETY INSTRUCTIONS

- This device is for indoor use only.
- This device should not be exposed to dripping or splashing water.
- Do not mix old and new batteries. Do not mix different types of batteries.
- Do not attempt to open or repair this device. There are no user-serviceable parts.
- Do not install near heat sources.
- Do not use metal objects to connect the terminals of the battery.
- Recycle or dispose of used batteries in accordance with local laws.

## TROUBLESHOOTING

Light does not turn on.	<ul style="list-style-type: none"><li>- Device is installed in an area with too much light. Move to an area with less light.</li><li>- Device is installed out of range. Move device closer to the area you wish to illuminate. Make sure there are no obstructions blocking the motion sensor (trees, bushes, furniture, etc).</li><li>- Batteries are out of power. Please replace batteries.</li></ul>
Light is dim.	Batteries are low on power. Please replace batteries.
Light does not turn off in bright areas.	When the motion sensor activates the light and then <b>ANOTHER</b> bright light is turned on, the device may remain lit. The device will turn off automatically when it does not detect further motion for 20 seconds.

## SPECIFICATIONS

Light Wattage	0.4W
Battery Power	3 x AAA [not included]
Dimensions	2.9" x 2.8" x 0.8"
Weight	1.5 oz.

## WARRANTY AND CUSTOMER SERVICE

This item from SharperImage.com includes a 1-year limited replacement warranty. If you have any questions not covered in this guide, please call our Customer Service department at 1 (877) 210-3449. Customer Service agents are available Monday through Friday, 9:00 a.m. to 6:00 p.m. ET

**SHARPER IMAGE®**

The SHARPER IMAGE® name and logo are registered trademarks.

©Sharper Image. All Rights Reserved.