



Wireless Internet Radio

User's Manual



For ongoing product improvement, this manual is subject to modification without prior notice.

MODEL: KWS433+

User Notice

This product has met electronic emissions standards required. It can be used safely at home.



Contents

Before Operation

| | |
|----------------------|---|
| Product Introduction | 2 |
| Safety Precautions | 3 |
| Product Overview | 5 |

Basic Operation

| | |
|-------------------------------------|----|
| Radio and TV Interference Statement | 6 |
| Turn on the device | 6 |
| Turn off the device | 7 |
| Virtual buttons bar | 8 |
| Network | 9 |
| Display | 11 |

Advanced Operation

| | |
|----------------------|----|
| Streaming Music | 13 |
| Internet Radio | 14 |
| Audio Books | 15 |
| Weather | 16 |
| Alarm | 17 |
| File Manager | 18 |
| System Upgrade | 19 |
| How to Connect to PC | 20 |

Customer Management

| | |
|---------|----|
| FAQS | 22 |
| Support | 22 |

PRODUCT INTRODUCTION

Features

- Stream more than 18,000 radio stations
- Preloaded with Pandora, TuneIn, iHeartRadio, Spotify, audiobook.com...
- Backup list to add more music, radio and audio book apps
- Weather report
- Clock / Alarm
- 2 x 3W stereo speakers + 5W subwoofer speaker
- Elegant appearance
- 16GB internal memory
- Touch screen operation with shortcut keys
- Support all popular audio formats
- USB port to connect to your PC and external storage
- Wireless link to internet automatically

Specifications

- | | |
|--------------------------|---------------------------------|
| • 2.1 sound channel: | 2 channel stereo + Super bass |
| • Display: | 4.3inch capacitive touch screen |
| • Resolution: | 272x480 pixels |
| • Flash memory: | 16GB |
| • Wireless: | 802.11b/g/n |
| • Earphone jack: | 3.5mm |
| • USB port: | Micro USB port |
| • Speaker power output : | 2*3W +1*5W (Total 11W) |
| • Dimensions: | 10.16" x 5.16" x 2.76" |

Package Contents

- Wireless Internet Radio
- Quick start Guide
- AC adaptor
- Warranty card

SAFETY PRECAUTIONS

Please read the following guidelines carefully to ensure user safety.

Power Precautions

⚠ WARNING: indicates information that, if neglected, could result in serious injury and/or death to the user.

⚠ CAUTION: indicates information that, if neglected, could result injury to the user and/or material damage.

01. Use only the authorized power supply product. Failure to do so could result in product malfunction.



02. When connecting the power source, make sure that your hands are free of moisture. Failure to do so could result in electrical shock.



03. Make sure that the power supply is firmly plugged in and not loose. Failure to do so could result in electrical shock.

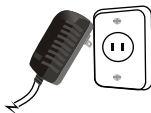

04. Do not let the power cord get overly entangled and do not place any heavy objects on the cord. Failure to do so could result in electrical shock.

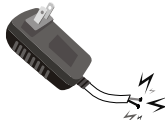

05. Do not connect the power supply to an electrical power strip with other various connections. Failure to do so could result in fire.

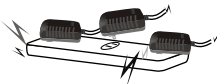

06. Disconnect the power supply during inclement weather conditions that include thunder and lightning. Failure to do so could result in fire.



SAFETY PRECAUTIONS

Please read the following guidelines carefully to ensure user safety and avoid malfunction.

Product Related Precautions

01. Dropping the product or subjecting it to a significant impact can cause critical damage.



02. Spilling water or any other liquid on the product can cause critical damage.



03. Striking or scratching the LCD screen may cause critical damage.

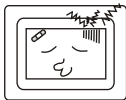

04. When cleaning the LCD screen, turn off the power and wipe it gently with a soft cloth.

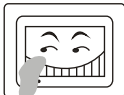

05. Do not subject the product to severe humidity and/or heat.

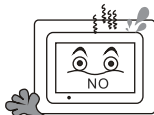

06. Make sure to power off the unit before disconnecting the power supply.

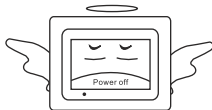

PRODUCT OVERVIEW

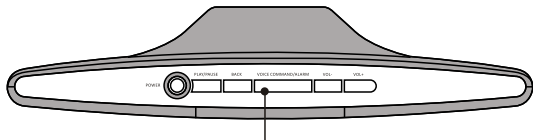

Push Button Controls

Power, Play/Pause, Back,
Voice Command/Alarm, Volume-, Volume+

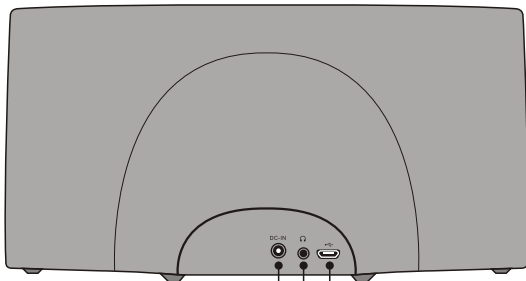

Power Adapter Port

3.5mm Headphone Jack

Micro USB Port

Connect a PC or MAC to transfer digital files to the built-in 16GB internal memory

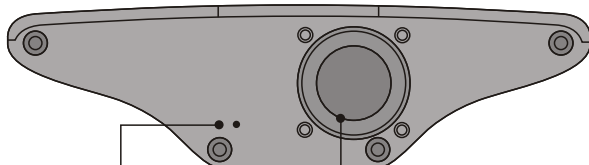

Reset

5W Subwoofer

RADIO AND TV INTERFERENCE STATEMENT

WARNING!!! This equipment has been tested and found to comply with the limits of a Class B digital device, pursuant to part 15 of the FCC rules. These limits are designed to provide reasonable protection against harmful interference in a residential installation.

This equipment generates, uses and can radiate radio frequency energy and, if not installed and used in accordance with the instruction, may cause harmful interference to radio communications. However, there is no guarantee does cause interference will not occur in a particular installation. If this equipment does cause harmful interference to radio or television reception, which can be determined by turning the equipment off and on, the user is encouraged to try to correct the interference by whatever measures may be required to correct the interference.

TURN ON THE DEVICE

Hold on the power button, the booting logo will display on the screen, after several seconds, the main menu will display on the screen.

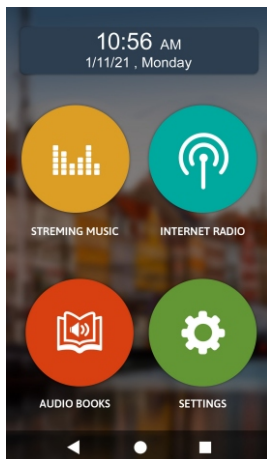

| | |
Back Home Opened app list

TURN OFF THE DEVICE

Hold on the power button, the below prompt box will display on the screen, then touch **"Power off"** to turn off the device.

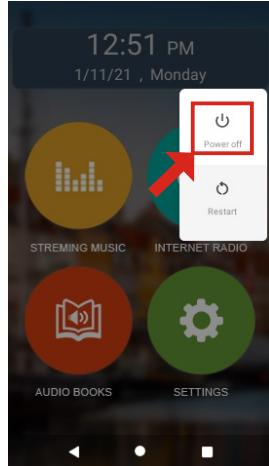

VIRTUAL BUTTONS BAR

At the bottom of the screen, swipe your finger up to reveal a virtual button bar.

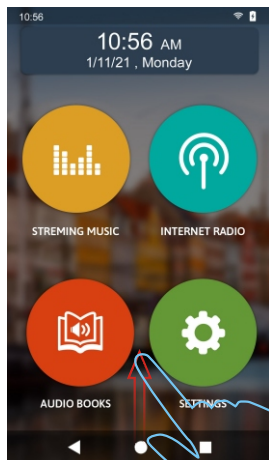
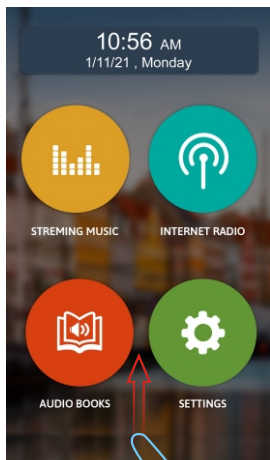

NETWORK & INTERNET

Your device support Wi-Fi 802.11b/g/n. Use Wi-Fi settings to manage your device's Wi-Fi connections.

Turning Wi-Fi on or off

Turn your device's Wi-Fi service on or off. When you turn Wi-Fi service on, Your device automatically searches for available, in range Wireless access Points(WAPs).

1. From Home screen, Touch **"SETTINGS"** → **"SETTINGS"**→ **"Network & internet"**.
2. Turn on the Wi-Fi by slide the icon(●) to right side, and slide to left side to turn off the Wi-Fi .

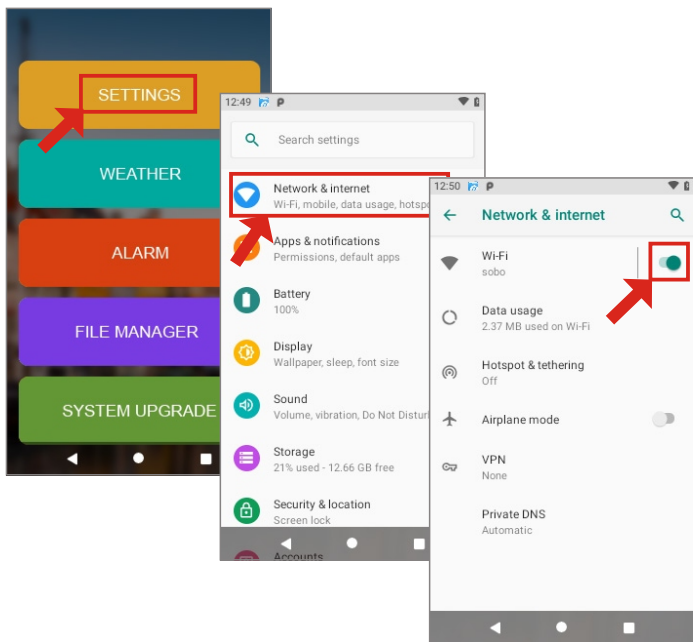

NETWORK & INTERNET

Scan

Your device scans for available Wi-Fi networks and displays the names of those it finds. Secured networks are indicated with a Lock icon, if your device finds a network that you connected to previously, it connects to it, if not:

1. Touch the Network you want to connect to.
2. Use the keyboard to enter the Password.
3. Touch OK button(✓).

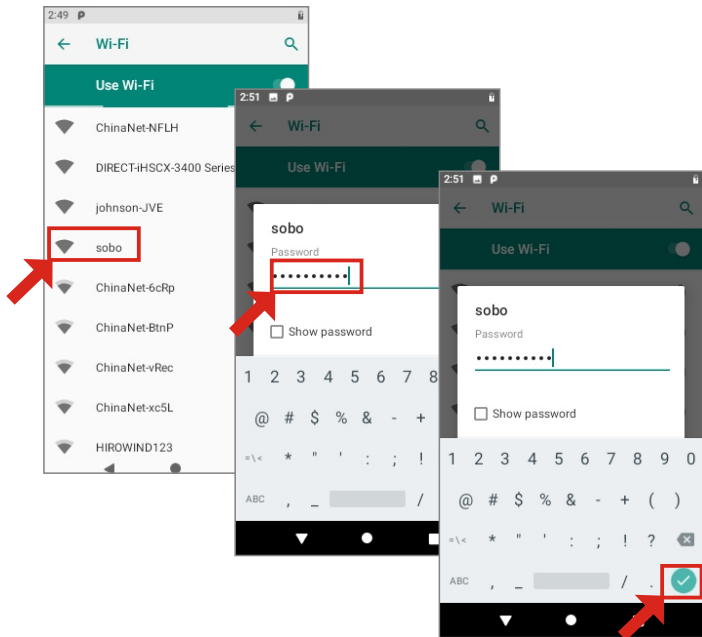

DISPLAY

Brightness

Set the default screen brightness.

1. From Home screen, touch **"SETTINGS"** → **"SETTINGS"** → **"Display"** → **"Brightness Level"**.
2. Touch and drag the slider to set the brightness.

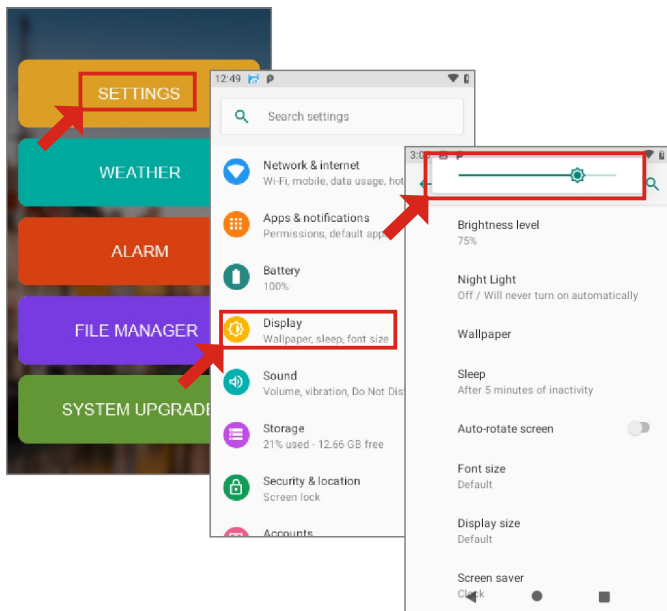

DISPLAY

Sleep

Set the length of delay between the last key press or screen touch and the automatic screen timeout (dim and lock).

1. From Home screen, touch **"SETTINGS"** → **"SETTINGS"** → **"Display"** → **"Sleep"**.
2. Select the desired setting.

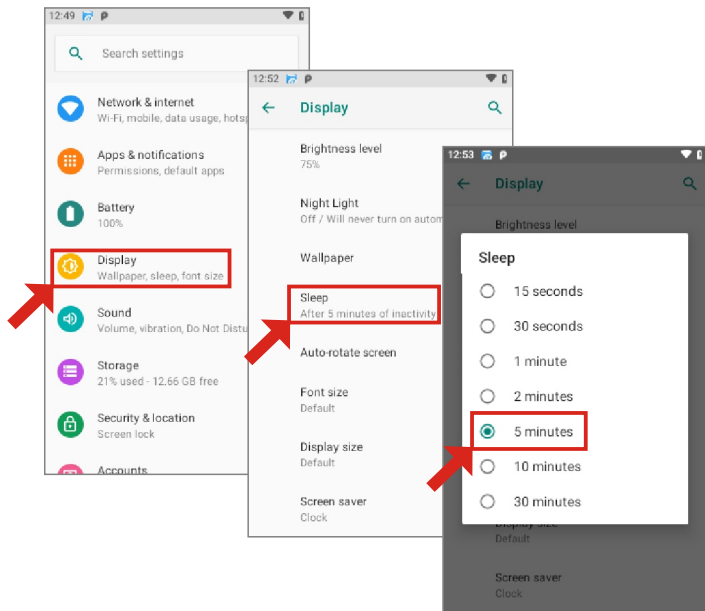

STREAMING MUSIC

If you are using your device for the first time, please follow below instructions how to install the music app onto the device. After the initial setup, you may just touch the music app on the display to stream music.

1. From Home screen, Touch **"STREAMING MUSIC"**.
2. Touch **"+"** to see the supported apps.
3. Touch the app that you like to add to your device.
4. Touch **"Yes"** in the pop up window.
5. Touch **"Yes"** to confirm the download (please do not change the screen during download).
6. Touch **"Yes"** to start the installation.
7. Touch **"INSTALL"** to install the app.
8. Touch **"Open"** to start using the application or **"Done"** to go back to the back list menu.

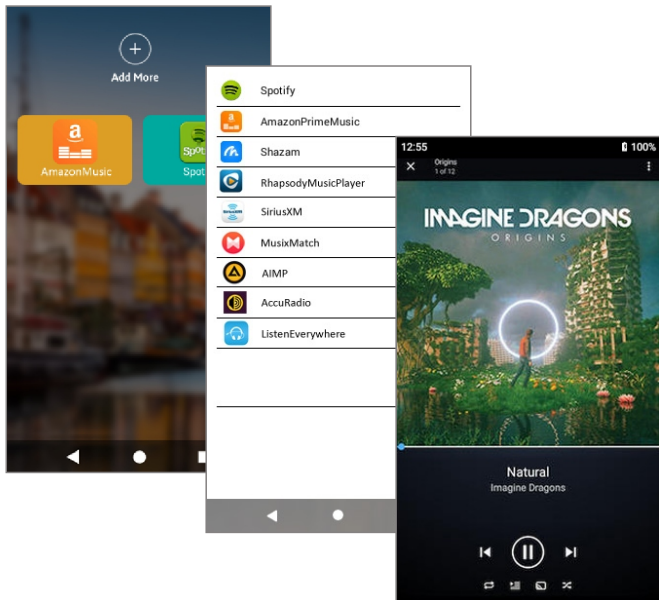

INTERNET RADIO

If you are using your device for the first time, please follow below instructions how to install the radio app onto the device. After the initial setup, you may just touch the radio app on the display to listen to the radio.

1. From Home screen, Touch **"INTERNET RADIO"**.
2. Touch **"+"** to see the supported apps.
3. Touch the app that you like to add to your device.
4. Touch **"Yes"** in the pop up window.
5. Touch **"Yes"** to confirm the download (please do not change the screen during download).
6. Touch **"Yes"** to start the installation.
7. Touch **"INSTALL"** to install the app.
8. Touch **"Open"** to start using the application or **"Done"** to go back to the back list menu.

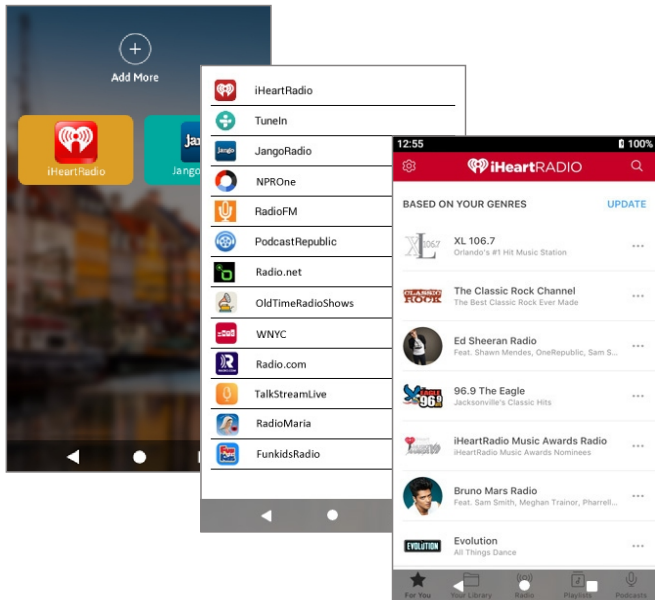

AUDIO BOOKS

If you are using your device for the first time, please follow below instructions how to install the audio book app onto the device. After the initial setup, you may just touch the audio book app on the display to listen to the audio book.

1. From Home screen, Touch **"AUDIO BOOKS"**.
2. Touch **"+"** to see the supported apps.
3. Touch the app that you like to add to your device.
4. Touch **"Yes"** in the pop up window.
5. Touch **"Yes"** to confirm the download (please do not change the screen during download)
6. Touch **"Yes"** to start the installation.
7. Touch **"INSTALL"** to install the app.
8. Touch **"Open"** to start using the application or **"Done"** to go back to the back list menu.

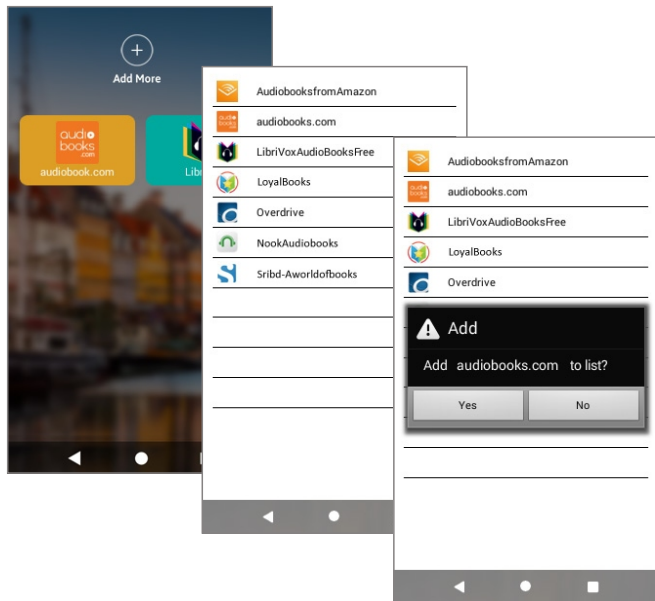

WEATHER

If you are using the your device for the first time, please follow below instruction on how to set the weather of the city to be displayed.

1. From Home screen, touch **"SETTINGS"** then touch **"WEATHER"**.
2. Touch **"I Agree"**.
3. Touch **"next"** → **"next"**, and touch **"Do it"**, then type the city name.

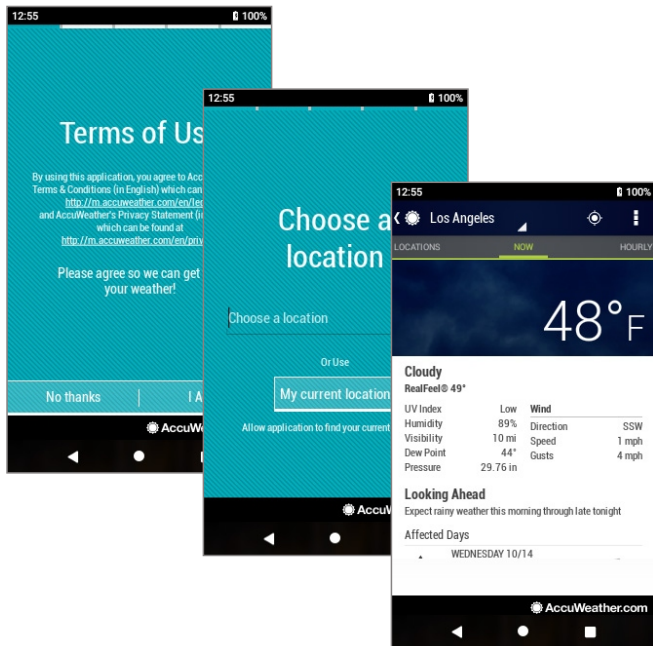

ALARM

If you are using the your device for the first time, please follow below instructions on how to set alarms on the device.

1. From home scree, press the **"Voice command/Alarm"** button on the top of the device, or touch **"SETTINGS"** then touch **"ALARM"** on the screen, to go into ALARM setting.
2. Touch **"+"** to create an alarm.
3. Select time to set the desired time and touch **"SAVE"**.

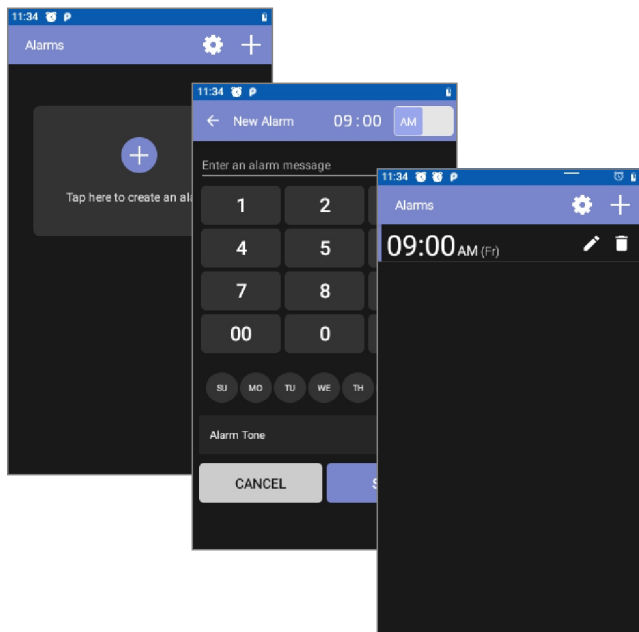

FILE MANAGER

From Home screen, touch **"SETTINGS"**, then touch **"FILE MANAGER"**.

Touch the different tabs on the screen to select different storage location & storage contents.

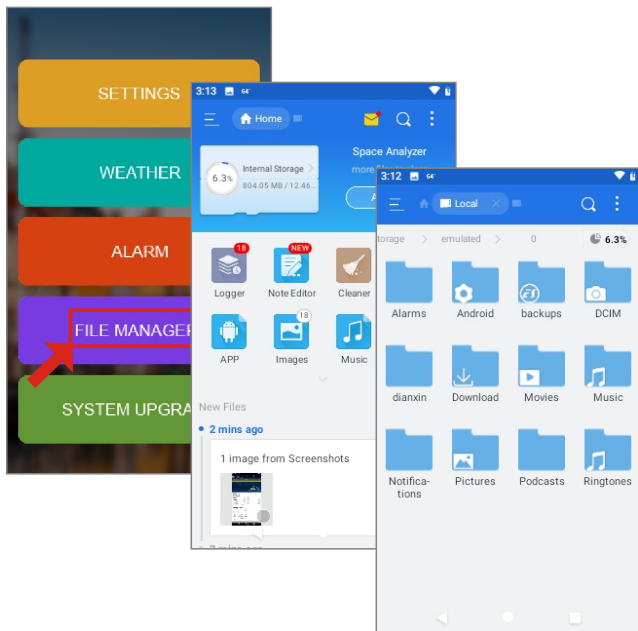

SYSTEM UPGRADE

From Home screen, touch **"SETTINGS"**, then touch **"SYSTEM UPGRADE"**.

If there is available upgrade, you should follow the screen prompt to download and install the upgrade, usually will be followed by a system auto reboot.

If there is no available upgrade, the message "Your version is the latest version" will appear on the screen.

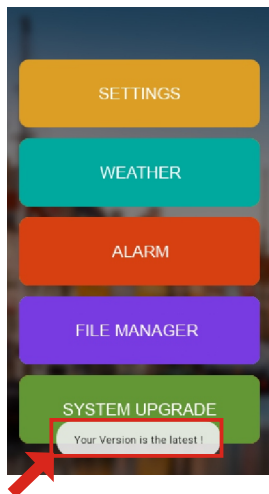
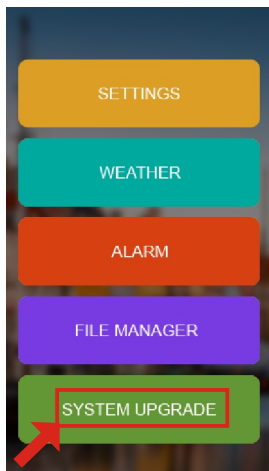

HOW TO CONNECT TO PC

1. Find a micro USB cable, connect one end to your PC, and the other end to your device USB port.



2. From the home screen, touch the top of the screen, hold and slide down to draw up the status bar.

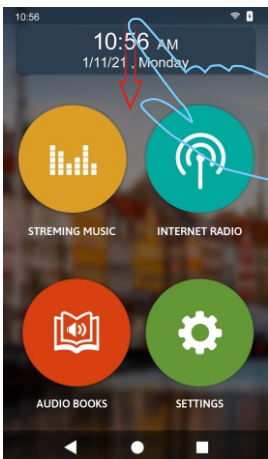
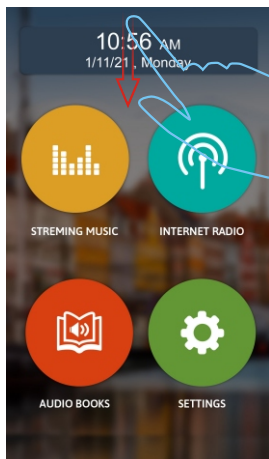

HOW TO CONNECT TO PC

3. Select **"USB debugging connected"**, then select **"File Transfer"**, then you can copy the files from your PC to the device.
4. Select **"No data transfer"** to disconnect to PC.

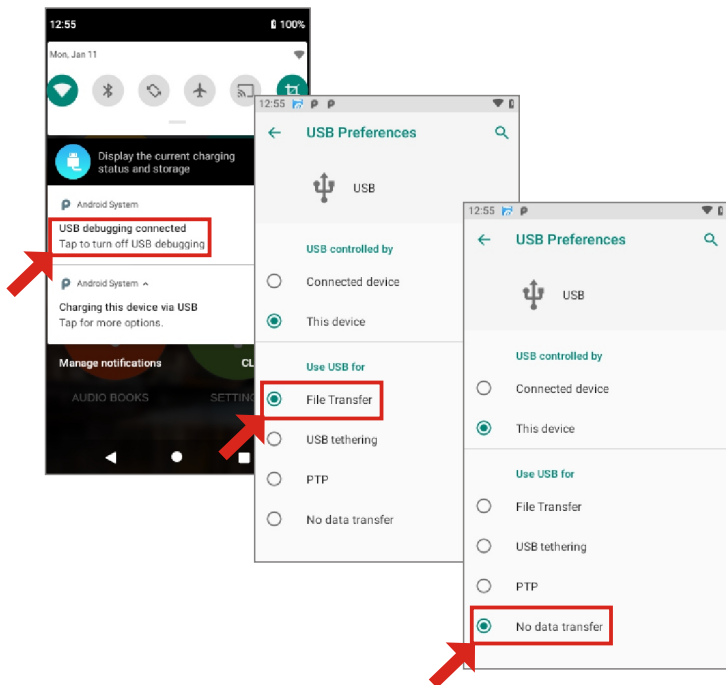

FAQS:

Q : Why can't I link to Wi-Fi?

A: Please check if you have turned on the Frame's Wi-Fi.

Go to→ Setting→ Wireless & Networks→ Slide "Off" to "On"

Please check if you have input the right password of Wi-Fi router. For more Wi-Fi related questions, please go to www.sungale.com and find Support Wi-Fi related FAQ.

SUPPORT

1. Visit the support site.

- For manual download, FAQs and more supports: www.sungale.com

2. Contact Sungale Support team

- Toll free number in the USA: 800-473-5156
- Service email: service@sungale.com

NOTE

In order to ease users' selection, other logos and/or trademarks may appear on this product. All other logos and/or trademarks are the property of their respective owners.

• FCC Part 15.19

This device complies with Part 15 of the FCC Rules .Operation is subject to the following two conditions: (1) this device may not cause harmful interference , and (2) this device must accept any interference received ,including interference that may cause undesired operation .

• FCC part 15.21

Warning: Changes or modifications to this unit not expressly approved by the party responsible for compliance could void the user's authority to operate the equipment.

• FCC part 15.105

Note : This equipment has been tested and found to comply with the limits for a Class B digital device ,pursuant to Part 15 of the FCC Rules, These limits are designed to provide reasonable protection against harmful interference in a residential installation .This equipment generates, uses, and can radiate radio frequency energy and ,if not installed and used in accordance with the instructions, may cause harmful interference will not occur in a particular installation .If this equipment does cause harmful interference to radio or television reception ,which can be determined by turning the equipment off and on ,the user is encouraged to correct the interference by one or more of the following measures:

- Reorient or relocate the receiving antenna.
- Increase the separation between the equipment and receiver.
- Connect the equipment into an outlet on circuit different from that to which the receiver is connected.
- Consult the dealer or an experienced radio TV technician for help.