



ANIMAT3D

IMPORTANT: JABBERIN' JACK MAKES SILENT FACES, WHEN THERE IS NO AUDIO PLEASE NOTE THAT THE UNIT IS NOT BROKEN.

1. Power adapter not included, all USB power adapters are compatible (ie: mobile phone charger).
2. Please do not open Jabberin' Jack in order to avoid damaging the unit.
3. Maintain adequate ventilation, do not cover the Jabberin' Jack with objects such as cloth or other materials.
4. Please keep Jabberin' Jack away from direct rain, water or snow, covered porch outdoor setting is OK.
5. Please disconnect/remove power source (USB cable) when not using for extended periods of time.
6. Please do not disconnect the USB cable when Jabberin' Jack is ON. Switch OFF and then disconnect the USB cable.
7. Do NOT drop or shake the unit.
8. Please ensure that Jabberin' Jack is placed in temperatures within 20°F - 100°F
9. Recommend to connect Jabberin Jack with USB and power adaptor for prolonged use. Powered by AA batteries only last for a few hours.

PARTS:

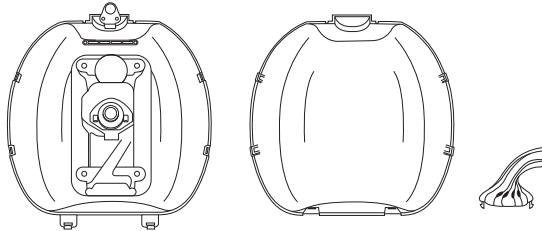

ASSEMBLY:

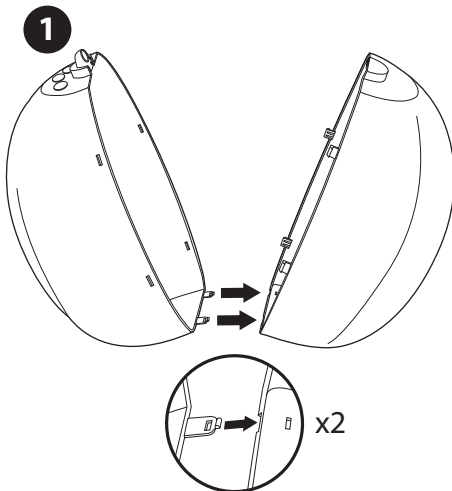

Insert the 2 hinged tabs on the bottom of the back half of pumpkin shell into the bottom of the front half of pumpkin shell

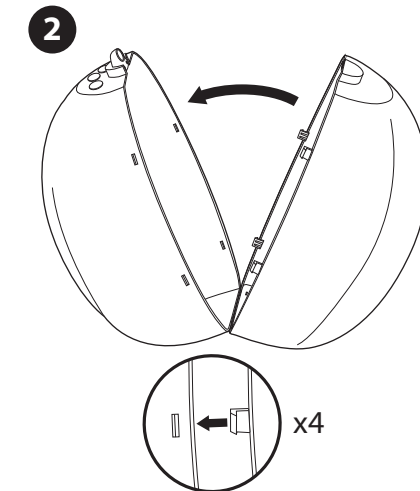

Fold pumpkin halves together locking the 4 tabs on sides of the pumpkin shell securely in place.

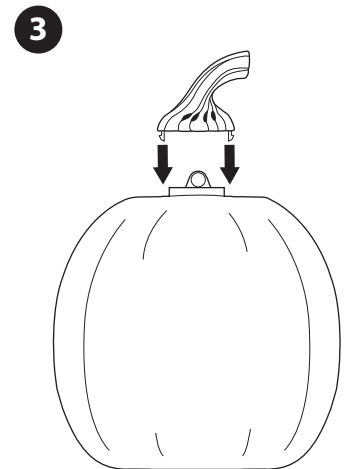

Insert pumpkin stem in place over the motion sensor eye. Ensure the holes in the stem align in front of the sensor eye.

BATTERY:

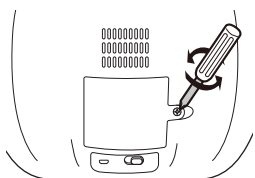

Unscrew battery compartment door (SCREWDRIVER NOT INCLUDED)

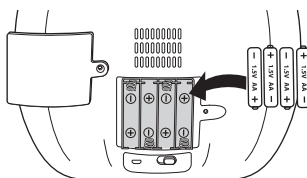

Install 4 AA 1.5V batteries (NOT INCLUDED)

USB:

Attach USB cable (INCLUDED)

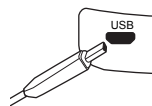

Use any USB power adapter (NOT INCLUDED)



Plug USB power adapter (NOT INCLUDED)

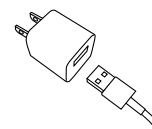

START:

Switch power button

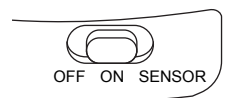

Adjust controls



STILL MODE:

Give Jabberin' Jack a decorative look by entering into still mode. Jabberin' Jack will not run any animation but instead will maintain a still face. Press and hold the + & - buttons simultaneously for 3 seconds to enter into still mode. To exit press any button to resume animations.

MOTION SENSOR MODE:

Set the main switch to "SENSOR" mode. Jabberin Jack will play a random video clip (4-25 seconds) whenever motion is detected within 6 feet in front of the stem.

TO EXIT MOTION SENSOR MODE:

If switching from "SENSOR" to "ON", the unit will not exit SENSOR mode. Switch to "OFF" then to "ON"

PLAY MODE:

Move the main switch to "ON", video is played in loop. Skip to play next track. Vol-/ Vol + to adjust sound level.

*Note: Video will continue on a loop until turned off manually, there is no timer on Jabberin' Jack.

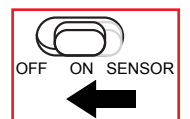
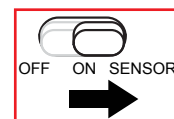

MINDSCOPE
PRODUCTS
PO BOX 9525
GLENDALE, CA 91226

Connect with us:



pinterest.com/mindscope



facebook.com/mindscopeproducts

YouTube

youtube.com/mindscope



Instagram.com/mindscopeproducts