

SHARPER IMAGE®

BACON EXPRESS TOASTER

Item No. 207656

User Guide



Thank you for purchasing the Sharper Image Bacon Express Toaster. Please take a moment to read this guide and store it for future reference.

FEATURES

- Cooks bacon vertically to drain away fat
- Converts to a non-stick griddle for pancakes, eggs, sausage, etc.
- Indicator lights tell you when it's ready to cook
- Cool-touch handles keep hands safe
- Removable drip tray for easy cleanup
- Slim, folding design for efficient storage

IDENTIFICATION OF PARTS

- 01 Open Button
- 02 Cool Touch Handle
- 03 Doors
- 04 Front Base Cover
- 05 Front Base
- 06 Side Panel
- 07 Decorative Strip
- 08 Cool Touch Handle
- 09 Front Base Cover
- 10 Indicator Light
- 11 Feet
- 12 Center Plate Handles
- 13 Back Base Cover
- 14 Griddle Plates
- 15 Drainage Grate
- 16 Hook
- 17 Leg Supports
- 18 Center Plate
- 19 Clip
- 20 Drip Tray

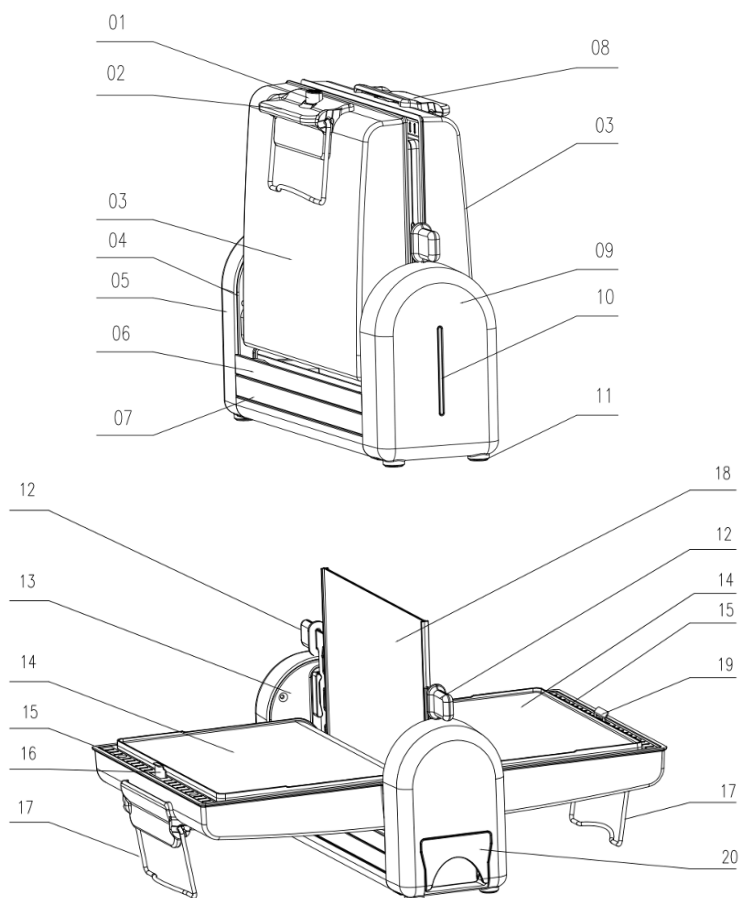

OPERATING THE BACON EXPRESS TOASTER

BEFORE USE

- Wash the Griddle Plates, Center Plate and Drip Tray in warm, soapy water and dry thoroughly.
- Wipe the main unit and exterior of the Doors with a slightly damp, non-abrasive cloth.
- Once clean, replace the Center Plate and Drip Tray.
- Place the Bacon Express Toaster on a flat, stable surface, away from water.
- While in the closed position, plug the power cord into an AC outlet. To indicate power, the Indicator Light will illuminate RED and BLUE.
- Allow the unit to preheat. When preheating is complete, the BLUE half of the Indicator Light will darken.

NOTE: *A small amount of smoking is normal during the first use.*

COOKING BACON

- Make sure the Center Plate and Drip Tray are properly in place.
- While in the closed position, plug the power cord into an AC outlet. To indicate power, the Indicator Light will illuminate RED and BLUE.
- Allow the unit to preheat. When preheating is complete, the BLUE half of the Indicator Light will darken.

NOTE: *A small amount of smoking is normal during the first use.*

- Carefully open the Doors of the unit using the Open Button and Cool-Touch Handles. Be sure the Doors are resting on the Leg Supports to ensure stability. **CAUTION:** *Doors will be HOT!*
- Ensure fingers and hands do not touch the Doors. If needed, use oven mitts to open Doors.
- Drape strips of bacon, evenly spaced, over the Center Plate [5 or 6 strips]. The maximum number of bacon strips may vary based on the thickness and width of each strip. Do not overlap bacon strips.

CAUTION: *DO NOT put bacon in this appliance without the Center Plate in place.*

- The Doors must be closed in order to cook bacon. Use the Cool-Touch Handles to close the Doors. **NOTE:** *A small gap in the Doors is both normal and necessary, as it allows steam from the bacon to vent while cooking.*
- Allow bacon to cook. Bacon will begin to cook in 4 minutes. Frequently check the doneness of bacon so it does not overcook.

CAUTION: *Steam is generated during use that could cause burns or other injury. Stay clear of the steam when opening the Doors.*

- When bacon is done to your liking, open the Doors of unit and use tongs or a fork to carefully remove bacon from the Center Plate. Be sure the Doors are resting on the Leg Supports to ensure stability.

NOTE: *It is recommended that you use plastic or wooden utensils when removing bacon. Over time, metal utensils may damage the non-stick cooking surfaces of the Center Plate.*

- Before cooking more bacon, check the Drip Tray to ensure it does not need to be emptied. **NOTE:** *Avoid grease spills by always checking the Drip Tray before moving the unit. If the Drip Tray is full, properly dispose of grease prior to moving the unit.*
- When you are finished cooking, unplug the power cord from the AC outlet. Allow the appliance to cool completely before cleaning.

USING THE GRIDDLE

- Remove the Center Plate [using the Center Plate Handles] to convert the appliance into a griddle.
- While in the closed position, plug in the Bacon Express Toaster and preheat as described above.
- When preheating is complete, the BLUE half of the Indicator Light will darken.
- Carefully pull open the Doors of the unit using the Open Button and Cool-Touch Handles. Be sure the Doors are resting on the Leg Supports to ensure stability. **CAUTION:** *Doors will be HOT!*
- Ensure fingers and hands do not touch the doors. If needed, use oven mitts to open Doors.
- Apply cooking spray to the Griddle Plates, then begin cooking your foods. Cooking time will vary depending on the food[s] being made.

CAUTION: *Cooking surfaces will be HOT. Wear oven mitts to prevent burns.*

- When you are finished, unplug the power cord from the AC outlet. Allow the appliance to cool completely before cleaning.

NOTE: *Avoid grease spills by always checking the Drip Tray before moving the unit. If the Drip Tray is full, properly dispose of grease prior to moving the unit.*

COOKING TIPS

- Place bacon strips evenly [about 5 or 6 strips] on the Center Plate. Do not overlap strips.
- If necessary, trim the bacon to fit on the Center Plate.
- For best results, allow your bacon to sit at room temperature for 15 minutes before cooking.
- Bacon will cook in about 4 minutes. Cook longer to achieve your preferred crispiness.
- Because this appliance drains fat from the bacon, its appearance may be different than bacon cooked in a frying pan.
- Remove foods from the Griddle using a flat plastic or wooden utensil. DO NOT use metal utensils as they may scratch and damage the non-stick cooking surfaces.
- When cooking meat, be sure to periodically check the Drip Tray to prevent overflow.
- During cooking, the BLUE light may turn on and off. This is normal.

SMOKE DURING OPERATION

- If the unit begins to smoke during cooking, it may be due to grease buildup. In order to reduce smoking, make sure that you clean the Center Plate and Griddle Plates between uses.

NOTE: *It is normal for steam to escape through the small gap of the closed doors. To avoid burns and injury, stay clear of the steam when opening the Doors.*

CLEANING AND MAINTENANCE

- Make sure the Drip Tray is free of grease.
- Make sure the appliance is unplugged and cool to the touch.
- Wash the Griddle Plates, Center Plate and Drip Tray in warm, soapy water and dry thoroughly. Center Plate is top rack dishwasher safe.
- Wipe the main unit and exterior of the Doors with a slightly damp, non-abrasive cloth.
- Once clean, replace the Center Plate and Drip Tray.

NOTE: *NEVER immerse the unit in water or any other liquid. DO NOT use harsh or abrasive cleaners.*

BASE POSITIONS

1. Base position when cooking bacon.

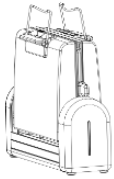

2. Base position when carrying.

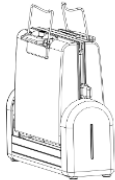

3. Base position for storage.

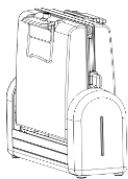

IMPORTANT SAFEGUARDS

- Read all instructions before use.
- This appliance is not to be used by persons (including children) with reduced physical, sensory or mental capabilities, or lack of experience and knowledge, unless they have been given supervision or instruction.
- Keep this appliance out of reach of children at all times.
- Do not operate this appliance with an external timer or remote control system.
- This appliance is intended for indoor, household use.
- If the power cord appears to be frayed or damaged, do not use this appliance. Contact Sharper Image Customer Service immediately.
- Do not touch hot surfaces. Use the Cool Touch Handles and oven mitts if necessary.

- To protect against electrical shock, do not immerse this appliance or the power cord in water or any other liquid.
- Unplug this appliance when not in use.
- Unplug this appliance before cleaning.
- Do not use this appliance with any attachments or modifications.
- Do not let the power cord hang over the edge of a table or counter, or touch hot surfaces.
- Do not place this appliance on or near a hot gas or electric burner, or in a heated oven.
- Extreme caution must be used when moving this or any appliance containing hot oil or other hot liquid.
- To disconnect this appliance, unplug it from the AC outlet.
- This appliance has a polarized plug [one blade is wider than the other]. As a safety feature, this plug will fit in a polarized outlet only one way. If the plug does not fit fully in the outlet, reverse the plug. If it still does not fit, contact a qualified electrician. Do not attempt to defeat this safety feature.
- Do not use this appliance for anything other than its intended use.
- Do not attempt to dislodge food when the appliance is plugged in.
- A fire may occur if the appliance is covered or touching flammable material, including curtains and draperies when in operation.
- Do not pour oil or grease into the appliance in order to deep fry foods, as this will cause a fire.
- A short power cord is supplied to prevent tangling or tripping.
- If an extension cord is to be used, it must have a marked electrical rating at least as great as the electrical rating of this appliance. The extension cord should be a grounded 3-wire cord.
- Do not allow the extension cord to drape over the table or counter, where it could be pulled or tripped over by a child.
- SAVE THESE INSTRUCTIONS.
- THIS UNIT IS FOR HOUSEHOLD USE ONLY.

WARRANTY/CUSTOMER SERVICE

Sharper Image branded items purchased from SharperImage.com include a 1-year limited replacement warranty. If you have any questions not covered in this guide, please call our Customer Service department at 1 (877) 210-3449. Customer Service agents are available Monday through Friday, 9:00 a.m. to 6:00 p.m. ET.

SHARPER IMAGE®

The SHARPER IMAGE® name and logo are registered trademarks.

©Sharper Image. All Rights Reserved.