

# SHARPER IMAGE®

## 12X ZOOM DIGITAL CAMERA BINOCULARS BY SHARPER IMAGE

Item No. 207051

User Guide



Thank you for purchasing the 12X Zoom Digital Camera Binoculars by Sharper Image. Please take a moment to read this guide and store it for future reference.

## INTRODUCTION

The 12X Zoom Digital Camera Binoculars by Sharper Image combine an advanced digital binocular system with a high-definition digital camera. Now you can get an up-close view of your subjects and capture images as stills or videos.

## IDENTIFICATION OF PARTS

1. LCD Screen
2. Optical Lens
3. Power On/Off
4. Left Button
5. Menu Button
6. Right Button
7. Focus Ring
8. Mode Button
9. Camera/OK Button
10. Eyepiece
11. Micro USB Port
12. Led Indicator
13. MicroSD Card Slot
14. Reset
15. Diopter Ring

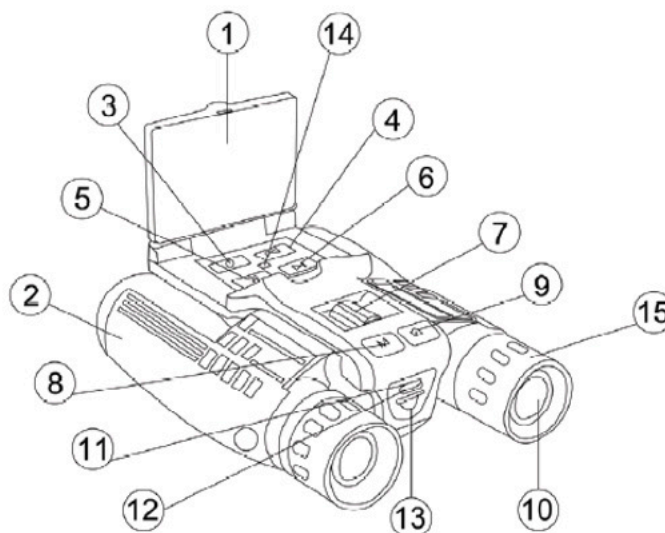

## HOW TO USE YOUR BINOCULARS

You can use these binoculars just like any other pair of binoculars. Place your eyes against the rubber rims, adjust the spacing of the two vision tubes and use the dial located above to focus. You can also turn the dial directly on the right side viewfinder at the level of the rubber where you place your eyes.

## CHARGING THE BATTERY

Connect to the device to the AC adaptor, using the dedicated USB cable supplied. The device can also be charged by connecting it to a computer using the included USB cable.

### Charging Indicator:

**RED LIGHT ON** = charging

**RED LIGHT OFF** = fully charged

## INSERTING A MEMORY CARD

Insert the included MicroSD card into the Micro SD card slot. [Max capacity 32 GB.]

## TURNING THE BINOCULARS ON

Press and hold the Power button [3] until the LCD screen turns on. The binoculars are now ready to take photos or videos.

## SETTING THE LANGUAGE AND TIME

After turning on the binoculars for the first time, you can change the language [default is English] and set the correct time.

First, open the system settings by pressing the menu button [5]. Now use the Left [4] and Right [6] buttons to navigate to “Language” and “Date & Time.” Press the Camera button [9] to open the Settings page. Use the Left [4] and Right [6] buttons to navigate through the languages and set the Date and Time. Confirm and exit by pressing the Camera button [9].

## SELECTING THE MODES

When the blue LED of the binoculars is lit, press the Mode button [8] to switch between Video, Photo and Replay modes.

**In Video mode:** Press the Camera button [9] to start shooting. Press again to stop shooting.

**In Photo Mode:** Press the Camera button [9] to take a picture. Press again to shoot additional photos

**In Replay Mode:** Use the Left [4] and Right [6] buttons to select the file you want to watch. Press the Camera button [9] to play a video on the screen.

**NOTE:** *To experience photos and videos in their highest quality, you must download and view them on your computer [using the USB cable or directly from the SD Card]. The built-in LCD screen will not display your files in their true full resolution.*

## TURNING THE BINOCULARS OFF

Press and hold the Power button [3] until the screen shuts off.

## VIDEO SETTINGS

Turn on the binoculars, press the Menu button [5] and then use the Left [4] and Right [6] buttons to navigate the video settings. Press the Camera button [9] to enter the sub-menus and set the video resolution. Press the Camera button to confirm your choices and exit Settings. Press the Menu button or Mode button to return to the main screen.

Available Video Settings	
Video Resolution	2.5K UHD 1080P FHD 1080P 720P
Loop Recording	Off 1 Minute 2 Minute 3 Minutes 5 Minutes 10 Minutes
Video Frame Rate	Normal Slow Fast
Time Stamp	Off On

## PHOTO SETTINGS

Turn on the binoculars, and select the photo mode. Press the Menu button [5] and then use the Left [4] and Right [6] buttons to navigate the Photo menu. Press the Camera button [9] to enter the sub-menus and confirm your choices and exit Settings. Press the Menu or Mode button [8] to return to the main screen.

Photo Settings	
Photo Size	48M 30M 25M 20M 10M 8M 5M 3M
Time Lapse	Off 2s Timer 5s Timer 10s Timer
Photo Burst	Off 3 Photos

## REPLAY SETTINGS

Turn on the binoculars and select the Replay mode. Press the Mode button [8] to enter Replay mode and then use the Left [4] or Right [6] buttons to navigate to your photo or video file. Press the Camera button [9] to replay the video. Press the Menu button [5] and Camera button [9] to delete the file. Press the Mode button to return to the main screen.

Delete Options in Replay Mode	
Delete	Cancel Ok

## EXPOSURE SETTINGS

The Exposure Value [a.k.a. "EV" or brightness] function can be set to auto ["EV-A"] when the light is sufficient. In low light conditions, the EV [brightness] can be adjusted from 1 to 9. If possible, adjust the peripheral light of the photographed object to achieve the clearest images.

Turn on the binoculars. In Video or Photo standby mode, short press Left [4] or Right [6] buttons to set the Exposure Value.

EV (Brightness) Settings	
Exposure Value (EV)	EV-A (auto) EV-1 EV-2 EV-3 EV-4 EV-5 EV-6 EV-7 EV-8 EV-9

## SYSTEM SETTINGS

Turn on the binoculars and press the Menu button [5] to open the Settings menu. Use the Left [4] or Right [6] buttons to navigate the menu. Press the Camera button [9] to enter the sub-menus and confirm your choices. To exit Settings, press the Menu button [5] or Mode button [8] to return to the main screen.

Settings Sub-Menus	
Screen Brightness	Level 1, 2, 3, 4, 5, 6, 7, 8
Screen Saver	Off / 1 minute / 2 minutes / 3 minutes
Auto Power-Off	Off / 1 minute / 3 minutes / 5 minutes
Language	English / Japanese / French / Spanish / Portuguese / German / Korean / Italian / Chinese / Russian / Arabic
Volume	Level 0, 1, 2, 3, 4, 5, 6, 7
Format Memory Card	Cancel Format
Date/Time Set	Year / Month / Day <u>Hour</u> : Minute
Restore Default	Cancel OK

## CONNECTING TO A COMPUTER

You can connect this device to a computer via USB. First, connect the device to your computer with the included USB cable. Then, power on the binoculars. The computer can then read the files on your binoculars.

## RESETTING THE DEVICE

In the unlikely event of a malfunction, the device may not connect to your computer. In that situation, please reset the binoculars by pressing the Reset button [14]. The device will stop and restart. Neither the settings nor the recorded files on the MicroSD card will be affected.

## CARE AND MAINTENANCE

- Clean this device with a dry or slightly damp, lint-free cloth when necessary.
- Do not use abrasive cleaners.
- Do not use this device in extreme [hot or cold] temperatures.
- Do not use this device in a moist environment.
- Do not use this device in the rain or other wet conditions.
- Do not drop or mishandle this device.
- Do not open or disassemble this device. There are no user-serviceable parts.

## SPECIFICATIONS

Magnification	12X
Effective diameter of objective lens	32mm
Angular field of view (real)	5.5°
Field of view at 1000m	96m/1000m
Exit pupil	2.6mm
Eye relief	13mm
Close focusing distance	5m
Interpupillary distance adjustment	65-80mm
Digital zoom	8X
Photo resolution	48M / 30M / 25M / 20M / 10M / 8M / 5M / 3M
Video resolution	2.5K UHD / 1080 FHD / 1080P / 720P
Screen	2.4" IPS Screen
Languages	English / Japanese / French / Spanish / Portuguese / German / Korean / Italian / Chinese / Russian / Arabic
Memory	Micro SD card (32 GB MAX)
USB Port	Type-C
Battery	Built-in Rechargeable Lithium Polymer battery

## WARRANTY AND CUSTOMER SERVICE

This item from SharperImage.com includes a 1-year limited replacement warranty. If you have any questions not covered in this guide, please call our Customer Service department at 1 (877) 210-3449. Customer Service agents are available Monday through Friday, 9:00 a.m. to 6:00 p.m. ET.

**SHARPER IMAGE®**

The SHARPER IMAGE® name and logo are registered trademarks.

©Sharper Image. All Rights Reserved.