

# SHARPER IMAGE®

## ROLLING TOOLBOX STOOL

Item No. 206680

User Guide



Thank you for purchasing the Sharper Image Rolling Toolbox Stool. Please take a moment to read these instructions and store them for future reference.

## INTRODUCTION

The Rolling Toolbox Stool is the perfect seat for projects and auto repair. It supports up to 300 lbs. to hold you and your favorite tools.

## FEATURES

- Combination rolling stool and toolbox
- Heavy-duty steel frame
- Supports up to 300 lbs.
- PVC swivel casters
- Three padded drawers to protect tools and small parts
- Rear tool/screwdriver holder
- Two foldable easy-access magnetic tool trays
- Comfortable seat cushion

## UNPACKING

**WARNING!** Do not operate this device if any parts are missing. Contact Sharper Image Customer Service immediately for assistance.

- Remove the parts and accessories from the packaging and inspect for damage.
- Make sure that all items in the parts list are included. Failure to do so could result in a malfunction and personal injury.

## PARTS LIST

Part No.	Description	Qty
1	Stool Pad	1
2	Body	1
3	Drawer	3
4	Side Tray Frame	2
5	Tool Holder Shelf	1
6	Side Tray	2
7	Caster	4
8	Tube Cap	4
9	Buckle	2
10	Sleeve Nut	4
11	Bolt M 8x12	4
12	Bolt M 6x40	4
13	Bolt M 8x65	4
14	Bolt M 6x12	2
15	Washer M 8xD16	4
16	Washer M 8xD22	4
17	Washer M 10	4

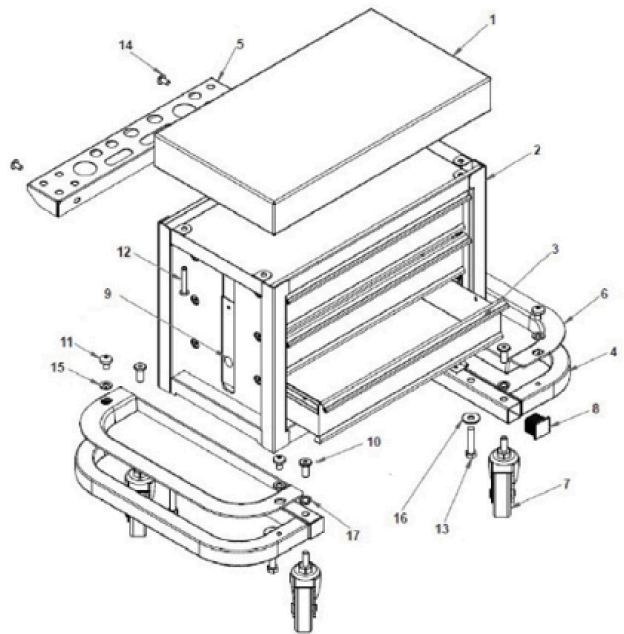

## ASSEMBLY INSTRUCTIONS

1. Assemble Casters [7] through the holes on the Side Tray Frame [4] and secure in place using Sleeve Nuts [10]. Tighten securely using a hex key.
2. To assemble the magnetic Side Trays, inset Bolt [13] through Washer [16] and Side Tray Frame and into the Body Frame [2].
3. To assemble the Tool Holder Shelf [5], screw the Bolt [14] through the holes in the Shelf and into back side of the body. **Note:** *The Side Tray Frames can fold up and be secured to the seat body using the Buckles [9].*

## SPECIFICATIONS

Load Capacity	300 lbs.
Frame Material	Steel Construction
Caster Size	2.5 in.
Number of Casters	4

## SAFETY INFORMATION

**WARNING!** *Please read and understand all instructions before using this tool. The operator must follow basic precautions to reduce the risk of personal injury and/or damage to the device.*

- Use this device for its intended purpose only.
- Do not modify this device. Follow the instructions carefully.
- Do not operate this or any tool under the influence of drugs or alcohol.
- Always wear eye protection when using tools.

## WARRANTY / CUSTOMER SERVICE

Sharper Image branded items purchased from SharperImage.com include a 1-year limited replacement warranty. If you have any questions not covered in this guide, please call our Customer Service department at 1 (877) 210-3449. Customer Service agents are available Monday through Friday, 9:00 a.m. to 6:00 p.m. ET.

**SHARPER IMAGE®**

The SHARPER IMAGE® name and logo are registered trademarks.

©Sharper Image. All Rights Reserved.