



Model MC1230  
Modelo MC1230  
Modèle MC1230

# Handheld Steam Cleaner

Limpiador a vapor portátil

Nettoyeur à vapeur portatif

Owner's Guide

Guía del Usuario

Mode D'emploi

English p. 2

Español p. 18

Français p. 34

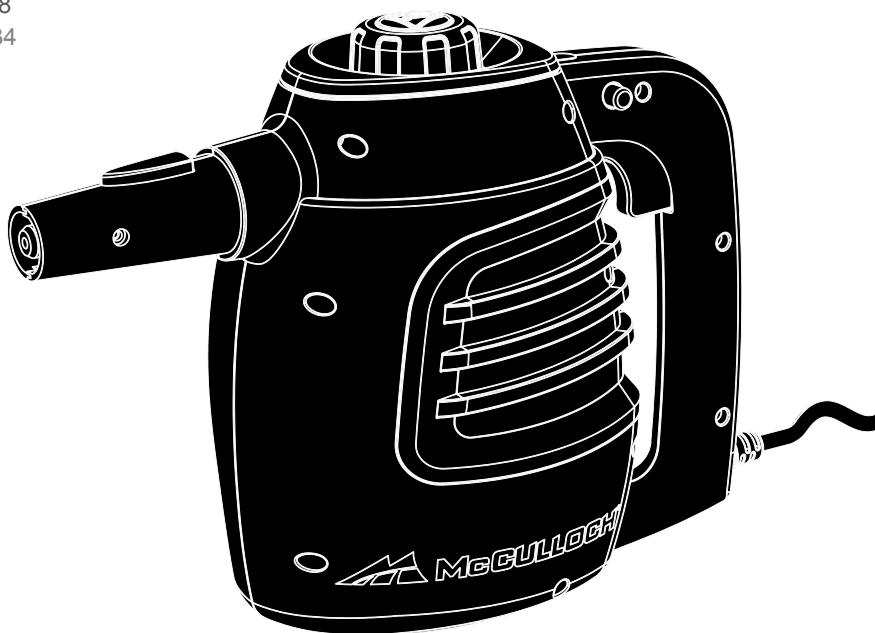

## KEEP YOUR RECEIPT FOR WARRANTY PURPOSES

Please read all instructions before use.

## GUARDE SU RECIBO A EFECTOS DE LA GARANTÍA

Lea todas las instrucciones antes de usarlo.

## GARDEZ VOTRE REÇU AUX FINS DE LA GARANTIE

Veuillez lire toutes les instructions avant l'utilisation.

# IMPORTANT SAFETY INSTRUCTIONS



**WARNING:** To reduce the risk of fire, electrical shock, or injury, the following basic safety precautions should always be followed when using an electrical appliance.

## READ ALL INSTRUCTIONS BEFORE USE

1. The Handheld Steam Cleaner Water Tank is designed to hold a maximum of 6 oz. (177 ml.) of water. Unplug electrical cord before filling with water.
2. DO NOT leave your Handheld Steam Cleaner unattended when plugged in or not in use. Use only for its intended purpose as indicated in this manual.
3. This unit is not a toy. Close supervision is required when using unit near children, pets, and plants. Steam produced by unit is hot and pressurized. Care must be taken to avoid burns or other injuries. Never point nozzle at people or pets.
4. To reduce the risk of contact with hot water emitting from steam vents, hold appliance away from body and check for signs of condensation or leakage.
5. DO NOT use this unit if electrical cord or outlet is damaged. DO NOT use unit if it is not working properly or has been dropped, damaged or left outdoors. If such damage occurs, DO NOT disassemble or attempt repairs, take unit to a qualified service person for examination and repair. Incorrect reassembly or repair could cause a risk of fire, electrical shock, or injury to persons when steam cleaner is used.
6. To reduce risk of electrical shock, DO NOT immerse in water or other liquids. DO NOT use electrical cord as a handle. DO NOT allow cord to be crimped by closing it in doors. DO NOT pull or stretch cord around sharp corners or edges.
7. Do not allow cord to touch hot surfaces. Let appliance cool completely before putting away. Loop cord loosely around appliance when storing.
8. DO NOT use this unit with extension cords or electrical outlets that have inadequate current capacity. A three-prong outlet or a properly grounded adapter is necessary when using Handheld Steam Cleaner.
9. In order to unplug Handheld Steam Cleaner, grasp plug and pull smoothly and firmly from outlet. DO NOT attempt to unplug unit by pulling or tugging on cord.
10. Use caution, as burns could occur from touching hot metal parts, hot water or steam.

# IMPORTANT SAFETY INSTRUCTIONS

---



**WARNING:** To reduce the risk of electrical shock, this appliance has a three-pronged plug. This plug will fit in a polarized wall outlet only one way. If the plug does not fit fully in the outlet, contact a licensed electrician to install a proper outlet. DO NOT attempt to modify the plug or defeat this safety feature.

11. The Handheld Steam Cleaner is only meant to be used with recommended Handheld Steam Cleaner accessories. Other types of attachments are not to be used with the Handheld Steam Cleaner. Doing so may cause injuries or damage to unit.
12. Attachments become hot during use. To avoid injuries, DO NOT touch attachments while using this appliance. DO NOT attempt to change attachments while unit is emitting steam.
13. When filling your Handheld Steam Cleaner, only water should be used in unit. Other cleaning agents will damage unit and can cause injuries.
14. DO NOT operate unit if steam opening is blocked. Should this occur, immediately cease usage and unplug from electrical outlet.
15. Store your Handheld Steam Cleaner in a cool, dry place.
16. To avoid burns from escaping steam when removing Boiler cap to refill unit:
  - Always allow unit to cool for 20 minutes.
  - Press and hold Steam Trigger to release ALL remaining steam.

## SAVE THESE INSTRUCTIONS FOR HOUSEHOLD USE ONLY

---

### Questions or comments?

- [www.mccullochsteam.com](http://www.mccullochsteam.com)
- [consumerservice@mccullochsteam.com](mailto:consumerservice@mccullochsteam.com)
- 1-800-711-6617

These features and accessories are included with your Handheld Steam Cleaner. To obtain additional parts, refer to Product Support on Page 16 of this manual.

### UNIT FEATURES

- |   |                       |
|---|-----------------------|
| 1 | Boiler Cap            |
| 2 | Steam Trigger         |
| 3 | Steam Trigger Lock    |
| 4 | 15' Power Cord        |
| 5 | Steam Nozzle          |
| 6 | Steam Indicator Light |
| 7 | On/Off Switch         |

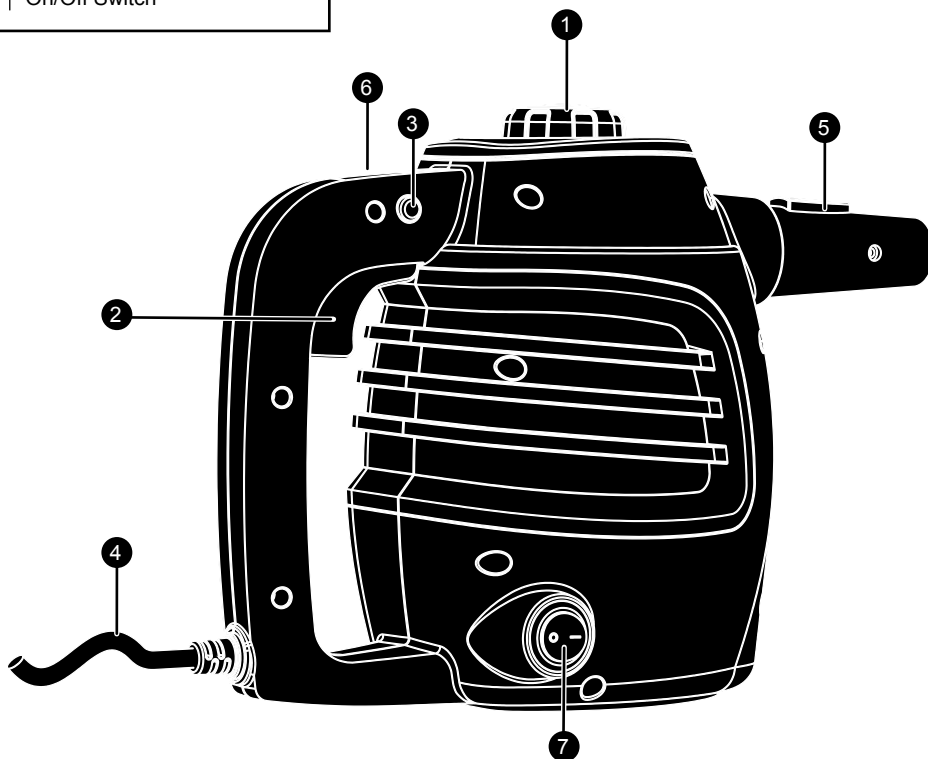

- The *Boiler Cap* (1) is designed to safely contain steam inside the Boiler. The Boiler Cap must be unscrewed and removed in order to fill the Boiler with water.
- The *Steam Trigger* (2) must be pressed in order to start the flow of steam from the Steam Nozzle.
- The *Steam Trigger Lock* (3) locks the Steam Trigger for continuous steam.
- The *15' Power Cord* (4) conveniently helps to reach all your cleaning tasks.
- The *Steam Nozzle* (5) emits a flow of hot, penetrating steam when the Steam Trigger is activated.
- The *Steam Indicator Light* (6) illuminates green once steamer has reached the amount of pressure which is required to operate, indicating it is ready for use. During use, the light may turn Red, indicating the steamer is recovering the necessary pressure. Unit can be used at a lower pressure.
- The *On/Off Switch* (7) powers the unit On or Off.



## ACCESSORIES

- |    |                              |
|----|------------------------------|
| 1  | 5.5" Jet Nozzle              |
| 2  | 4" Triangle Brush            |
| 3  | 6"x 4.5" Large Brush         |
| 4  | 34" Extension Hose           |
| 5  | 3" Scraper                   |
| 6  | Storage Bag                  |
| 7  | Fill Cup                     |
| 8  | 1 - 2.5" Round Scrub Pad     |
| 9  | 2 - 1.5" Nylon Utility Brush |
| 10 | 1 - 1.5" Brass Utility Brush |

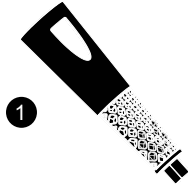

5.5" Jet Nozzle  
A1230-001

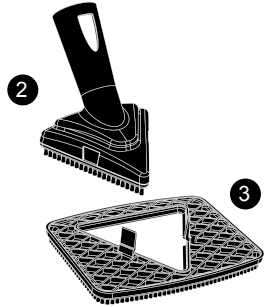

4" Triangle Brush  
A1230-002

6" x 4.5" Large Brush  
A1230-003

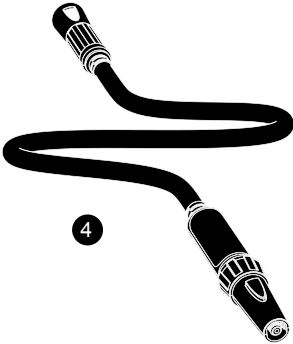

34" Extension Hose  
A1230-004

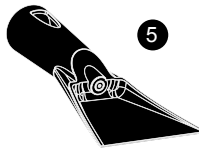

3" Scraper  
A1230-009



Storage Bag  
A1230-010



Fill Cup  
A1230-008



2.5" Round Scrub  
Pad A1230-007



1.5" Nylon Utility Brushes  
A1230-005



1.5" Brass Utility Brush  
A1230-006

- The *5.5" Jet Nozzle* (1) connects to the Steam Nozzle and is designed to focus the flow of steam for concentrated cleaning. The Nylon Utility Brush, Brass Utility Brush and Round Scrub Pad all connect to the Jet Nozzle. Alternatively, the Jet Nozzle may be connected to the end of the Extension Hose.
- The *4" Triangle Brush* (2) connects to the Steam Nozzle or Extension Hose, and is designed for cleaning corners and other difficult angles.
- The *6" X 4.5" Large Brush* (3) attaches to the Triangle Brush to cover large surfaces.
- The *34" Extension Hose* (4) connects to the Steam Nozzle and is designed to provide additional freedom to easily reach a variety of spaces. The Jet Nozzle should be connected to the male end of the Extension Hose in order to safely focus the flow of steam.
- The *3" Scraper* (5) connects to the Steam Nozzle and is designed to help scrape and remove baked on food from ovens or other hard to remove materials.
- The *Storage Bag* (6) is provided to store all attachments neatly in one convenient bag.
- The *Fill Cup* (7) is used to fill the boiler without spills.
- The *2.5" Round Scrub Pad* (8) connects to the Jet Nozzle and is designed to scrub tough dirt and scuffs from surfaces.
- The *1.5" Nylon Utility Brush* (9) connects to the Jet Nozzle and is designed for scrubbing especially tough stains. It is ideal for use on many surfaces around the home, including carpet, ceramic tile, grouting, and more.
- The *1.5" Brass Utility Brush* (10) connects to the Jet Nozzle and is designed for scrubbing especially tough stains. It is perfect for use on BBQ grills, oven racks, automobile engines, shop tools and other hard metal surfaces.

## STEAM CLEANING ACCESSORIES

**WARNING:** Do not connect accessories while unit is emitting steam.

### JET NOZZLE / SCRAPER / EXTENSION HOSE / TRIANGLE BRUSH

1. Select one of the four accessories (Jet Nozzle shown as example) and push onto the Steam Nozzle (A).
2. Rotate accessory until the yellow lock/release button snaps into the accessory hole (B).

**NOTE:** The Jet Nozzle, Scraper and Triangle Brush can be connected to the end of an Extension Hose for reaching high or difficult spots. Connect the Extension Hose, then connect your desired accessory in the same way as you would normally connect to the Jet Nozzle.

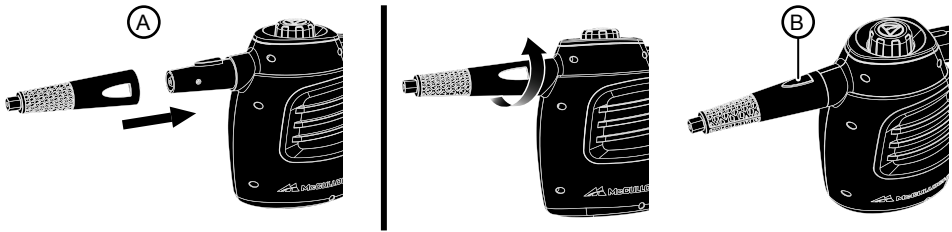

### UTILITY BRUSHES / SCRUB PAD

**NOTE:** These accessories connect to the Jet Nozzle, not the Steam Nozzle.

1. Firmly press accessory onto tip of Jet Nozzle. Press it on as far as possible to prevent steam leakage (See figure 1).
2. To remove Utility Brush, simply grip it firmly and pull it off Jet Nozzle.

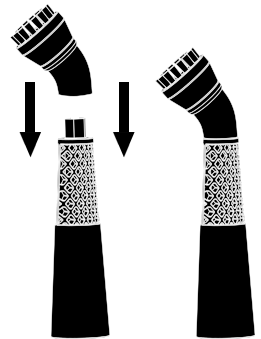

FIGURE 1



## LARGE BRUSH

**NOTE:** Large Brush connects to the Triangle Brush, not the Jet Nozzle.

1. Place Large Brush over the Triangle Brush, and firmly press it on to the Triangle Brush until it snaps into place (See figure 2).
2. To remove Large Brush, simply grip it firmly and pull it off of the Triangle Brush.

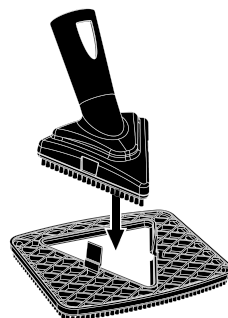

**FIGURE 2**

## ORDERING ACCESSORIES & PARTS

Replacement accessories and parts for your Handheld Steam Cleaner (model MC1230) may be ordered through our Website:

[www.mccullochsteam.com](http://www.mccullochsteam.com)

You may also contact Consumer Service directly:

[consumerservice@mccullochsteam.com](mailto:consumerservice@mccullochsteam.com) or 1-800-711-6617

Jet Nozzle	Dirt, Grease, Grime, Cracks and Crevices, Golf Clubs, Tread of Running Shoes
Triangle Brush	Corners on Countertops, Bathtubs, Floors
Large Brush	Floors, Grout
Scraper	Baked on Food, Grime, Grease, Stove Tops, Ovens
Round Scrub Pad	Countertops, Bathtubs, Sinks, Refrigerators, Ovens, Slate
Nylon Utility Brush	Ovens, Stove Tops, Faucet Fixtures, Microwaves, Sports Equipment, Tile, Grout, Refrigerators, Toys, Door Knobs, Showers, Bathtubs, Changing Tables
Brass Utility Brush	BBQ Grills, Oven Wire Racks

**NOTE:** Before cleaning electrical appliances, check and follow appliance manufacturer's cleaning guidelines. Never apply to electrical parts.

**NOTE:** Some delicate surfaces, such as painted wood or stainless steel may be scratched or damaged by the bristle of the brushes, especially the Brass Utility Brush. Use careful judgment when deciding what surface to clean with any of the brushes. If you are unsure if a surface will be damaged, it is recommended that you test a small inconspicuous spot before proceeding.

## FILLING THE BOILER

1. Place Handheld Steam Cleaner on a flat, level surface.
2. Make sure On/Off Switch is turned to "Off" and grounded power cord is unplugged from electrical outlet.



**If unit has been in use, always use the following safety precautions before removing the Boiler Cap to add water:**

- Allow unit to cool for 20 minutes.
- Press and hold Steam Trigger to release **ALL** remaining steam.

**WARNING: Failure to follow these precautions may result in burns from escaping steam when the Boiler Cap is removed.**

3. Cautiously unscrew and remove Boiler Cap.
4. Drain any water remaining inside Boiler.

**NOTE: Boiler should be emptied after each use – this will help minimize mineral build-up and prevent over-filling.**

5. Fill the Fill Cup to maximum fill line (6 oz. / 177 ml.) with water.

**NOTE: In order to significantly reduce mineral build-up and prolong the life of your Handheld Steam Cleaner, use of distilled or de-mineralized water in the unit is highly recommended. Refer to Page 13 for more information about mineral build-up.**

6. Carefully pour water from Fill Cup into Boiler.

**WARNING: Caution should always be used when pouring water into the Boiler. Do not look directly down into fill hole when filling. Keep your free hand and any children or pets at a safe distance.**

7. Replace Boiler Cap, ensuring that it is screwed on tightly to prevent hot steam from escaping and causing injury.

## GENERAL OPERATION

**NOTE: Be sure that Boiler has been filled and that all desired accessories are connected before following these steps.**

1. For first time use, remove protective plastic cover from electrical plug. Plug power cord into a electrical outlet.
2. Press On/Off Switch to “On” position. Steam Indicator Light will illuminate Red. Once unit is ready to steam, Steam Indicator Light will turn Green. During use, the light may turn Red, indicating the steamer is recovering the necessary pressure. Unit can be used at a lower pressure.
3. Direct Nozzle (and any connected accessory) towards surface you desire to steam, and press Steam Trigger. To sanitize surfaces, point Nozzle, press Trigger and hold approximately 1/2 inch from surface for at least 5 seconds. This will insure that you have killed germs and bacteria.

**CAUTION: Always be sure that Nozzle and any accessory are pointed in a safe direction (away from yourself, other people, pets, and plants) before pressing Steam Trigger.**

4. Keep Steam Trigger pressed for a continuous flow of steam. You may also hold the Steam Trigger, then push the Steam Trigger Lock to lock it down. This will allow a continuous flow of steam without need of holding the Steam Trigger down manually.
5. Using a back-and-forth motion over the area you are steaming will further enhance the cleaning process. Wipe steamed areas with a clean cloth to remove loosened dirt and grime. Wiping the area while it is still wet is recommended, but use caution when wiping surfaces such as metal that may still be hot.
6. Once steaming tasks are complete, turn the unit “Off” and unplug. Follow steps under Proper Storage procedure on Page 13 of this manual.

## PROPER STORAGE

Preparing your Handheld Steam Cleaner for storage is quick and simple. When you have finished your steaming tasks, follow the steps listed below.

1. Turn unit "Off" and unplug power cord.
2. Press and hold Steam Trigger to release all remaining steam.
3. Allow unit to completely cool (at least 30 minutes).
4. Remove all accessories from unit.
5. Carefully remove Boiler Cap.
6. Drain any remaining water from Boiler into a sink or tub – this will help to minimize mineral build-up and prevent over-filling during your next use. Replace Boiler Cap loosely.
7. Store accessories. Accessories can be conveniently stored in the Storage Bag.
8. Store Handheld Steam Cleaner in a cool, dry location.

## MINERAL BUILD-UP

A common maintenance need for steam appliances is the removal of build-up caused by high mineral content in many municipal water supplies. This mineral build-up may limit the effectiveness and reduce the life of your Handheld Steam Cleaner.

The best way to minimize mineral build-up is to use distilled or de-mineralized water when using your Handheld Steam Cleaner. If you are unable to use distilled water, it is recommended that the following procedure be followed monthly to remove any mineral build-up:

1. Turn unit "Off" and unplug power cord.
2. Allow unit to completely cool (at least 30 minutes).
3. Press and hold Steam Trigger to release all remaining steam.
4. Remove all accessories from unit.
5. Carefully remove Boiler Cap.
6. Drain water from Boiler into a sink or tub.
7. Using Measuring Cup, measure of 6 oz. (177 ml.) vinegar.
8. Slowly pour vinegar into Boiler.
9. Allow to stand for 40 minutes.
10. Drain vinegar from Boiler.
11. Rinse Boiler with fresh water, drain and repeat until vinegar odor dissipates.
12. Replace Boiler Cap.

PROBLEM	POSSIBLE CAUSE	SOLUTION
Unit fails to heat up.	Unit is not plugged in. Household circuit breaker / ground fault interrupter has tripped or blown a fuse.	Plug power cord into electrical outlet.  Reset circuit breaker / ground fault interrupter, or replace fuse. If you need assistance, contact a licensed electrician.
	Unit is damaged or otherwise in need of repair.	Immediately cease usage and unplug. Contact Consumer Service for further assistance (see Page 16 for details).
	Boiler is empty.	Refer to <b>Filling The Boiler</b> procedure on Page 11.
	Mineral build-up in unit.	Refer to <b>Mineral Build-up</b> section on Page 13 for cleaning procedure.
Steam output is weak or intermittent.	Water level in Boiler is running low.	Refer to <b>Filling The Boiler</b> procedure on Page 11.
	Mineral build-up in unit.	Refer to <b>Mineral Build-up</b> section on Page 13 for cleaning procedure.
Excessive amount of water in steam.  <b>NOTE: Unit produces wet steam – it is normal for steam to contain some amount of water.</b>	Water condensation in Extension Hose.	Point nozzle towards sink, tub or ground and shake while pressing Steam Trigger. Continue until excess water is released.
	Boiler has been overfilled.	Filling Boiler with more than 6 oz. (177 ml.) of water interferes with steam production, resulting in water condensation in steam.  Always use included Fill Cup to fill unit with correct amount of water. (see Page 11 for details)
Accessories do not stay firmly connected to Steam Nozzle.	Accessories not properly installed.	Check to make sure that accessories are properly connected, per procedures on Pages 8-9.

Refer to the part numbers below when ordering parts and accessories for your Handheld Steam Cleaner.

### **Replacement Accessories**

Part Numbers for Fast Reordering at [www.mccullochsteam.com](http://www.mccullochsteam.com)

Jet Nozzle	A1230-001
Triangle Brush	A1230-002
Large Brush	A1230-003
Extension Hose	A1230-004
Nylon Utility Brush - 5 Pack	A1230-005-5
Brass Utility Brush - 5 Pack	A1230-006-5
Round Scrub Pad - 5 Pack	A1230-007-5
Fill Cup	A1230-008
Scraper	A1230-009
Storage Bag	A1375-010

### **Replacement Parts**

Available via Consumer Service at 1-800-711-6617

Boiler Cap	T1230-001
------------	-----------



## CONSUMER SERVICES

For problems with your Handheld Steam Cleaner, please refer to the Troubleshooting guide located on Page 14 of this manual. Additional inquiries should be directed to our consumer support services through our website, [www.mccullochsteam.com](http://www.mccullochsteam.com).

If you do not have internet access, you may also contact our Consumer Service Department by telephone, at 1-800-711-6617.

**NOTE: In order for our Consumer Service representatives to help you as quickly and efficiently as possible, please have the following information ready before calling:**

- Purchase information (where and when you purchased this product)
- Copy of purchase receipt / proof of purchase
- Product serial number (located on electrical specification label on back of unit)
- Date code (4-digit number located on electrical specification label)

### PRODUCT SPECIFICATIONS

MODEL	MC1230
VOLTAGE	120V
POWER	900W
WATER CAPACITY	6 oz. (177 ml)
HEATING TIME	2 min. (approximate)
CONTINUOUS STEAM TIME	10 min (approximate)
UNIT WEIGHT	3 lbs. (1.4 kg.)
UNIT DIMENSIONS	10.70" x 5.13" x 8.00" (27.2 cm x 13.0 cm x 20.3cm)



## 2-YEAR LIMITED WARRANTY

### What is covered

McCulloch® is a licensed brand of Steamfast, a division of Vornado Air, LLC ("Steamfast"). Subject to the terms and conditions of this 2-Year Limited Warranty ("Warranty") as set forth below, Steamfast warrants to the original consumer or purchaser ("Buyer") that this McCulloch®-branded steam product, excluding all accessories and attachments, (the "Product") is to be free from defects in material and workmanship for a period of two (2) year from the date of purchase when used and maintained in accordance with the Owner's Guide (the "Warranty Period").

In the event Buyer notifies Steamfast of a defect in the Product within the Warranty Period, Steamfast will replace the Product and/or defective component parts, as applicable and necessary. Any such replacement will be made at no charge to Buyer for parts or labor, provided that Buyer shall be responsible for all shipping and transportation costs associated with returning the Product to Steamfast for inspection and covered replacement.

### What is not covered

This Warranty shall not be applicable to damage or loss caused in whole or in part by:

- Repairs, modifications or alterations to the Product by anyone other than Steamfast.
- Use or operation of the Product outside the permitted or intended uses described by Steamfast in the Owner's Guide, or other careless operation, handling, misuse, or abuse of the Product.
- Lack of proper maintenance or timely cleaning of the Product as specified in the Owner's Guide.
- Use of the Product other than for normal household purposes.



- Normal wear and tear.
- Used consumable parts, accessories and attachments, including, but not limited to, brushes, hangers, scrub pads and mop pads.
- Use of parts and accessories other than those produced or recommended by Steamfast.
- Cosmetic damage, such as scratches, nicks and dents.
- Damage caused by accident, water, flood, fire or other acts of nature or external causes.

## Warranty limitations and exclusions

- NO OTHER EXPRESS WARRANTY IS GIVEN BY STEAMFAST TO BUYER AND NO REPRESENTATIVE HAS THE AUTHORITY TO MAKE REPRESENTATIONS OTHER THAN THOSE PROVIDED HEREIN.
- THERE ARE NO WARRANTIES WHICH EXTEND BEYOND THE DESCRIPTION ON THE FACE HEREOF AND ALL IMPLIED WARRANTIES, SPECIFICALLY THE IMPLIED WARRANTIES OF MERCHANTABILITY AND FITNESS FOR A PARTICULAR PURPOSE, ARE HEREBY EXPRESSLY LIMITED TO THE DURATION OF THE WARRANTY PERIOD, UNLESS A SHORTER PERIOD IS PERMITTED BY LAW.
- STEAMFAST'S REPLACEMENT OF THE PRODUCT IS THE EXCLUSIVE REMEDY. UNDER NO CIRCUMSTANCES SHALL STEAMFAST BE LIABLE TO BUYER OR ANY OTHER PERSON FOR ANY INCIDENTAL, SPECIAL, CONSEQUENTIAL, OR OTHER DAMAGES, EVEN IF STEAMFAST HAS BEEN ADVISED OF OR COULD REASONABLY FORESEE THE POSSIBILITY OF SUCH DAMAGES, INCLUDING, BUT NOT LIMITED TO, LOSS OF PROFITS OR DAMAGE, WHETHER ARISING OUT OF BREACH OF WARRANTY, BREACH OF CONTRACT OR UNDER ANY OTHER THEORY OF LAW.
- THIS WARRANTY GIVES BUYER SPECIFIC LEGAL RIGHTS. BUYER MAY ALSO HAVE OTHER RIGHTS WHICH VARY FROM STATE-TO-STATE. SOME STATES DO NOT ALLOW THE EXCLUSION OR LIMITATION OF INCIDENTAL OR CONSEQUENTIAL DAMAGES, AND SOME STATES DO NOT ALLOW LIMITATIONS ON HOW LONG AN IMPLIED WARRANTY LASTS, SO THE ABOVE LIMITATION OR EXCLUSION MAY NOT APPLY TO BUYER.

## How do you register the Warranty

Buyer must complete an application to register this Warranty within sixty (60) days following date of purchase. Buyer may either visit Steamfast's website at [www.mccullochsteam.com](http://www.mccullochsteam.com) and complete an online application or mail a completed application to Steamfast. Failure to register this Warranty within sixty (60) days following date of purchase will render this Warranty null and void.

## Warranty service

For warranty service, call 1-800-711-6617 or email [consumerservice@mccullochsteam.com](mailto:consumerservice@mccullochsteam.com) to obtain a Return Authorization ("RA") form. Include the Product model number and serial number, as well as Buyer's name, address, city, state, zip code and phone number when contacting Steamfast for warranty service. Buyer may be required to provide the original sales receipt for purposes of verifying date of purchase. After receiving the RA form, the Product must be shipped, postage prepaid by Buyer, to:

Steamfast  
Attn: Warranty & Repair  
415 E. 13th Street  
Andover, KS 67002

To assure proper handling, packages must be clearly marked with the RA number. Packages not clearly marked with the RA number may be refused at the receiving dock.

Important: After receiving return authorization, carefully pack the Product to avoid damage in shipping. Damage in shipping is not covered by the Warranty and shall be the sole responsibility of Buyer. Damage or loss not covered by this Warranty or occurring outside the Warranty Period will require a fee to cover the cost of handling and shipping. All such fees and costs shall be the sole responsibility of Buyer.

Please allow at least 1-2 weeks for return of the Product after it is received by Steamfast. For ease of recordkeeping, it is recommended that Buyer staple or attached the original sales receipt to this Owner's Guide and record the Product serial number (located on the Product specifications decal) here:



review this product online  
evalúe este producto en línea  
évaluer ce produit en ligne

[www.mccullochsteam.com/reviews](http://www.mccullochsteam.com/reviews)

Manufactured by Vornado Air LLC under license from Husqvarna AB (publ).

For more information on other McCulloch products,  
visit [www.mcculloch.com](http://www.mcculloch.com)

For questions, or comments or warranty information,  
call 1-800-711-6617 or visit [www.mccullochsteam.com](http://www.mccullochsteam.com)