

8 In 1 Portable Power Source with Hand Generator

INSTRUCTION MANUAL



IMPORTANT: PRIOR TO USE, READ AND UNDERSTAND ALL WARNINGS, CAUTIONS AND INSTRUCTIONS INCLUDED IN THIS INSTRUCTION MANUAL, AND THOSE PUBLISHED BY YOUR VEHICLE BATTERY MANUFACTURER AND MANUFACTURER OF ANY DEVICE INTENDED TO BE USED WITH THIS UNIT. RETAIN THESE INSTRUCTIONS FOR FUTURE REFERENCE.

FIRST AID: MAKE SURE FRESH WATER & SOAP ARE AVAILABLE NEARBY IN CASE BATTERY ACID CONTACTS SKIN, EYES OR CLOTHING. IF CONTACT WITH BATTERY ACID OCCURS, RINSE IMMEDIATELY AND THOROUGHLY WITH WATER, THEN WASH WITH SOAP AND WATER. GET IMMEDIATE MEDICAL ATTENTION IF REDNESS, IRRITATION OR PAIN IS PRESENT. FOR EYE CONTACT FLUSH EYES FOR AT LEAST 15 MINUTES AND GET IMMEDIATE MEDICAL ATTENTION.

WARNING: THIS DEVICE CONTAINS A SEALED, NON-SPILLABLE LEAD-ACID BATTERY AND MUST BE DISPOSED OF PROPERLY. CONTACT YOUR LOCAL GOVERNMENT RECYCLING AUTHORITY FOR PROPER DISPOSAL.

IMPORTANT SAFETY INSTRUCTIONS:

WARNINGS:

- Read, understand and follow all instructions, cautions and warnings listed in this manual. Failure to follow all instructions and abide by all cautions and warnings could result in personal injury, injury to others and property damage.
- Use this product with 12 Volt lead-acid batteries ONLY. DO NOT connect to 6 Volt or 24 Volt DC batteries.
- DO NOT use with dry-cell batteries, these batteries may burst and may cause injury to person or damage personal property.
- Working around Lead-Acid Batteries may be dangerous. Lead-acid batteries generate explosive gases during normal charging and jump-starting operations.
- DO NOT face battery. Stay as far as possible from vehicle battery being jumped when making final connection.
- All lead-acid batteries (car, truck and boat) produce hydrogen gas, which may violently explode in the presence of fire or sparks. DO NOT smoke, use matches, lighters or open flame near batteries.
- DO NOT operate this device or place this product near flammable materials or any location, which accumulate flammable fumes.
- Do not submerge in water, or expose unit to heavy moisture or rain.
- Some late model vehicles have on-board computers that might be damaged if jump-started. Always read the vehicle owner's manual before attempting to jump-start (battery boost) the vehicle to determine if external-starting assistance is acceptable.
- Stay clear of fan blades, belts, pulleys and moving parts that can cause bodily injury during battery jump-start.
- DO NOT use additional attachments other than those recommended or provided by the manufacturer.
- DO NOT exceed manufacturer's recommended specifications.
- Always check tire air inflation for proper air pressure with separate air gauge during and after inflating.
- DO NOT operate compressor more than 20 minutes continuously. Allow the compressor to cool down between each continuous operation.
- BURSTING HAZARD! DO NOT overinflate any inflatable article! DO NOT exceed the manufacturer's recommended inflation pressure.

CAUTIONS:

- Allow one (1) hour cool-down period before recharging.
- It is highly recommended that this product be operated by two persons. ENSURE that someone is available to give assistance, if needed.
- Wear complete eye and clothing protection. Do not touch eyes while working near battery.
- ALWAYS keep the booster clamps in their storage holders to prevent sparking when recharging and when they are not in use.
- When using the 120 Volt AC or 12 Volt DC charger, pull on the plug and never pull on the cord when disconnecting.
- DO NOT recharge product battery with damaged chargers, replace them immediately.
- DO NOT attempt to remove or replace the battery used in this device. When battery has reached the end of its useful lifetime, take the entire unit to a battery recycling facility for proper disposal and /or battery replacement.
- Avoid dropping metal tools onto vehicle battery. It might spark or short circuit battery or other electrical part that may cause short circuits or explosion.
- For proper and safe operation of the Portable Power Source 12 Volt DC power socket DO NOT place anything into the socket except the plug of the 12 Volt DC accessory to be used.
- DO NOT place anything into the Portable Power Source charging port except the provided plug from the charger unit.
- Remove personal metal items such as rings, bracelets, necklaces and watches while working with a lead-acid battery. It can produce a short-circuit high enough to cause a severe burn.
- Never charge or jump-start a vehicle with a frozen battery.
- Never allow booster clamps to touch together or to contact the same piece of metal to prevent short circuits and arcing.
- Do not operate this device while wearing vinyl clothing. Static electricity sparks maybe generated when vinyl clothing is rubbed.
- This product is not intended for use in the rain or temperature above 130°F.
- Use only the provided chargers, cables and clamps. Unauthorized parts may damage the Portable Power Source.
- This product has no consumer serviceable parts, except the inverter replaceable fuse.
- This is not a toy. KEEP OUT OF REACH OF CHILDREN!
- Keep battery terminals clean. Be careful to keep corrosion from coming in contact with eyes.
- Save these instructions for future reference.

FEATURES:

A. BOOSTER CABLES POWER SWITCH:

Heavy Duty Rotary Switch turns power OFF to booster cables when not in use.
Power can be turned ON by turning the rotary switch in the clockwise direction.

B. POWER STATUS & CHARGE INDICATOR:

Red LED: Battery Charging
Green LED: Battery is fully charged.

C. HAND GENERATOR:

Manually charges battery in remote areas.

D. HAND GENERATOR CHARGE INDICATOR:

LED indicator illuminates when battery is being charged.

E. CONVENIENT CHARGE CORDS:

120 Volt AC charger for in home use & 12 Volt DC charger for on the road use.

F. 12 VOLT DC POWER OUTLET WITH OVERLOAD PROTECTION:

Provides power to most 12 Volt DC accessories equipped with a 12 Volt DC accessory plug. Portable Power Source circuit is protect with a 10 AMP auto-reset overload circuit breaker.

G. HEAVY-DUTY BOOSTER CLAMPS:

200 AMP RATED color-coded battery clamps.

H. PROFESSIONAL QUALITY CABLES:

Color coded cables with extra thick oil resistant external cable insulation sheathing.

I. BOOSTER CLAMPS STORAGE HOLDERS:

Prevents accidental sparking when cables are not in use.

J. REVERSE BATTERY POLARITY DETECTION CIRCUITRY:

Circuitry automatically activates if accidental reverse polarity clamp connection occurs, RED LED illuminates accompanied by high pitch alarm.

K. BUILT-IN POWERFUL 260 PSI COMPRESSOR:

Conveniently and rapidly inflates most inflatables.

a. Compressor Power Switch:

Compressor and power can be switched ON or OFF.

b. Air Pressure Gauge :

Accurate air pressure dial gauge with large and easy to read pressure increments in $\frac{\text{lb}}{\text{in}^2}$ (PSI) and $\frac{\text{kg}}{\text{cm}^2}$ Units.

c. Heavy Duty High Pressure Inflator Air Hose:

Professional high pressure rubber hose. Equipped with a universal air valve stem Quick - Connector Nozzle.

d. Nozzle Adaptors For Inflatables:

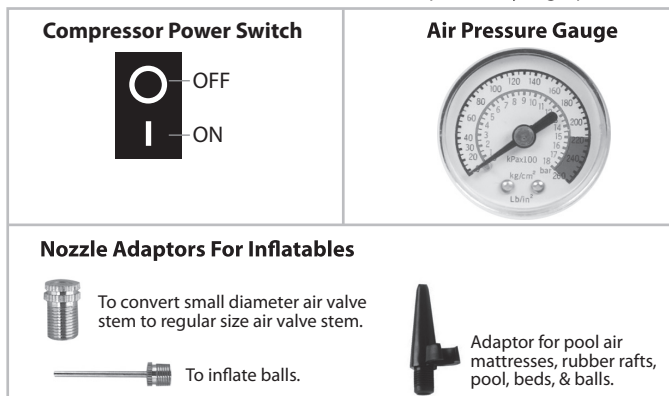

L. STANDARD 5 VOLT USB PORT:

For devices that require power from a standard USB port.(Switch Activated - Inverter & USB Port Power Switch - located on front panel).

M. 140 WATT POWER INVERTER:

Switch activated Power inverter provides portable power to 120 Volt AC devices.

N. LED Light:

Provides long lasting portable lighting with emergency flasher function.

COMPRESSOR INSTRUCTIONS:

⚠ WARNINGS:

- DO NOT operate the air - compressor around flammable materials or in an area where flammable fumes are present!
- Check item to be inflated for manufacturer's maximum recommended inflation pressure. DO NOT over inflate! Most tires are properly inflated between 24-35 PSI. Some truck & bicycle tires require 40 PSI or more.
- Always check the tire air inflation pressure with a separate air pressure gauge during and after inflating.
- DO NOT operate compressor more than 20 minutes continuously. Allow the compressor to cool down between each continuous operation.
- BURSTING HAZARD! DO NOT overinflate any inflatable article! DO NOT exceed the manufacturer's recommended inflation pressure!

A. TO INFLATE TIRES:

1. Remove the valve cap from the tire air valve stem.

NOTE: ENSURE that the air hose nozzle locking thumb lever is in the up position. If necessary, use valve stem adaptor.

2. Insert the compressor air hose nozzle onto the tire air valve stem, make sure that the nozzle is pushed onto the tire air valve stem as far as possible and is seated properly. Press down the locking thumb lever to engage as shown in the illustration.

3. Press the compressor power switch to the ON (I) position.

NOTE: In the event that the tire is completely flat, raise the vehicle using a recommended rated jack and jack stands before inflating the tire.

4. Monitor pressure on the compressor air pressure gauge.

NOTE: It is recommended to use a separate air gauge to check the actual tire inflation pressure.

5. Press the compressor power switch OFF (O) when the desired tire air pressure is reached.
6. Disconnect the air hose nozzle from the tire valve stem by lifting the locking thumb lever to the Up position. (Also, remove any air hose nozzle adapter, if any).
7. Recap the tire air valve stem.
8. Stow the air hose back into the Portable Power Source storage compartment.

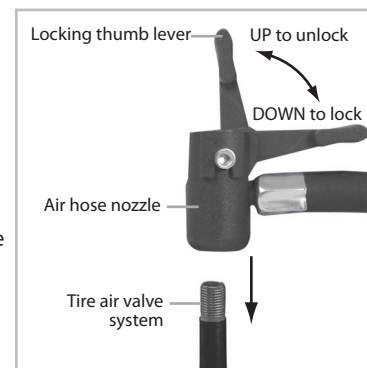

B. TO INFLATE PLASTIC INFLATABLES (BALLS, AIR MATTRESSES, RUBBER RAFTS, ETC.)

⚠ CAUTION:

Check manufacturer's specification on item to be inflated for correct inflation pressure. DO NOT over inflate!

1. Remove the valve cap from the inflatable valve stem.
2. Connect the compressor air hose nozzle onto or into the inflatable valve stem and turn the locking thumb lever to the down position.
NOTE: Connect the appropriate valve stem adapter(s) onto the air hose nozzle (if needed.)
3. ENSURE that the air hose nozzle and the valve stem adapter (if used) are properly seated onto/into the inflatable valve stem.
NOTE: Insert the air hose nozzle with the valve stem adapter (if needed) into or onto the inflatable air valve stem as far as practical.
4. Press the compressor power switch to the ON (I) position.
5. Monitor the pressure on the compressor air pressure gauge. When the desired pressure is reached, Press the compressor power switch to the OFF (O) position. Unlock the air hose nozzle thumb lever to the UP position.
6. Recap the inflatable air valve stem.
7. Stow the air hose back into the Power Portable Source storage compartment.

CHARGING & RECHARGING INSTRUCTIONS

⚠️WARNING:

Do not overcharge this unit. Prior to Charging unit, read and understand all instructions listed below. Overcharging may result in damage to the unit.

⚠️CAUTIONS:

- ENSURE that the unit power switches are in the OFF positions.
- Recharge the Portable Power Source in a clear, unobstructed open area.
- DO NOT recharge the Portable Power Source near flammable materials or any location which accumulate flammable fumes.
- DO NOT smoke, use matches, lighters or open flame near the Portable Power Source when / during recharging.
- This product may arrive partially charged from the manufacturer. It is recommended to fully charge the unit immediately after purchase and before using for the first time.
- Fully recharge the Portable Power Source, when Red LED is illuminating.
- The charging LED indicator will be illuminated while charging. When charging is complete the RED LED will illuminate GREEN. This light will not go out until the charging plug is removed.
- Do not charge the Portable Power Source for more than 48 hours continuously.
- Make sure that any electrical outlet, located in a potentially wet or moist area, and is to be used to charge the Portable Power Source, is protected by a Ground Fault Interrupt switch.
- Do not charge the Portable Power Source on boat, boat ramp or docks since the electrical cords and outlets used for charging could cause severe electrical shock if they get wet.
- It is recommended that the Portable Power Source is in an upright position while charging.

IMPORTANT: THE 120 VOLT AC POWER UNIT (CHARGER) IS INTENDED TO BE CORRECTLY ORIENTED IN A VERTICAL OR FLOOR MOUNT POSITION DURING CONNECTION TO A 120 VOLT AC RECEPTACLE.

NOTE: ENSURE BOTH BOOSTER CLAMPS (POSITIVE & NEGATIVE) ARE PLACED IN THEIR STORAGE HOLDERS WHEN NOT IN USE AND DURING THE PORTABLE POWER SOURCE RECHARGING.

A.CHARGING WITH 120 VOLT AC CHARGER:

1. Insert the 120 Volt AC charger plug into the Portable Power Source recharging port.
2. Insert the 120 Volt AC charger transformer plug into a 120 Volt AC receptacle.
3. Fully charge the unit according to the following:
 - **Initial & first time charge: 24 hours continuously.**
 - **Recharge or between each use: 15 hours continuously.**
4. When charging is complete unplug the 120 Volt AC charger transformer plug first and then the 120 Volt AC charger plug from the recharging port on the Portable Power Source.

B.RECHARGING WITH 12 VOLT DC CHARGER:

1. Insert the 12 Volt DC charger plug into the Portable Power Source recharging port.
2. Insert the 12 Volt DC charger accessory plug into the vehicle Cigarette Lighter or 12 Volt DC Accessory socket.
3. Fully charge the unit for 8 hours continuously, while vehicle engine is running.
4. When charging is complete unplug the 12 Volt DC charger accessory plug first and then the 12 Volt DC charger plug from the recharging port on the Portable Power Source.

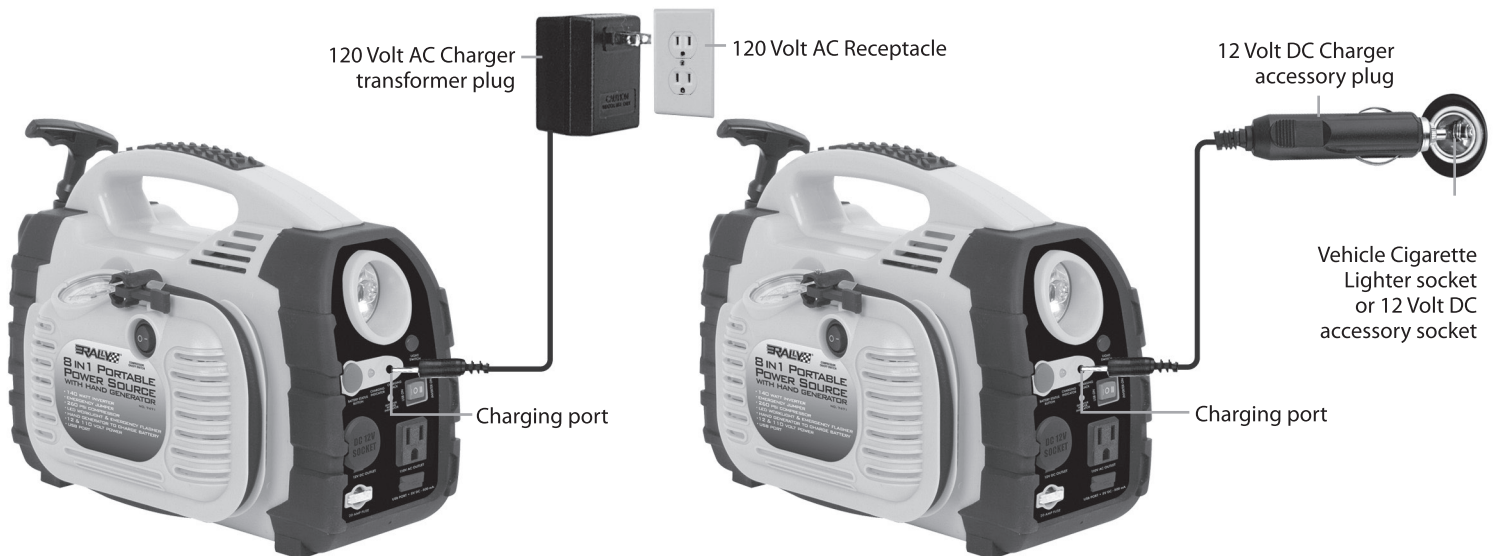

Charging With 120 Volt AC Charger

Charging With 12 Volt DC Charger

USB POWERED DEVICES:

1. Prior to connecting the device to the USB port of this unit, make sure the device is OFF.
2. Using the interface cable included with the device to be powered or charged, connect the device to the USB port on the Portable Power Source.
3. Press the USB Port power switch to the ON (I) position. (The device with built-in battery will start charging automatically). Turn ON the device and use as normal.

JUMP STARTING (BATTERY BOOST) INSTRUCTIONS:

WARNING:

Vehicles equipped with on-board computer(s) may be damaged if vehicle is jump-started. Read your vehicle owner's manual before attempting to start the vehicle to determine if external-starting / battery boosting assistance can be used. Failure to follow these instructions may cause damage or explosion. Use safety glasses to protect eyes while jump-starting (battery boost) a vehicle. ONLY Jump Start / boost charge a vehicle in a clear unobstructed, open area.

CAUTION:

ENSURE that the Portable Power Source booster switch is in the OFF position. Place this unit on a flat and stable surface near the vehicle battery that is clear of all moving parts (fan blades, belts, and pulleys). DO NOT smoke, use matches, lighters or open flame while attempting to jump-start (battery boost) a vehicle. Use extreme caution DO NOT touch battery clamps together.

1. Turn OFF the vehicle ignition and all accessories (e.g., Radios, Lights, Air Conditioner and Cellular Phones).
2. Set the emergency brake and put vehicle with automatic transmission in the PARK position.
3. Determine the polarity of the vehicle battery terminals. The Positive (POS,P,+) battery terminal usually is larger in diameter than the Negative (NEG, N, -) terminal. (If you are unsure you should refer to vehicle owner's manual).
4. Determine whether your vehicle uses a Negative or Positive Grounded System:
Negative Grounded system: *Negative battery terminal is grounded to chassis. Most vehicles use this system.*
Positive Grounded system: *Positive battery terminal is grounded to chassis or any other metallic part of the vehicle (If you are unsure you should refer to the vehicle owner's manual).*
5. Access the Portable Power Source booster clamps by squeezing the clamp handles. Pull the clamps outward and remove clamps from their storage holders. NEVER allow clamps to touch together or to contact the same piece of metal to prevent short circuits and arcing.
6. Follow instructions for Negative Grounded system or Positive Grounded system as indicated below:
Negative Grounded system:
 - a. Securely connect the Positive (+) Red clamp to the Positive (POS, P, +) terminal of the vehicle battery or the remote Positive (+) terminal if equipped.
 - b. Securely connect the Negative (-) Black clamp to the vehicle chassis, engine block or a non-moving grounded metal part of the vehicle as far away from the battery as possible. Do not clamp directly to carburetor, fuel lines, or non grounded Sheet-metal body parts.
 - c. Portable Power Source Green LED is ON/Lit. (Proper battery polarity Connection.) WARNING: IF RED LED is ON/Lit and alarm sounds (reverse battery polarity connection) STOP! CAREFULLY DISCONNECT the Portable Power Source booster clamps! Reconnect the Portable Power Source booster clamps to the proper battery polarity (Red booster clamp to the positive terminal of the battery and the Black booster clamp to vehicle ground.)
 - d. See Jump Starting (Battery Boost) procedure #7 (below) to continue.**Positive Grounded system:**
 - a. Securely connect the Negative (-) Black clamp to the Negative (NEG, N, -) ungrounded terminal of the vehicle battery.
 - b. Securely connect the Positive (+) Red clamp to the vehicle chassis, engine block or a non-moving grounded metal part of the vehicle as far away from the battery as possible. Do not clamp directly to carburetor, fuel lines, or Sheet-metal body parts.
 - c. Portable Power Source Green LED is ON/Lit. (Proper battery polarity Connection.) WARNING: IF RED LED is ON/Lit and alarm sounds (reverse battery polarity connection) STOP! CAREFULLY DISCONNECT the Portable Power Source booster clamps! Reconnect the Portable Power Source booster clamps to the proper battery polarity (Black booster clamp to the negative terminal of the battery and the Red booster clamp to vehicle ground.)
 - d. See Jump Starting (Battery Boost) procedure #7 (below) to continue.
7. Turn the Portable Power Source booster switch clockwise to turn ON power to the booster clamps.
8. Allow 2 or 3 minutes charging time. It is recommended to have a second person to assist holding the Portable Power Source unit securely in place during the next steps.
9. Turn the ignition key and attempt to start the vehicle. Note: If the vehicle does not start after 4 to 5 seconds of engine cranking...stop...wait 3 to 4 minutes, then try again. Repeat several times until the vehicle starts.

CAUTION:

Excessive engine cranking can damage vehicle starter motor. If the engine turns, but fails to start after several attempts, other technical problem(s) might be involved. Discontinue cranking the engine until the other problem is determined and corrected.

10. If the vehicle starts, turn the of Portable Power Source booster switch counter clockwise to the OFF position.
11. Disconnect clamps in reverse sequence to connecting procedure above as far away from the vehicle battery as practical:
For Negative Grounded System first disconnect Negative (Black) then Positive (Red) clamps.
For Positive Grounded System first disconnect Positive (Red) then Negative (Black) clamps.
12. Replace the clamps to their storage holders.

LED LIGHT & EMERGENCY FLASHER INSTRUCTIONS:

1. To power ON the LED Light, press the push-button switch once and release.
2. To power OFF the LED Light, press the push-button switch once more and release
3. To power ON the LED Light Emergency Flasher, press the push-button switch once and release.
4. To power OFF the LED Light Emergency Flasher, press the push-button switch once more and release.

NOTE: LED light or emergency flasher functions will operate in sequence to each other. The lighting mode will depend on the prior (last) operating function selected. User may have to cycle between modes inorder to achieve the proper lighting function.

POWER INVERTER INSTRUCTIONS:

CAUTION:

ONLY OPERATE THE 120 VOLT AC DEVICE AND INVERTER IN A CLEAR DRY AREA. DO NOT OPERATE IN THE RAIN OR WET LOCATIONS!

IMPORTANT: Prior to operating, make sure the 120 Volt AC device and the inverter power switches are in the OFF positions.

1. Place the unit in a dry open flat area with overhead cover.
2. Connect the 120 Volt AC device to the inverter receptacle.
3. Press the inverter power switch to the ON (I) position.
4. Power ON and operate the 120 Volt AC device.
5. To power OFF the 120 Volt AC device, first power OFF the device than press the inverter power switch to the OFF (0) position.

HAND GENERATOR INSTRUCTIONS:

IMPORTANT: Prior to charging the Portable Power Source battery using the hand generator, make sure that the unit power switches are in the OFF positions.

1. Place the unit in a dry open flat area with overhead cover.
2. Using either hand, securely grasp the Portable Power Source carrying handle.
3. With the free hand, securely grasp the Hand Generator Pull Handle.
4. To generate battery crank charging, firmly pull-up on the Hand Generator Pull Handle while holding down the Portable Power Source.
- NOTE: DO NOT exceed the hand generator pull handle maximum cord length of 30 inches.**
5. Allow the Hand Generator Pull Handle cord to retract back into the Portable Power Source housing, thereby completing one (1) generator crank cycle.
6. Continue Hand Generator cranking cycles for a minimum period of 3 minutes.
7. The Portable Power Source internal battery will achieve a charging level adequate enough for one (1) vehicle battery boost charge.

NOTE: the Portable Power Source battery charge level will vary pending the unit battery status at time of crank charge. User may have to continue hand generator crank cycles until the Portable Power Source internal battery reaches the charge level adequate for jump starting (battery boosting) a vehicle.

120 VOLT AC ACCESSORIES POWERED BY THE PORTABLE POWER SOURCE 140 WATT INVERTER

ACCESSORY	WATTAGE CONSUMPTION	ESTIMATED CONTINUOUS OPERATION AT FULL BATTERY CHARGE
CORDLESS DRILL CHARGER 7 VOLT	15 WATT	6 HOURS & 24 MIN.
GLUE GUN	20 WATT	4 HOURS & 48 MIN.
CAMCORDER CHARGER 6 VOLT	25 WATT	3 HOURS & 48 MIN.
CELLULAR PHONE CHARGER	30 WATT	3 HOURS & 12 MIN.
VCR	45 WATT	2 HOURS & 6 MIN.
CD CHARGER	65 WATT	1 HOUR & 24 MIN.
13" COLOR TV	70 WATT	1 HOUR & 18 MIN.
LAPTOP COMPUTER	90 WATT	1 HOUR & 6 MIN.
WORK LIGHT	100 WATT	57 MIN.
1/4 HP POWER BUFFER	110 WATT	52 MIN.
20" COLOR TV/VCR	120 WATT	48 MIN.
SOLDERING GUN	135 WATT	42 MIN.

THIS LISTING IS FOR REFERENCE PURPOSES ONLY. SOME ACCESSORIES EXCEED THE WATTAGES LISTED. BEFORE USING ACCESSORIES REFER TO DEVICE OWNER'S MANUAL FOR ACTUAL WATTAGE REQUIRED.

12 VOLT DC ACCESSORIES POWERED BY PORTABLE POWER SOURCE

ACCESSORY	WATTAGE CONSUMPTION	ESTIMATED CONTINUOUS OPERATION AT FULL BATTERY CHARGE
UTILITY LIGHTS	2 WATT	48 HOURS
CELLULAR PHONES	4 WATT	24 HOURS
RADIOS	9 WATT	10 HOURS & 42 MIN.
FANS	15-25 WATT	6.4 HOURS - 3.8 HOURS
SPOT LIGHT	55 WATT	1 HOUR & 42 MIN.
CAR VACUUMS	84 WATT	1 HOUR & 6 MIN.
AIR COMPRESSOR	90 WATT	1 HOUR & 3 MIN.
FLOOD LIGHTS	100 WATT	57 MIN.

NOTE:

- Estimated working time is based on the Portable Power Source at full charge.



TROUBLE SHOOTING GUIDE

TROUBLE	CAUSE	SOLUTION
Vehicle does not start	<ol style="list-style-type: none"> 1. Portable Power Source booster switch in the OFF position. 2. BAD clamp connection! Portable Power Source Red LED ON/Lit and Alarm is activated. 3. Very low vehicle battery charge. 4. Low Portable Power Source charge. 5. Vehicle battery defective. 	<ol style="list-style-type: none"> 1. ⚠️WARNING! Portable Power Source Green LED must be ON/Lit! Turn the Portable Power Source booster switch clockwise to the ON position to allow power to the booster cables. 2. STOP! DO NOT turn the Portable Power Source booster switch to the ON position! CAREFULLY disconnect and reconnect the Portable Power Source booster clamps to the proper battery polarity. 3. Maintain Portable Power Source connected to the vehicle depleted battery. Wait 3 to 4 minutes before attempting to start vehicle again. 4. Recharge the Portable Power Source to full charge. 5. Replace with new battery.
12 Volt DC accessory connected to the Portable Power Source 12 Volt DC Socket does not operate	<ol style="list-style-type: none"> 1. No output power at the Portable Power Source 12 Volt DC Socket. 2. Bad connection to the Portable Power Source 12 Volt DC Socket. 3. Low Portable Power Source charge. 4. 12 Volt DC accessory fuse blown. 	<ol style="list-style-type: none"> 1. Internal circuit breaker is OFF. Turn OFF the 12 Volt DC accessory. Remove the accessory 12 Volt DC plug from the Portable Power Source 12 Volt DC socket. Wait 10 -25 minutes for automatic reset to regain power. 2. Insert the accessory 12 Volt DC plug properly into the Portable Power Source 12 Volt DC Socket. 3. Recharge the Portable Power Source to Full charge. 4. Replace fuse.
120 Volt AC appliance does not operate with the Portable Power Source Power Inverter.	<ol style="list-style-type: none"> 1. Bad connection with the 120 Volt AC appliance. 2. Inadequate power or excessive power voltage drop. 3. Inverter malfunction. 4. Low Portable Power Source charge. 	<ol style="list-style-type: none"> 1. Check connection of the 120 Volt AC appliance to the inverter 120 Volt power outlet. 2. Check for proper power inverter wattage range for given 120 VAC appliance. 3. Check inverter for power output also check inverter fuse. <i>To change Inverter fuse: Locate it on unit front panel. Using a needle nose pliers or fuse puller, remove the blown fuse and replace with a 20 AMP blade fuse.</i> 4. Recharge Portable Power Source to full charge.
Compressor does not start.	<ol style="list-style-type: none"> 1. Very weak or low Portable Power Source charge. 	<ol style="list-style-type: none"> 1. Recharge Portable Power Source to full charge.
Compressor does not inflate.	<ol style="list-style-type: none"> 1. Hose nozzle is not properly connected onto the air valve stem. 2. Compressor air hose leakage. 3. Check object to be inflated for puncture(s). 4. Compressor overheated and shutdown. 	<ol style="list-style-type: none"> 1. Ensure that the hose nozzle is properly seated and that the locking thumb lever is in the down position. 2. Repair air hose if possible. 3. Repair puncture(s) if possible. 4. Allow 10 to 25 minutes compressor cool down period.

SPECIFICATIONS:

- 1. BUILT IN BATTERY8 AMP HOUR (AH) SEALED LEAD ACID, MAINTENANCE FREE, SPILL-PROOF, RECHARGEABLE
- 2. DC SOCKET.....12 VOLT DC / 10 AMP
- 3. USB PORT.....5 VOLT DC / 500 mA
- 4. LED LIGHT.....12 VOLT DC/100mA
- 5. POWER INVERTER140 WATT
- 6. AIR COMPRESSOR.....260 PSI
- 7. CIRCUIT BREAKER.....10 AMP INTERNAL, WITH AUTOMATIC RESET.
- 8. NET WEIGHT.....10.6 lb
- 9. UNIT DIMENSIONS.....8.8 in. (H) x 6.7 in. (W) x 11.5 in. (D)
- 10. STORAGE TEMPERATURE.....STORE IN COOL DRY WELL VENTILATED AREA WITH OVERHEAD COVER

STORAGE:

This unit may be stored in any position. ENSURE that the booster clamps are secured to their storage holders.

⚠ CAUTION:

The Portable Power Source switches must be in the OFF positions. Store at room temperature. If not used for prolonged time Recharge every 2 months in the winter & monthly in summer.

TWO YEAR LIMITED WARRANTY:

Rally Manufacturing is dedicated to making high quality products for every consumer. We are so confident in the quality of our merchandise that we offer a two year limited warranty with this product except the rechargeable battery which is warranted for one year. That means should you find any defects with the item you purchased, we will repair it or replace it. Please mail all defective products to Rally Manufacturing 7600 Corporate Center Drive, Suite 400 Miami, FL 33126. Attn: Customer Service.

REPAIR OR REPLACEMENT OF THE DEFECTIVE PRODUCT OR COMPONENT PROVIDED UNDER THIS WARRANTY SHALL NOT APPLY IF THE PRODUCT: (a) IS USED FOR COMMERCIAL PURPOSES AND/OR FROM IMPROPER USE IN AN UNSUITABLE ENVIRONMENT (b) IS MODIFIED OR TAMPERED WITH EITHER INTERNALLY OR EXTERNALLY; (c) IS DAMAGED RESULTING FROM MISUSE, NEGLIGENCE, LACK OF REASONABLE MAINTENANCE AND CARE, OR BY OTHER CAUSES UNRELATED TO DEFECTIVE MATERIAL OR WORKMANSHIP; (d) IF THE PRODUCT HAS BEEN SUBJECTED TO FIRE, WATER, OR GENERAL CORROSION.

This warranty gives you specific legal rights, and you may also have other rights which vary from State to State in the U.S.A. or province to province in Canada.

WARNING: This product may contain chemicals known to the state of California to cause cancer, birth defects, or other reproductive harm. Wash hands after handling!



© 2012 RALLY, INC.

CUSTOMER SERVICE

Monday-Friday 8:30am-5:30pm Eastern Standard Time
For Questions or comments contact us at:
www.rallymfg.com or call 1-800-965-4407