

# SHARPER IMAGE®

## PORTABLE EVAPORATIVE COOLER

Item No. 206051

Owner's Manual

Thank you for choosing the Portable Evaporative Cooler by Sharper Image. Please read this manual carefully before you use the product and store it for future reference.

### PARTS IDENTIFICATION

1. Misting Outlet
2. Front Rotary
3. Control Panel
4. Front Panel
5. Water Level Indicator
6. Base
7. Handle
8. Back Rotary
9. Back Panel
10. Detachable Water Tank
11. Drain
12. Wheels



### HOW TO USE

1. Before using, make sure the unit is placed on a stable surface. Use the same power supply and voltage as mentioned on the rating label on the back side of the product. Once the product is plugged in, the buzzer will beep once then the LED display will illuminate a few seconds later. The unit will enter standby mode once the power indicator lights up.
2. **Switch on:** When the unit is stationary, press the "On/Off" button, the buzzer will beep once. Choose your preferred fan speed by pressing the "speed" button on the control panel or on the remote control.
3. **Wind speed adjustment:** Choose from Low, Medium and High.
4. **Swing mode adjustment:** Press the "Swing" button on the control panel or remote control, The Front Rotary will turn to circulate the air. Press the "Swing" button again to turn it off.
5. **Oscillation mode adjustment:** Press the "Oscillation" button on the control panel or remote control. The fan will sweep side to side to circulate the air. Press the "Oscillation" button again to turn it off.

## HOW TO USE [CONT'D]

6. **Economic mode:** To activate its energy saving mode, press the economic mode button. This mode will power off additional lights to preserve energy while in use. The logo displayed on the panel will be off when economic mode is activated.
7. **Humidifier/ Misting function:** Press the "Mist" button on the control panel or on remote control. The display screen will show the humidification pattern. The green light indicates normal humidifier function and the red light indicates when the water tank needs to be refilled. Press the button again to turn off the mist function.
8. **Timer function:** Press the "Timer" button on the control panel or remote control to set the time. Each time you press the timer button the display screen will show the input time you set. The timer can be set 0.5 hour to 9.5 hours with intervals of 30 minutes each. (0.5, 1, 1.5 hours up to 9.5 hours). Press the "Timer" button once again to turn off the timer function.
9. **Remote control function:** The remote controller operates the MIST, OSCILLATION, SWING, ECONOMIC, TIMER, SPEED and ON/OFF functions of the unit. It works with 2 X AAA batteries (not included).

## OPERATION METHODS FOR WATER TANK

1. Detach the water tank at a 45° angle.
2. Unscrew the tank cover and fill the tank with water.
3. Place the water tank back into the unit at a 45 °angle.
4. You will hear a "click" sound when positioned and secure.

*NOTE: Please make sure the water tank and unit are fastened to avoid any damage while transporting.*

5. The water level indicator will illuminate when the mist function is activated. When the tank is full, the light will be GREEN. When the tank is empty the light will be RED.

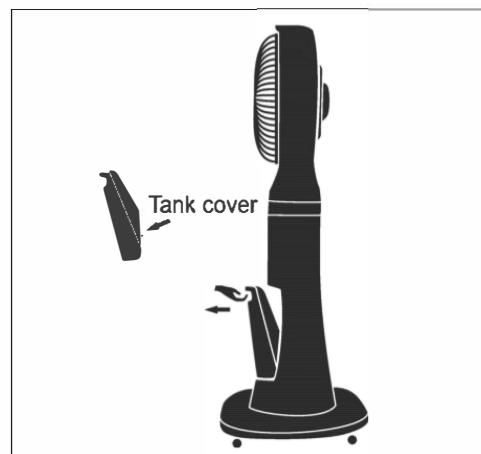

## CAUTIONS

1. Unplug the unit before refilling with water and cleaning.
2. This unit is not intended for use by children.
3. If the supply cord is damaged contact Sharper Image Customer Service.

## MAINTENANCE AND CLEANING

1. Turn the unit off and unplug before cleaning.
2. Do not immerse the plug or unit into any liquid.
3. Use a wet towel soaked with water and mild detergent to clean the body of the unit.  
Do not scratch the unit during cleaning.
4. Optional: add a few drops of mild citric acid and water into the water tank for 5-10 minutes to remove any dirt in the water tank.
5. If the unit will not be used for a long period of time, empty the water tank and let it dry before storing.

## TROUBLESHOOTING

Problem	Possible cause	Solution
The unit does not turn on.	1. The unit is incorrectly plugged in. 2. Incorrectly pressing the on/off button.	1. Properly plug the unit in. 2. Press the on/off button.
The unit will not swing.	1. Incorrectly pressing the Swing button.	1. Find the right switch and press the Swing button.
Abnormal Noise	1. Debris inside. 2. Fan blades loose.	1-2. Turn the fan off and contact Sharper Image customer service.
No mist	1. Water tank is empty.	1. Fill water tank
Mist volume is insufficient	1. Water is dirty.	1. Replace with clean water.

## PRODUCT SPECIFICATION

Item No	206051
Voltage/frequency	120V-60HZ
Water tank capacity	1.6L
Rated Power	90W
Body Weight	6.0KG

## **WARRANTY / CUSTOMER SERVICE**

This item from SharperImage.com includes a 1-year limited replacement warranty. If you have any questions not covered in this guide, please call our Customer Service department at 1 (877) 210-3449. Customer Service agents are available Monday through Friday, 9:00 a.m. to 6:00 p.m. ET.

# **SHARPER IMAGE®**

The SHARPER IMAGE® name and logo are registered trademarks.  
©Sharper Image. All Rights Reserved.

# Assembly Manual

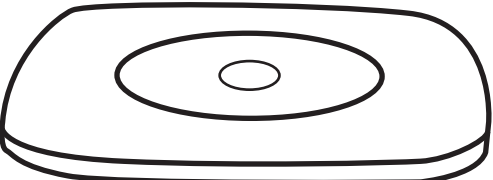
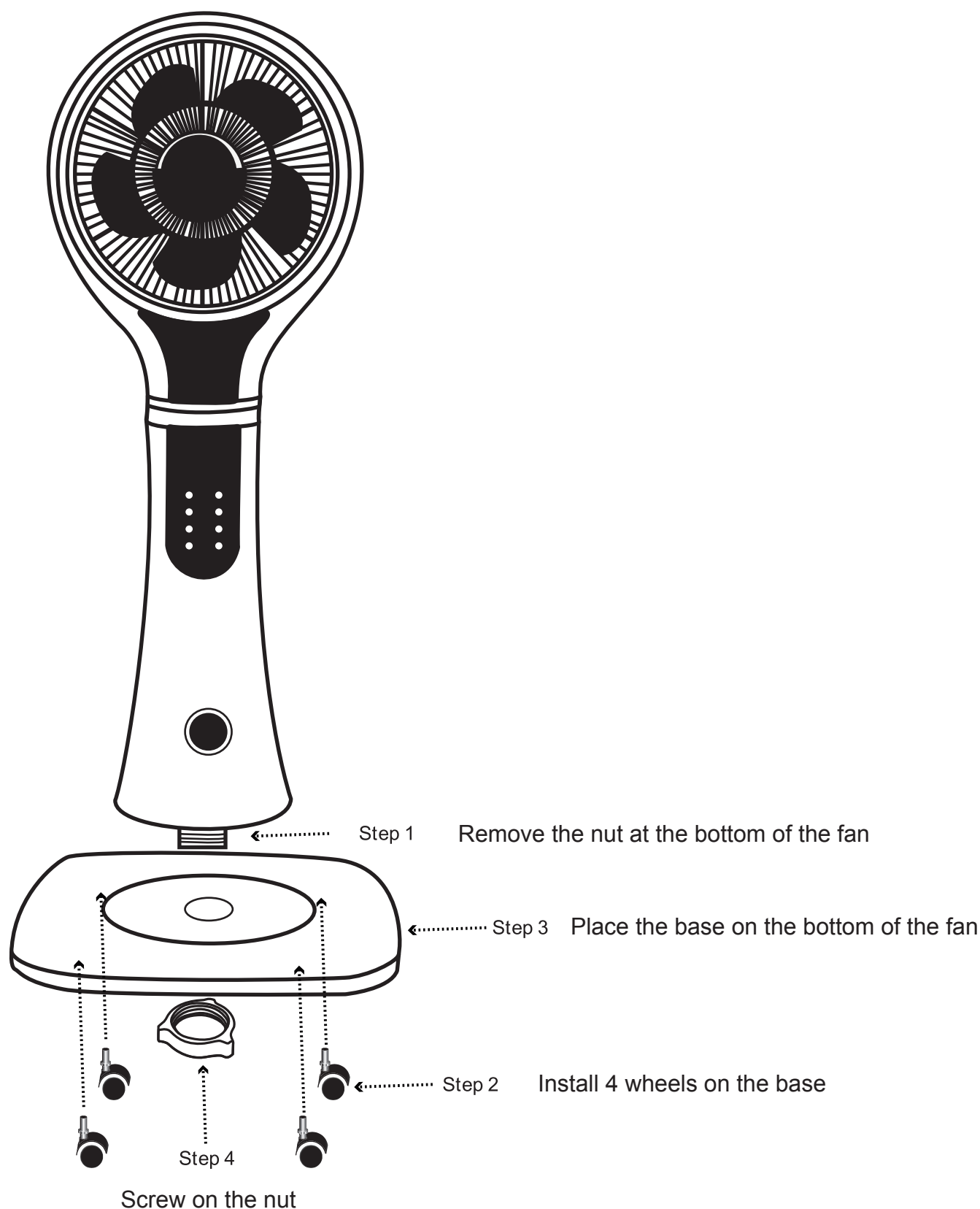

Base

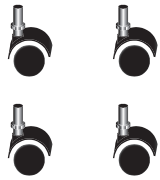

Wheel



Nut