

SHARPER IMAGE®

WARMING BACKREST MASSAGER

Item No. 205948

User Guide



Thank you for purchasing the Sharper Image Warming Backrest Massager. Please take a moment to read this guide and store it for future reference.

DESCRIPTION OF PARTS

- A. Backrest
- B. Foldable Armrests
- C. Control Panel
- D. AC Adapter
- E. Adjustable LED Reading Light
- F. Side Pockets

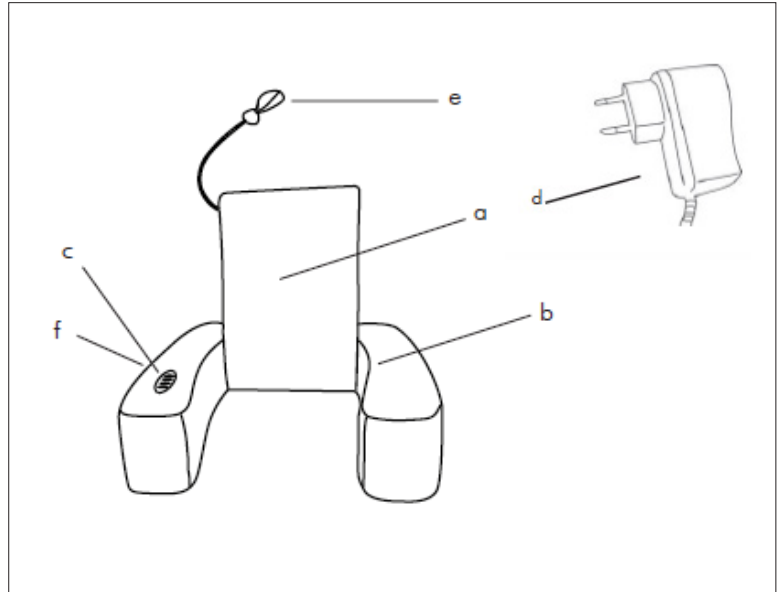

CONTROL PANEL

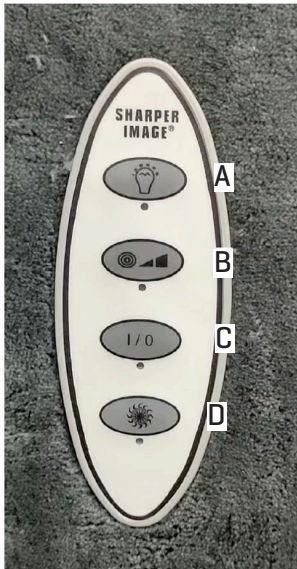

Use the built-in Control Panel [inset] to access the features of this device.

A. Reading Light On / Off

B. Massage Intensity
Low = Green
High = Blue

C. Massage On / Off

D. Heat On / Off

NOTE: The massage, light and heat features can be used together or independently. Do not leave this device unattended when not in use.

CARE AND MAINTENANCE

- Before cleaning this device, be sure to unplug it from the AC outlet.
- Spot clean only.
- Do not expose this device to water or moisture.
- If necessary, clean the control panel with a soft, dry cloth.
- Do not use abrasive detergents or products that may damage this device.

SAFETY WARNINGS

- Read and follow all safety warnings.
- For indoor use only.
- This device is not a toy. Keep out of reach of children at all times.
- Do not use this device if the cushions, power cord or AC adapter appear damaged or frayed. Contact Sharper Image Customer Service immediately.
- Use only the AC adapter that came with this device.
- Do not push the function buttons with sharp or pointy objects.
- Do not use this device in a moist or humid environment, such as a shower or swimming area.
- Do not expose this device to excessive heat or flames.
- Do not fall asleep on this device while it is operating.
- To prevent overheating, do not cover this device with pillows or blankets.
- Do not use the heat function for more than 20 minutes.
- Switch off the device immediately if you feel excessive heat or a burning sensation in your back.
- Do not leave this device unattended when not in use.
- Always unplug this device when not in use.
- Consult with a physician before using any massaging device designed for home use.

SPECIFICATIONS

Backrest	DC 12V / 0.8 A
Adapter Input	100-240V ~50 /60 Hz 0.6A Max
Adapter Output	DC 12V / 0.8 A
Upholstery	100% Polyester
Foam	100% Polyurethane

WARRANTY / CUSTOMER SERVICE

Sharper Image branded items purchased from SharperImage.com include a 1-year limited replacement warranty. If you have any questions not covered in this guide, please call our Customer Service department at 1 (877) 210-3449. Customer Service agents are available Monday through Friday, 9:00 a.m. to 6:00 p.m. ET.

SHARPER IMAGE®

The SHARPER IMAGE® name and logo are registered trademarks.

©Sharper Image. All Rights Reserved.