

PRIME

DART BLASTER

MOTORIZED RAPIDFIRE

INSTRUCTION MANUAL

DART BLASTER OVERVIEW:

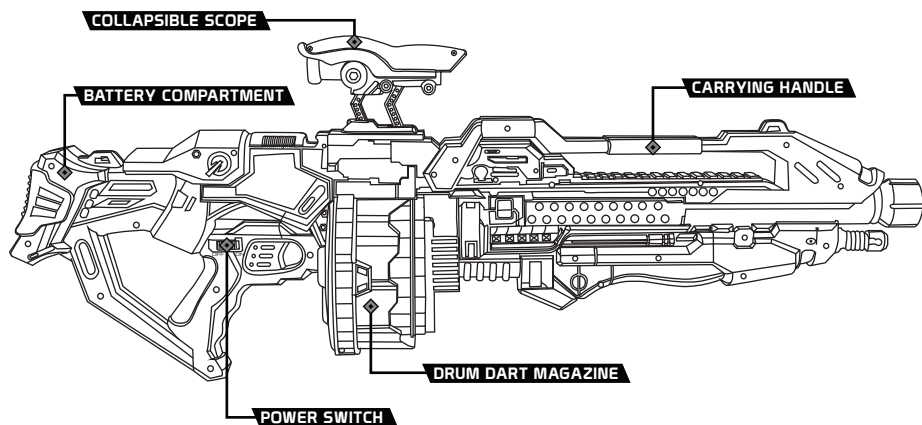

WORLD
TECH
WARRIOR

BC

8+

ITEM NO. 33800

LOADING DART BLASTER

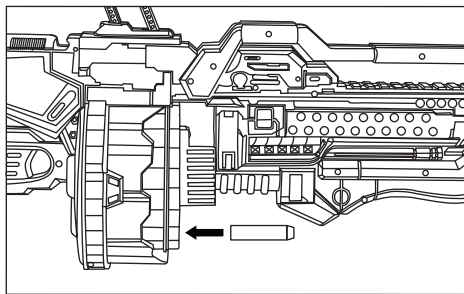

Load darts into the drum magazine.

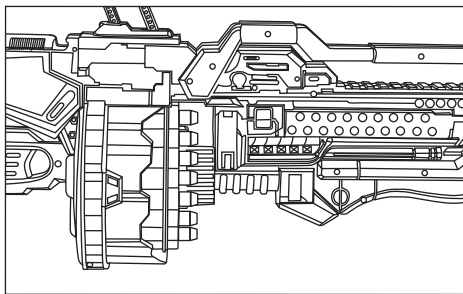

Make sure to completely push darts into tubes.

OPERATING DART BLASTER

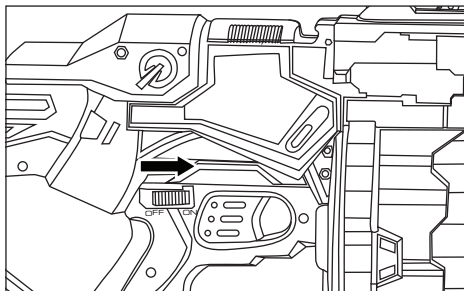

Switch power button to ON position.

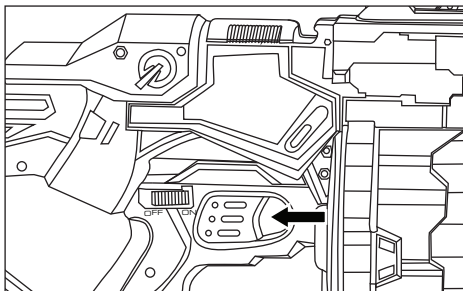

Squeeze trigger to fire a single dart, each trigger pull will fire another dart.

ADJUSTING TACTICAL SCOPE

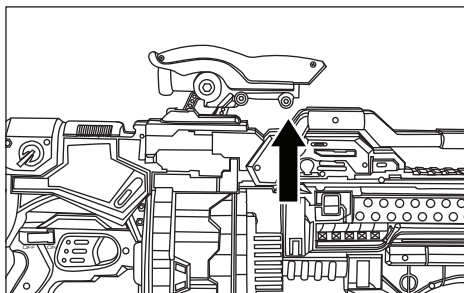

Pull scope up to the desired height.

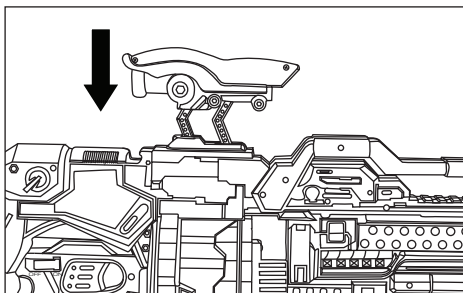

Push down scope to the desired height.

CHARGING BATTERY

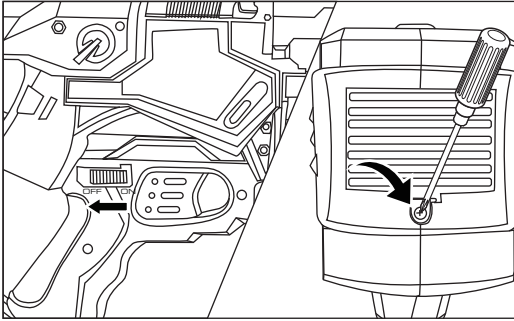

1. Switch off the blaster and remove the screw on the battery cover. Remove the cover completely.

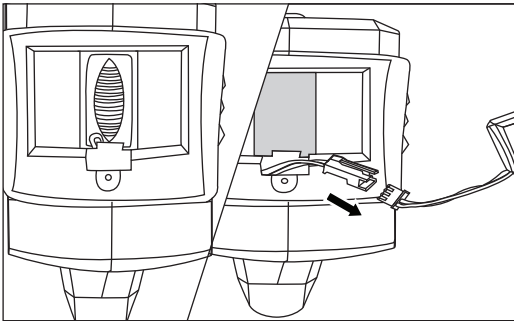

2. Remove the battery from the battery bay and disconnect the battery cable from the blaster's power port.

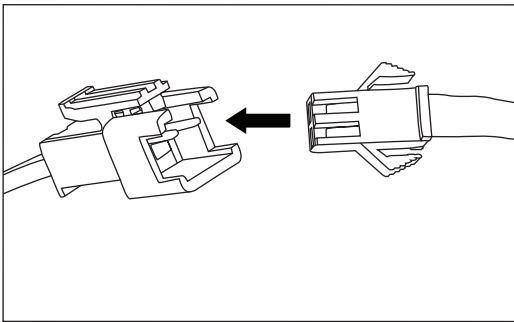

3. Plug the supplied USB charger into a powered USB port. Connect the battery cable to the USB charger for approximately 60-120 minutes. Disconnect once charged, do not leave charging overnight.

BATTERY PACK SPECIFICATIONS

Battery Type	Battery Specification	Charge Time
Ni-Cd Battery	4.8v AA700mAh	60 - 120 Minutes

CAUTION WHILE CHARGING:

Do not charge with batteries still installed. Do not charge battery unsupervised. Do not immediately charge after use. Do not overcharge battery. Ideal charge time is 60 - 120 minutes. Overcharging can cause a catastrophic failure. Always charge on dry and ventilated areas away from any heat source or flammable materials. Always use the original charger provided. Promptly change and replace old or defective batteries.

TROUBLESHOOTING DART BLASTER

PROBLEM	CAUSE	SOLUTION
Blaster does not turn on/respond.	Blaster battery pack is drained.	Recharge blaster battery pack.
Blaster does not fire.	Blaster is not powered ON.	Turn power switch to ON position.
	Blaster battery pack is drained.	Recharge blaster battery pack.
	Blaster has dart obstruction.	Turn off and check dart chamber and remove any obstructions.
Blaster trigger not working.	Power is OFF.	Turn power switch to ON position.
	Blaster battery pack is drained.	Recharge blaster battery pack.
Darts are firing inconsistently.	Darts are damaged.	Replace the damaged darts.
	Blaster battery pack is drained.	Recharge blaster battery pack.
	Blaster has dart obstruction.	Turn off and check dart chamber and remove any obstructions.

SPECIFICATIONS,
COLORS AND CONTENT
MAY VARY FROM ILLUSTRATIONS

MADE IN CHINA

Website: www.worldtechtoys.com
Email: customerserv@worldtechtoys.com
Phone: (877) 498-8697
Monday - Friday / 9:00AM - 5:00PM / Pacific Time



WWW.WORLDTECTOYS.COM



WARNING:

CHOKING HAZARD—Small parts.
Not for children under 3 years.



CAUTION:

To avoid injuries, do not aim at eyes, face or animals. Do not modify blaster or darts.